

LAKE COUNTY
LAK-1-12.89

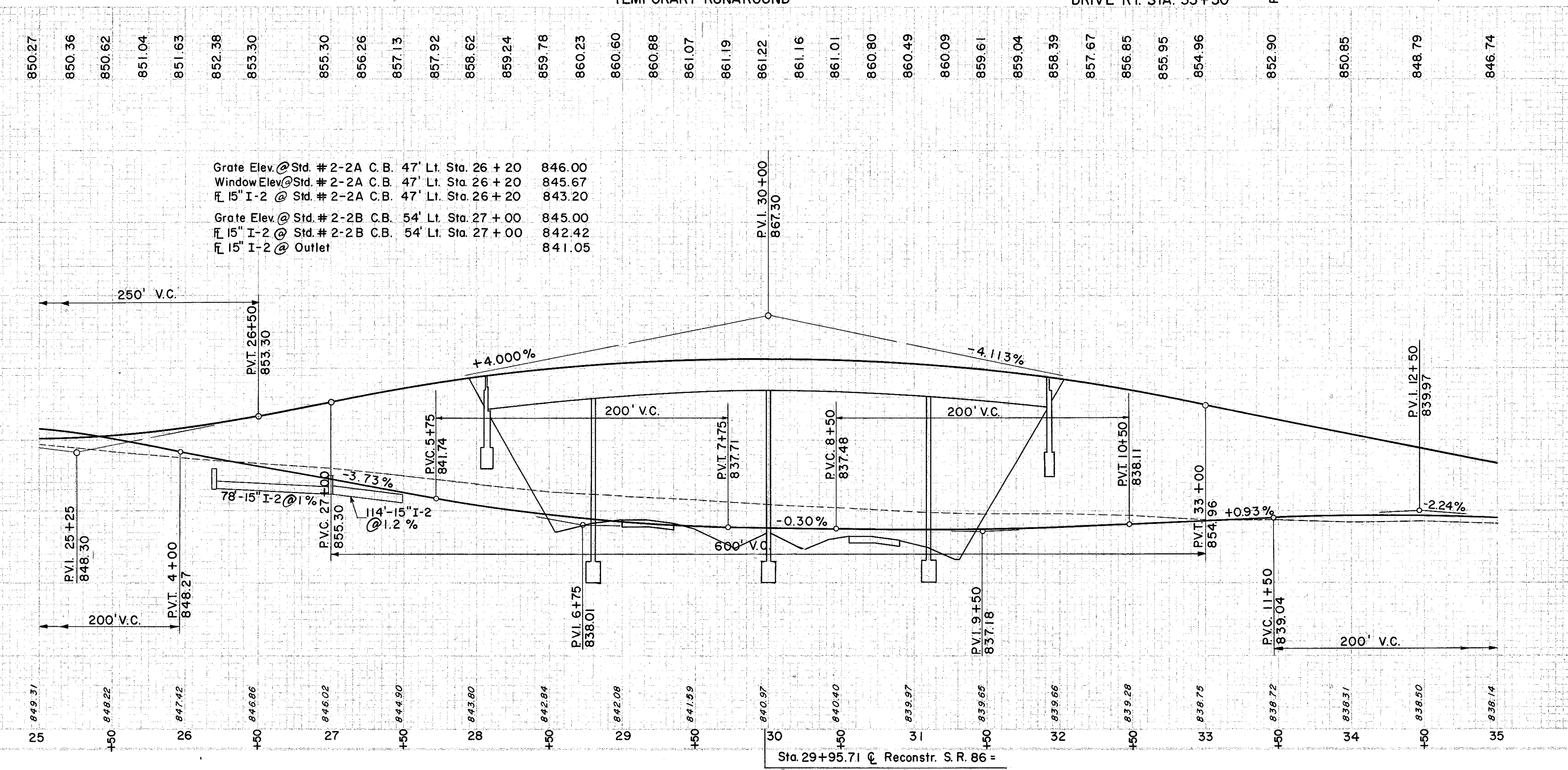
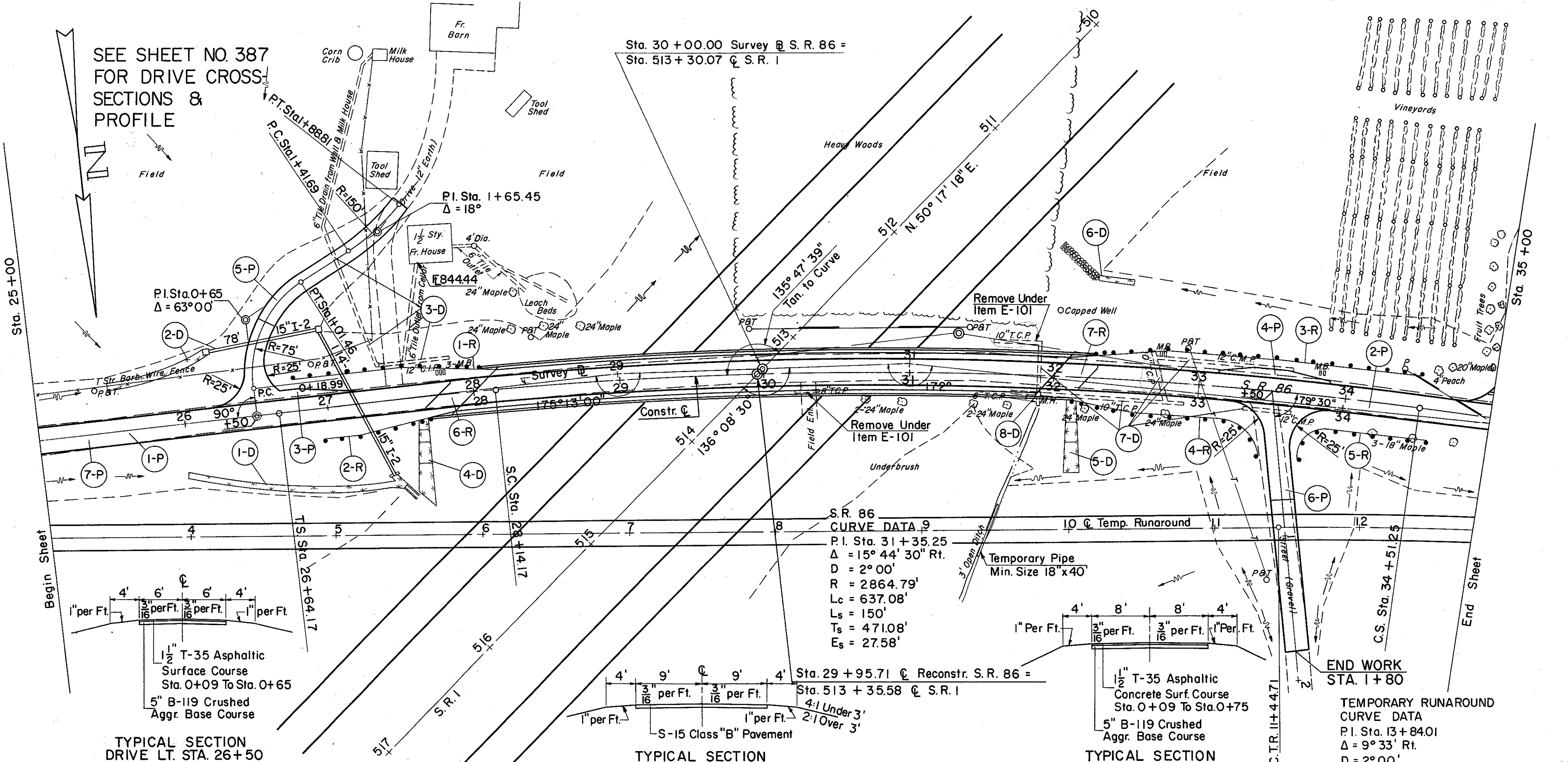

TYPICAL SECTION
DRIVE LT. STA. 26+50

TYPICAL SECTION
TEMPORARY RUNAROUND

TYPICAL SECTION
DRIVE RT. STA. 33+50

Grate Elev. @ Std. # 2-2A C.B. 47' Lt. Sta. 26+20 846.00
Window Elev. @ Std. # 2-2A C.B. 47' Lt. Sta. 26+20 845.67
15" I-2 @ Std. # 2-2A C.B. 47' Lt. Sta. 26+20 843.20
Grate Elev. @ Std. # 2-2B C.B. 54' Lt. Sta. 27+00 845.00
15" I-2 @ Std. # 2-2B C.B. 54' Lt. Sta. 27+00 842.42
15" I-2 @ Outlet 841.05

(R) ROADWAY

REF. NO.	SIDE	STATION	FROM	TO	REMOVAL OF CONC. APPROACH SLABS (1+13')	
1-R	LT	26+95	26+07.5	125	S.Y.	
2-R	RT	26+95	27+70	75	S.Y.	
3-R	LT	32+25	34+50	225	S.Y.	
4-R	RT	32+05	34+60	150	S.Y.	
5-R	RT	0+50	34+60	100	S.Y.	
6-R	RT	27+77.03	28+02.03	50	S.Y.	
7-R	RT	31+80.87	32+05.87	60	S.Y.	
					TOTAL	675

(P) PAVEMENT

REF. NO.	SIDE	STATION	FROM	TO	REMOVAL OF EXIST. PAVEMENT	CONSTRUCTION
1-P	LT	25+00	28+02.03	18.5	13.1	102
2-P	RT	26+70	27+90	19.4	206	131
3-P	LT	33+10	33+90	11.2	37	4.4
4-P	RT	33+50	34+50	11.8	53	6.3
5-P	LT	26+50	27+90	13.9	490	13
6-P	RT	33+50	34+50	13.9	270	83
7-P	RT	25+00	25+70	11.8	230	148
					TOTAL	232

(D) DRAINAGE

REF. NO.	SIDE	STATION	FROM	TO	REMOVAL OF EXIST. STRUCT.	CONSTRUCTION
1-D	RT	26+00	27+50	192	1	1
2-D	LT	26+20	27+40	215	1	1
3-D	RT	27+00	27+90	321	1	1
4-D	LT	27+60	32+50	321	1	1
5-D	RT	32+10	35+65	321	1	1
6-D	LT	32+25	35+65	321	1	1
7-D	RT	31+90	31+90	321	1	1
8-D	RT	31+90	31+90	321	1	1
					TOTAL	148

SODDING RIGHT DITCH

STATION	WIDTH	DEPTH	LENGTH	S.Y.
26+00	3.8	2.5	41	21.0
26+50	3.8	2.5	41	21.0
27+50	4.0	3.0	41	44.0
SUBTOTAL 650				

SODDING LEFT DITCH

STATION	WIDTH	DEPTH	LENGTH	S.Y.
26+50	5.2	4.5	41	92.0
26+30	5.2	4.5	41	90
32+25	3.4	2.0	41	25
32+50	3.4	2.0	41	25
SUBTOTAL 610				

Excavation = 626 C.Y.
 Embankment = 15,547 C.Y.
 Embankment - 17.5' = 18,268 C.Y.