

LAKE COUNTY
LAK-1-12.89

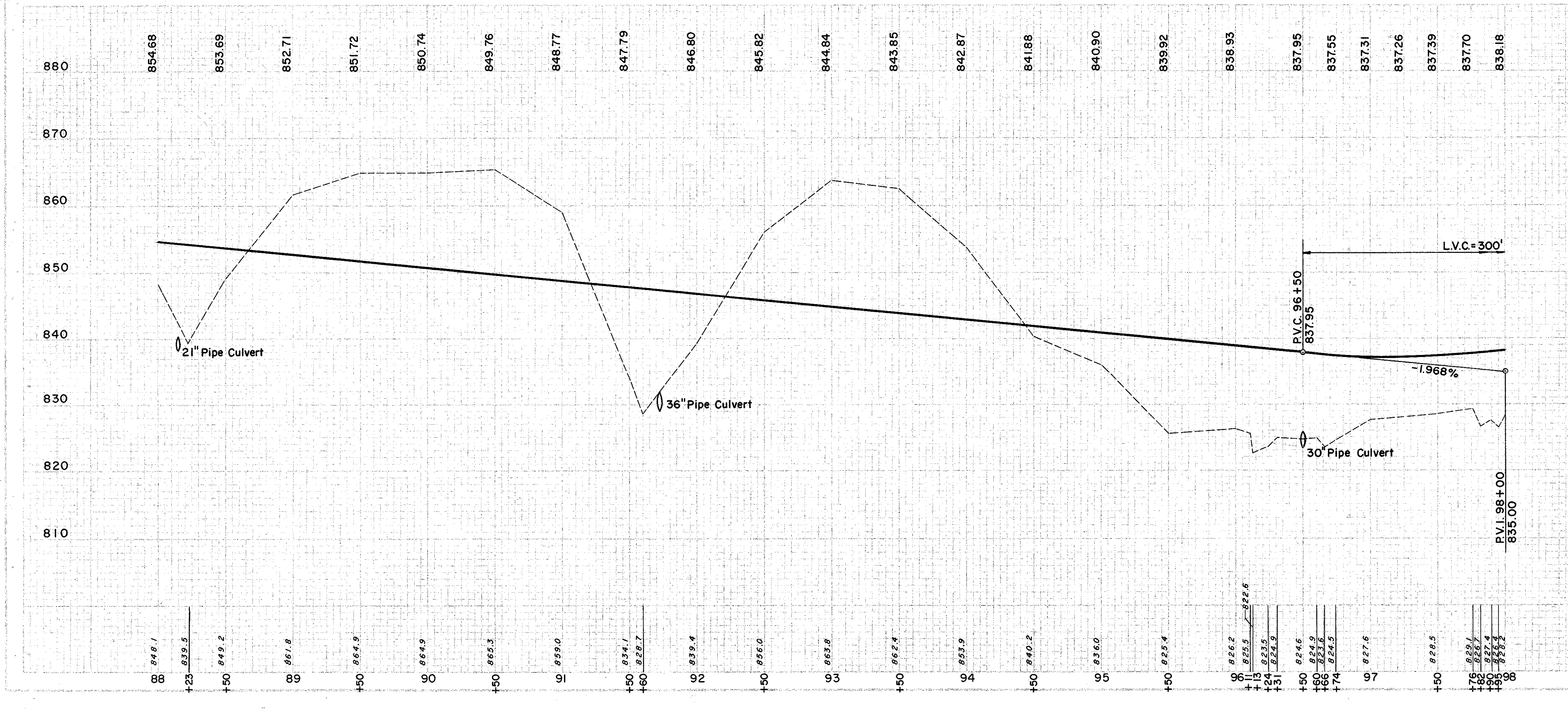
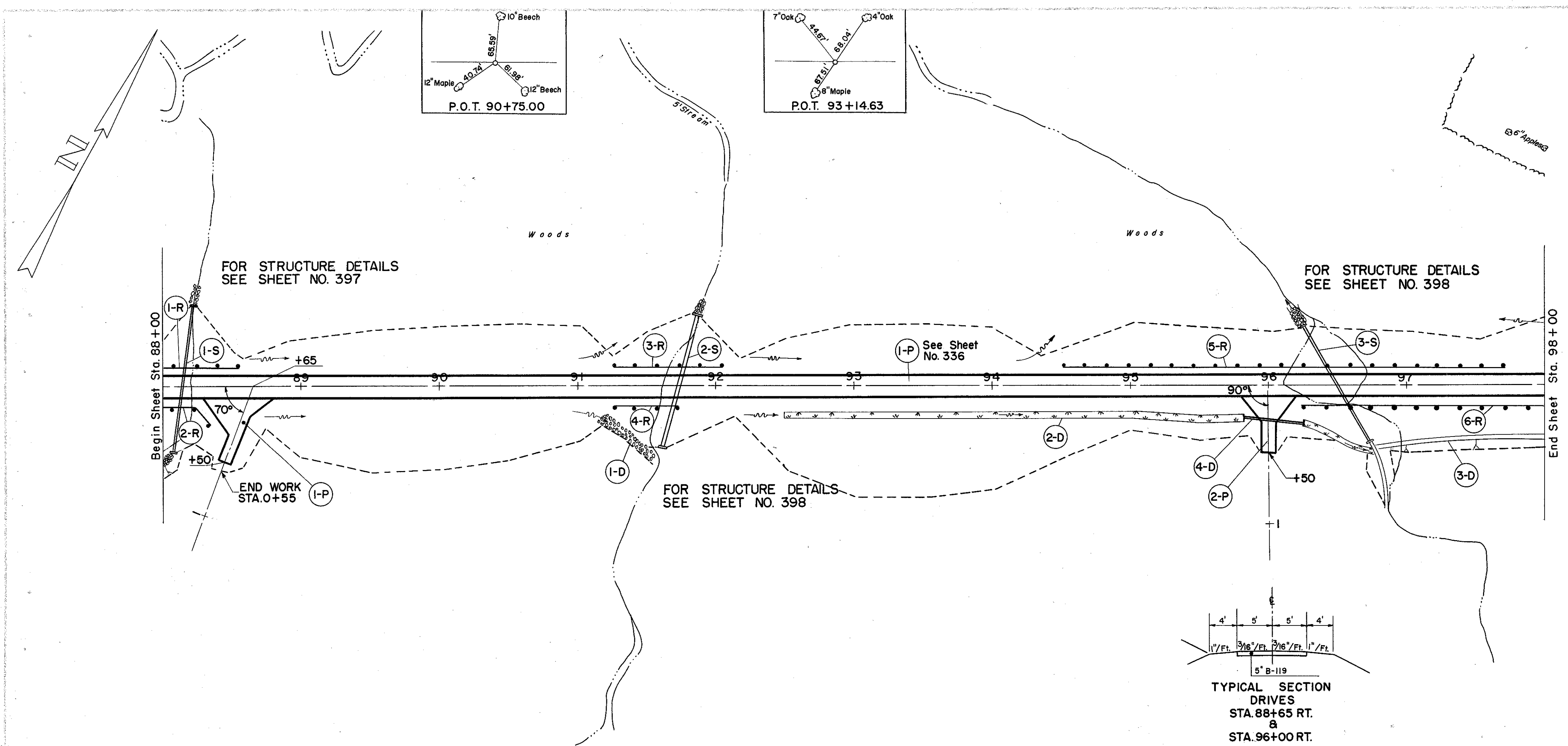

(R) ROADWAY

REF. NO.	STATION		SIDE	L.F.
	FROM	TO		
1-R	87+91	88+55	Lt.	64
2-R	87+75	88+59	Rt.	84
3-R	91+25	92+05	Lt.	80
4-R	91+25	91+73	Rt.	48
5-R	94+50	97+70	Lt.	320
6-R	96+25	98+01	Rt.	176
TOTAL				752

(S) STRUCTURES

REF. NO.	STATION	E-3		S-1		S-27		S-27		S-27		I-10		L-10	
		C.Y.	C.Y.	C.Y.	L.F.	L.F.	L.F.	C.Y.	S.Y.	C.Y.	S.Y.	C.Y.	S.Y.	C.Y.	S.Y.
1-S	88+15	180	30	0.72	110	102	98	20	8	7	11	7	12		
2-S	91+72	22	1	1.18											
3-S	96+50	35	7	1.02											

(P) PAVEMENT

REF. NO.	STATION	SIDE	E-10		B-119	
			C.Y.	S.Y.	C.Y.	S.Y.
1-P	88+65	Rt.	99	14		
2-P	96+00	Rt.	90	13		

(D) DRAINAGE

REF. NO.	STATION	SIDE	E-3		I-1		I-10		L-10	
			C.Y.	Rt.	L.F.	C.Y.	S.Y.	C.Y.	S.Y.	
1-D	91+25	Rt.	28							
2-D	92+50	Rt.								
3-D	96+75	Rt.	87							
4-D	98+00	Rt.			44					

STATION	SODDING RIGHT DITCH		SUB-TOTAL
	DEPTH OF SODDING	WIDTH OF SODDING	
92+50	0.15	2.9	110
95+00	0.5	4.1	175
96+75	0.3	4.1	86
SUB-TOTAL			196

EXCAVATION	= 19,369 C.Y.
EMBANKMENT	= 8,469 C.Y.
EMBANKMENT	= 175
EMBANKMENT	= 9,951 C.Y.