

I-M

W-7

139  
488

RCI-1103 (21)

LAKE COUNTY  
LAK-1-12.89  
**LAK-90-13.88-17.54**

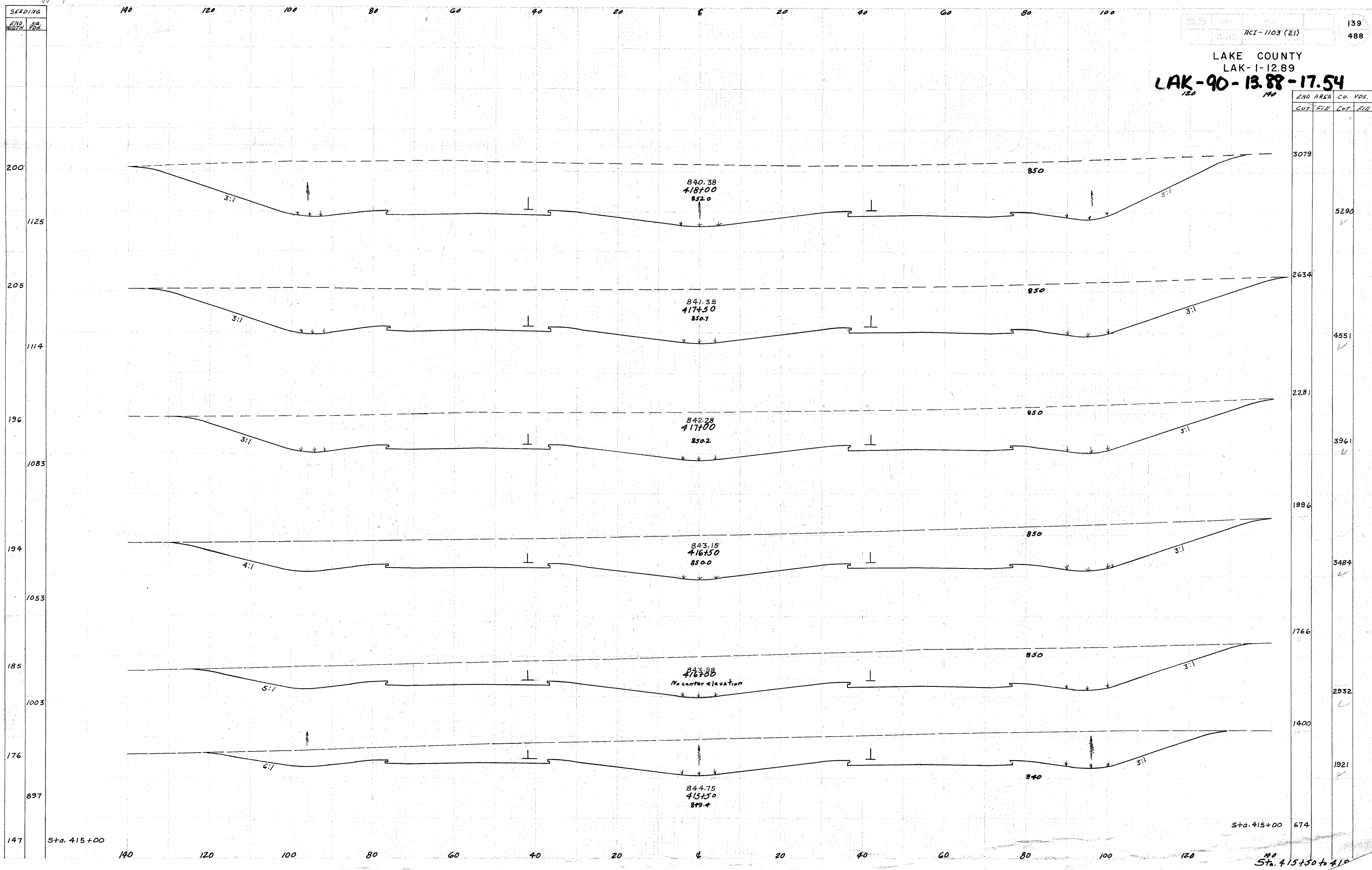

SEEDING

END STA. POS.

147 Sta. 415+00

140 120 100 80 60 40 20 0 20 40 60 80 100

200

205

196

194

185

176

840.38  
418+00  
852.0

841.35  
417+50  
850.7

842.28  
417+00  
850.2

843.15  
416+50  
850.0

843.88  
416+00  
No center elevation

844.75  
415+50  
849.4

850

850

850

850

850

840

3:1

3:1

3:1

3:1

4:1

5:1

6:1

Sta. 415+00

Sta. 415+00

Sta. 415+50 to 416