

LAKE COUNTY  
LAK-1-1289

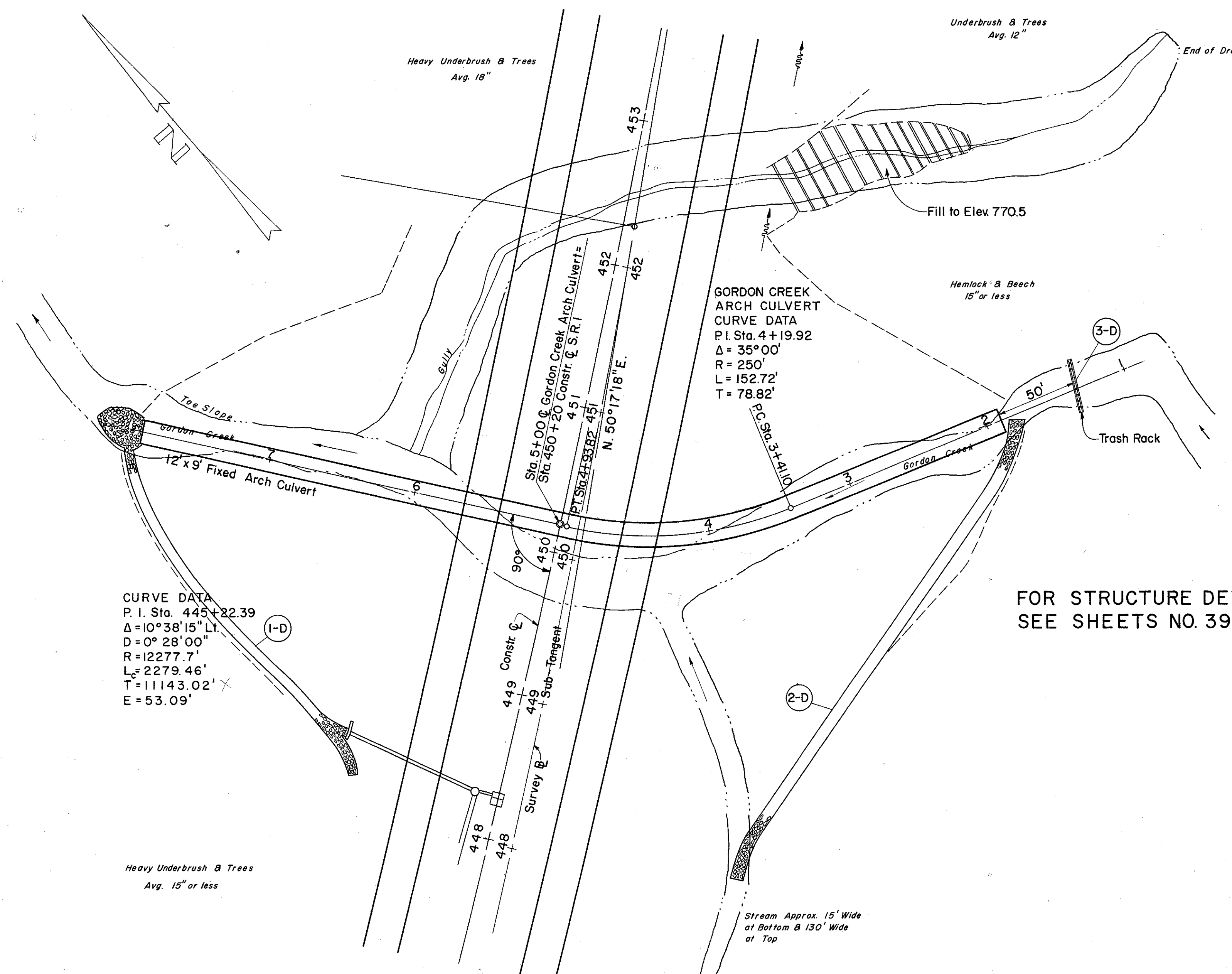

FOR STRUCTURE DETAILS  
SEE SHEETS NO. 395 & 396

CURVE DATA  
P.I. Sta. 445+22.39  
 $\Delta = 10^{\circ}38'15''$  LT.  
 $D = 0^{\circ}28'00''$   
 $R = 12277.7'$   
 $L_c = 2279.46'$   
 $T = 11143.02'$   
 $E = 53.09'$

GORDON CREEK  
ARCH CULVERT  
CURVE DATA  
P.I. Sta. 4+19.92  
 $\Delta = 35^{\circ}00'$   
 $R = 250'$   
 $L = 152.72'$   
 $T = 78.82'$

① DRAINAGE

REF. NO.	STATION		SIDE OR C.	I-10 DUMPED ROCK CHANNEL PROTECT C.Y.	TRASH RACK LUMP
	FROM	TO			
1-D	448+00	450+00	LT.	159	
2-D	448+00	451+50	RT.	265	
3-D	451+50		RT.		LUMP

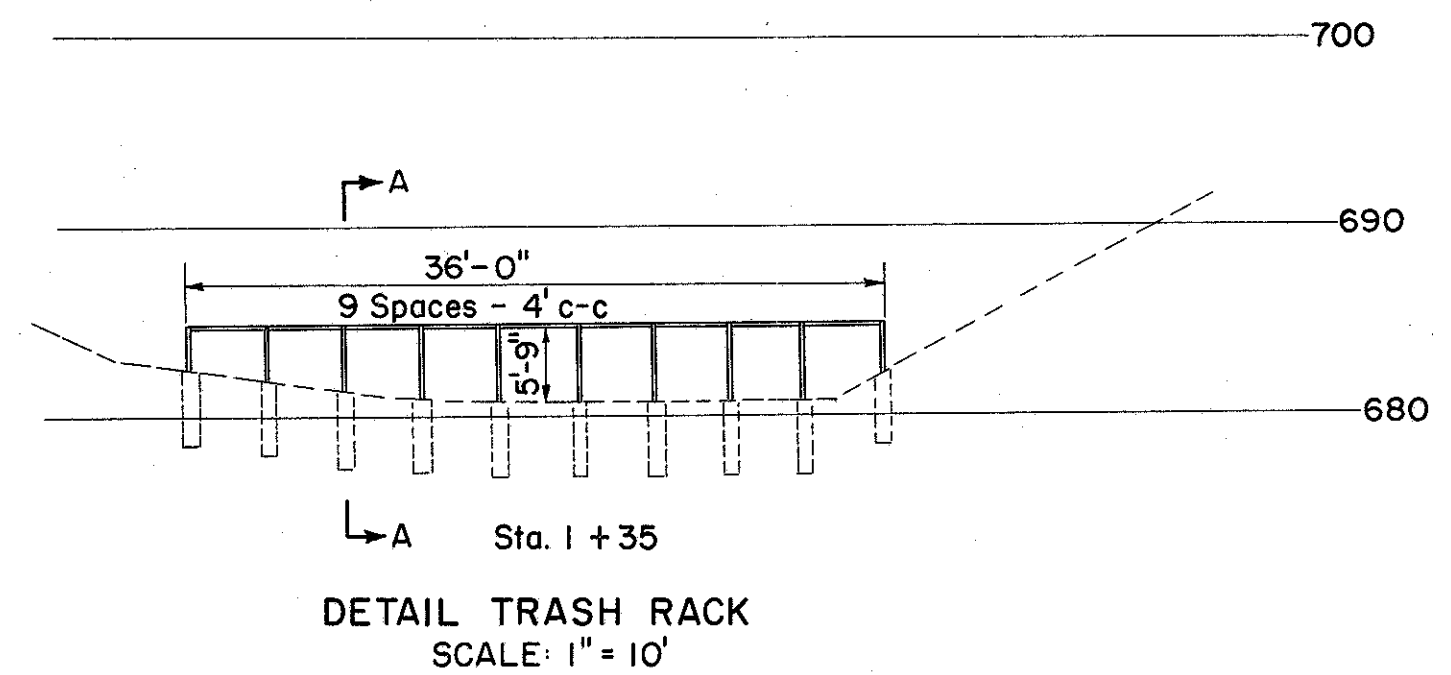
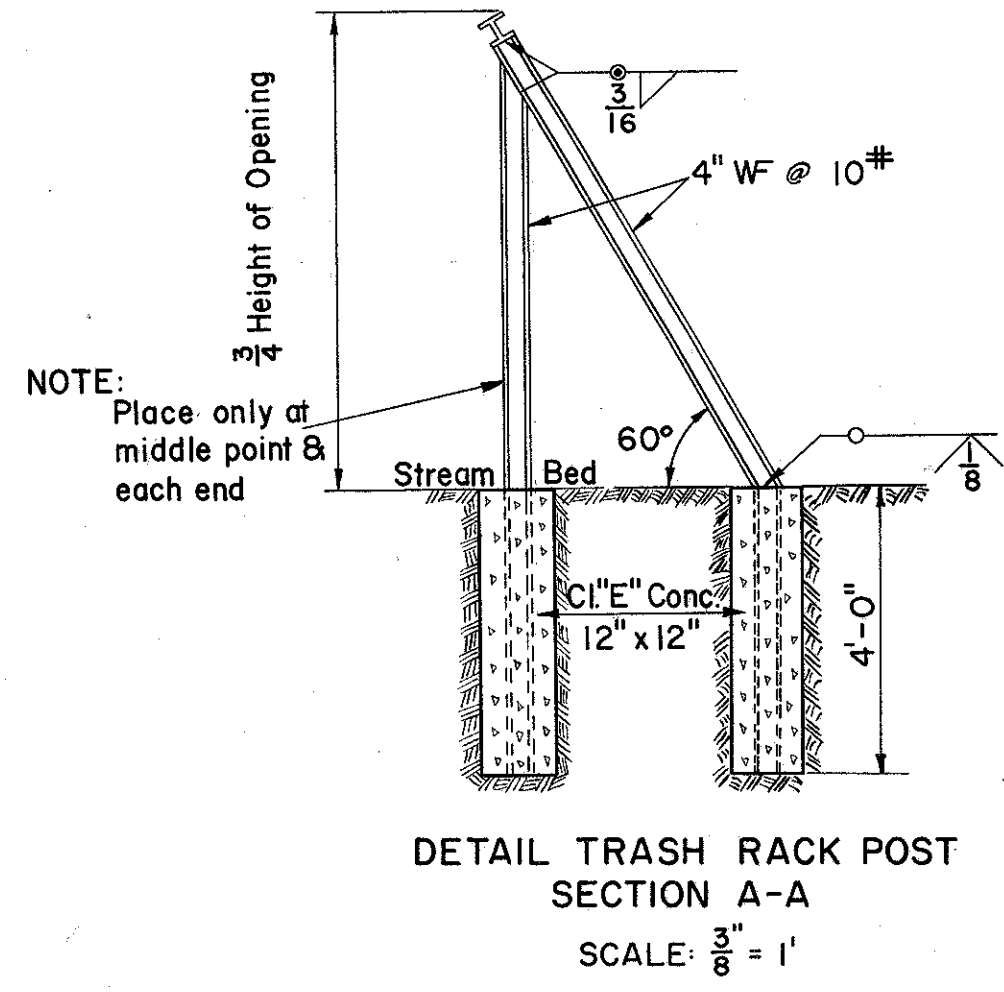

ESTIMATED QUANTITIES

S-7	S-1	E-2
STRUCT. STEEL	CONC. FOR STRUCT. CL'E	EXC. FOR STRUCT.
LBS.	C.Y.	
1434	2.0	2.0