

MICROFILMED
DEC 10 1987

SCHEMATIC LAYOUT PLAN

FED. RD. DIVISION	STATE	PROJECT	13 488
2	OHIO	ACI-1103 (21)	

LAKE COUNTY
LAK-1-12.89

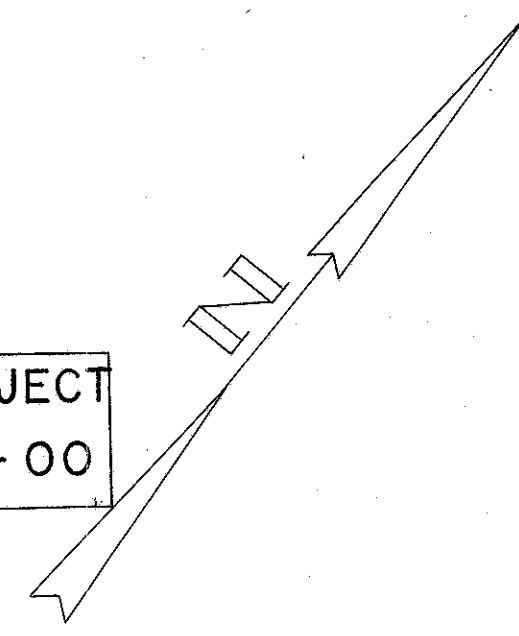
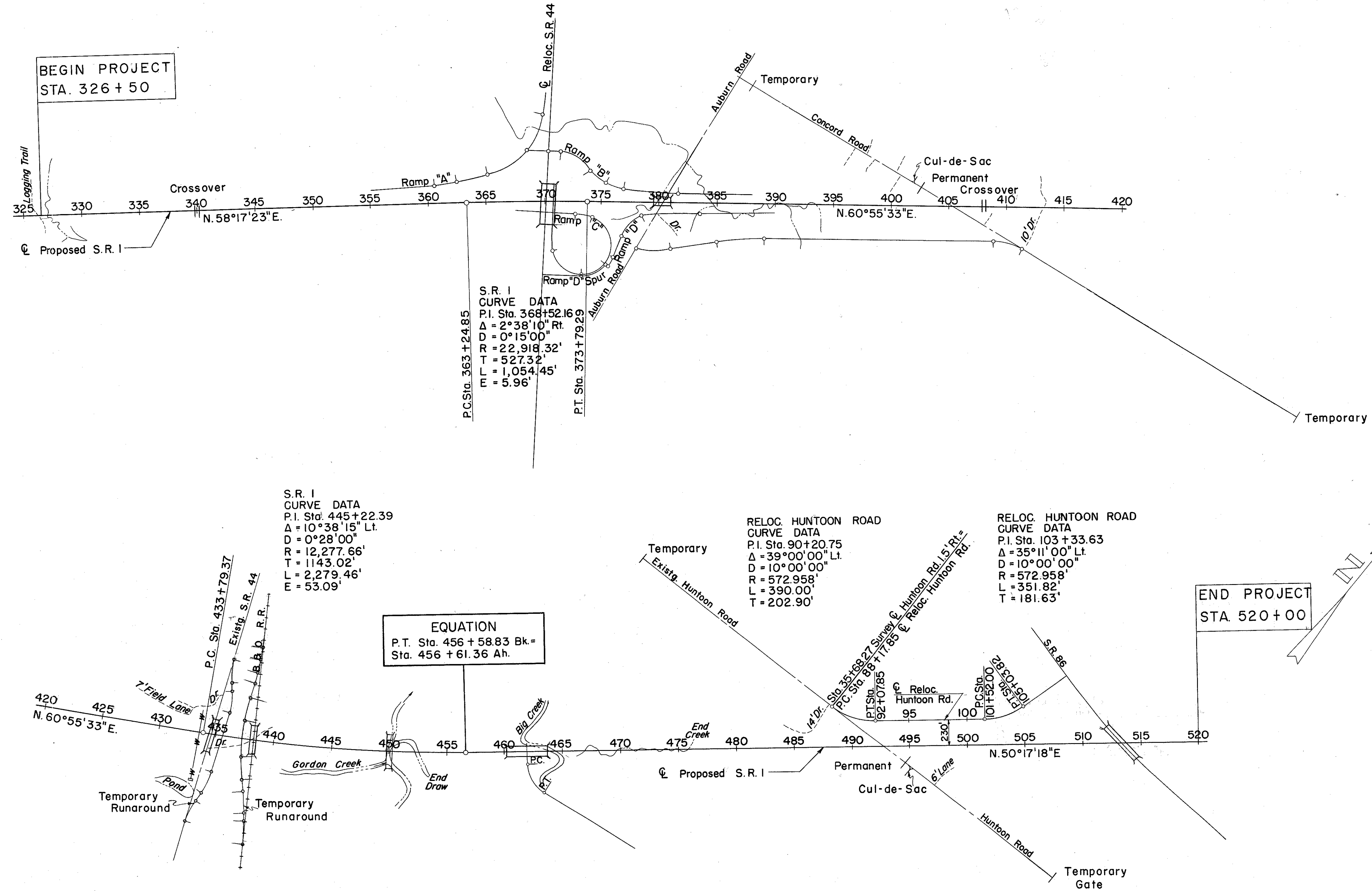
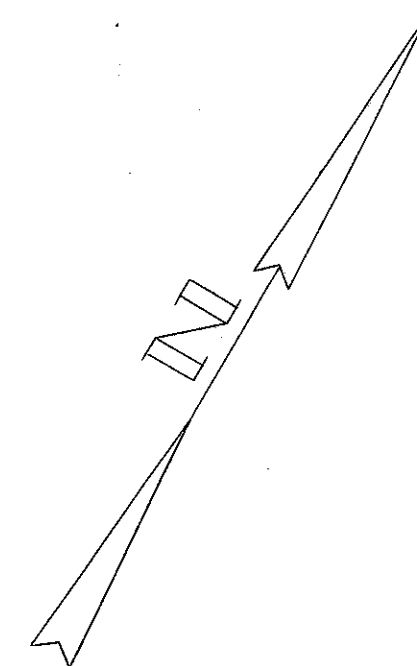

EQUATION
 P.T. Sta. 456 + 58.83 Bk.=
 Sta. 456 + 61.36 Ah.

NOTE:
 The contractor shall furnish, erect and maintain lights, signs and danger signals on each local road at its nearest intersections each direction from the interstate project, as indicated on the schematic layout, during the period the local road is closed for reconstruction or relocation. Standard Road Closed signs shall be 40" x 24" size and each shall be mounted on a moveable gate as detailed on Standard Construction Drawing No. G-7.07. Lights shall meet the requirements set forth in Section G-7.07 of the specifications. Cost of furnishing, erecting, maintaining and moving lights, signs and gates shall be included in the lump sum bid for Maintaining Traffic.