

FED. RD. DIVISION	STATE	PROJECT
2	OHIO	

LAKE COUNTY
ASHTABULA COUNTY
LAK.-1-12.89
ATB.-1-0.00

S-GC

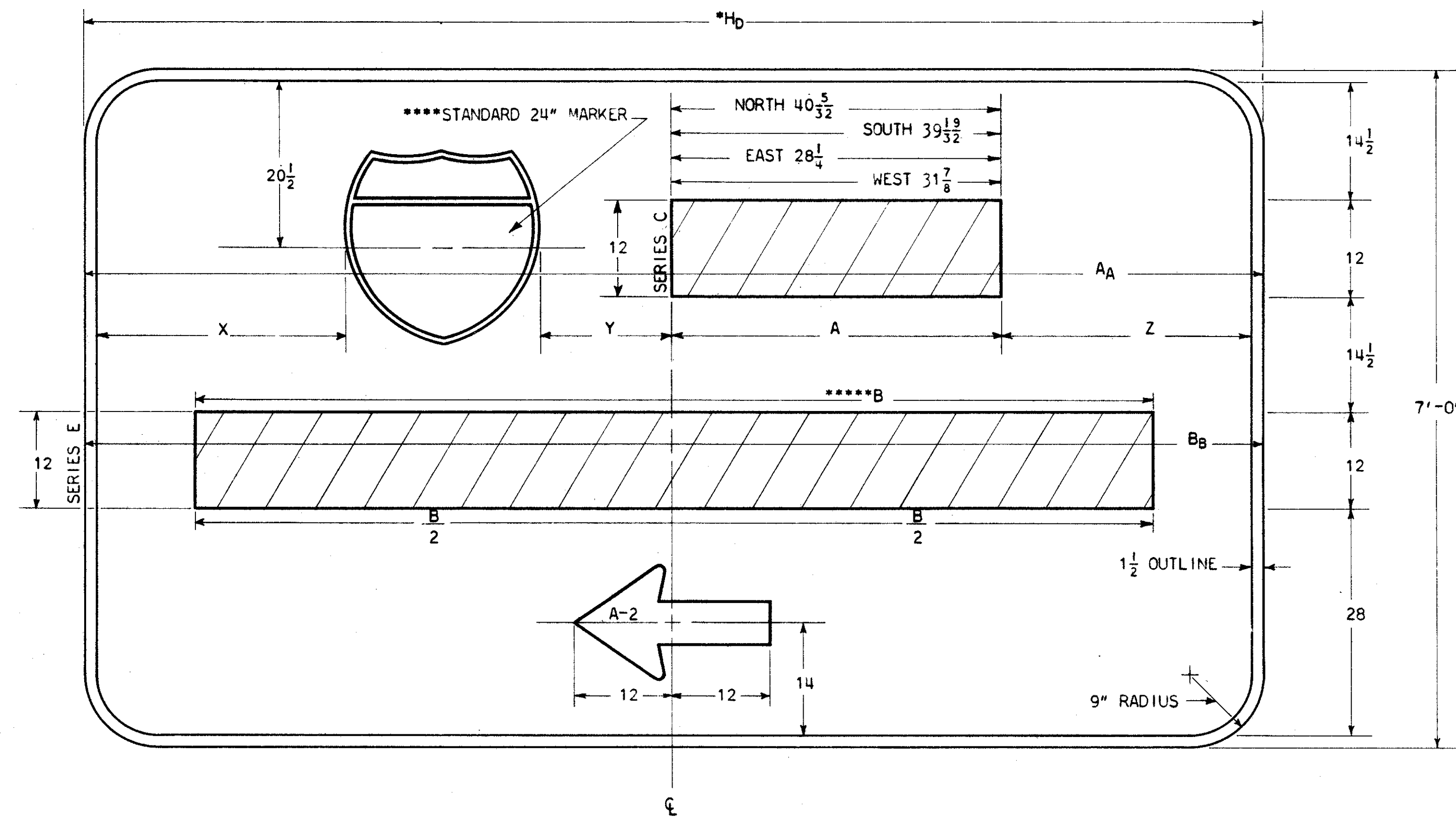

*TO FIND H_D
 H_D IS DETERMINED BY A_A OR B_B WHICHEVER IS GREATER.

TO FIND A_A
 $A + 64'' \pm (**)$ = A_A (SEE NOTE ***)

TO FIND B_B
 $B + 27'' \pm (**)$ = B_B

**ADD OR SUBTRACT UP TO 3" TO KEEP H_D TO EVEN FOOT OR HALF FOOT.

SPACES X, Y, AND Z SHALL BE EQUAL EXCEPT THAT Y SHALL NEVER EXCEED 16"; X AND Z SHALL ALWAYS BE EQUAL.

***DESIGN SHOWN IS FOR ONE ROUTE MARKER. INCREASE A_A 36" FOR EACH ADDITIONAL ROUTE MARKER. SPACE BETWEEN ROUTE MARKERS SHALL BE EQUAL TO Y.

****OHIO AND U.S. MARKERS SHALL HAVE BLACK NUMERALS AND BORDER ON WHITE BACKGROUND. INTERSTATE MARKERS SHALL BE RED, WHITE AND BLUE.

*****B SHALL BE COMPUTED BY DOUBLING THE SPACING GIVEN IN THE "OHIO MANUAL OF UNIFORM TRAFFIC CONTROL DEVICES FOR STREETS AND HIGHWAYS" FOR 12" LETTERS.

ALL DIMENSIONS ARE IN INCHES UNLESS OTHERWISE SHOWN.

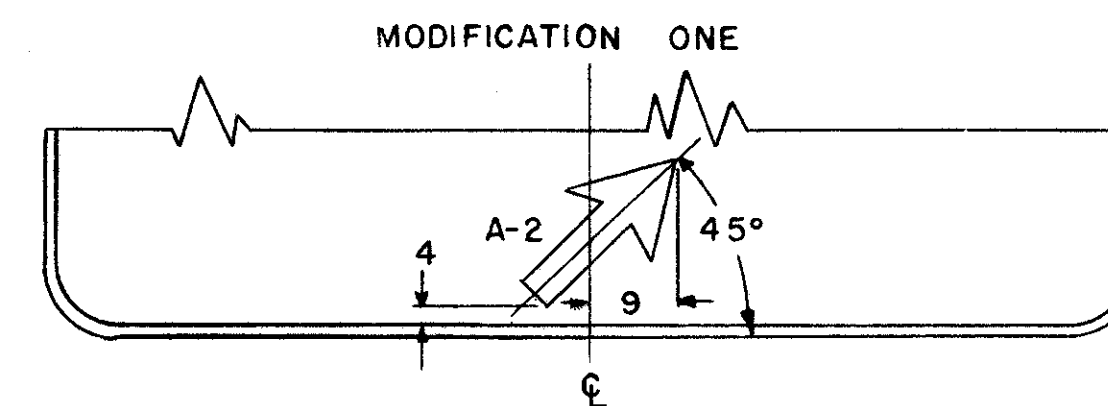

TYPICAL SIGNS

