

LEGEND

- EXISTING LIGHT POLE
- ▣ EXISTING PICNIC TABLE ON CONC. SLAB
- EXISTING BARBECUE ON CONC. FOUNDATION
- ⊕ EXISTING HYDRANT

CURVE DATA

P.I. = STA. 206 + 88.93
 Δ = 33° 09' 33" LT.
D = 0° 28' 00"
R = 12,277.67'
L = 7,105.37'
T = 3,655.27'
E = 532.51'

NOTE: THE CONTRACTOR SHALL CONSTRUCT MANHOLES AND INSTALL CONDUIT USING METHODS WHICH WILL NOT DISTURB EXISTING ROADWAY ITEMS, I.E. PAVEMENT, GUARDRAIL, UNDERDRAINS, LIGHTING, ETC. ANY ROADWAY ITEMS DISTURBED BY THE CONTRACTOR'S OPERATIONS SHALL BE REPLACED OR REPAIRED TO THE SATISFACTION OF THE PROJECT ENGINEER AT NO ADDITIONAL COST TO THE STATE.

NOTE: THE EXACT LOCATION AND DEPTH OF THE DUCT CABLE SERVICING THE RAMP LIGHTING IS NOT KNOWN. THIS EXISTING CABLE IS TO BE ABANDONED AND REPLACED BY NEW DUCT CABLE AS PART OF THIS CONTRACT.

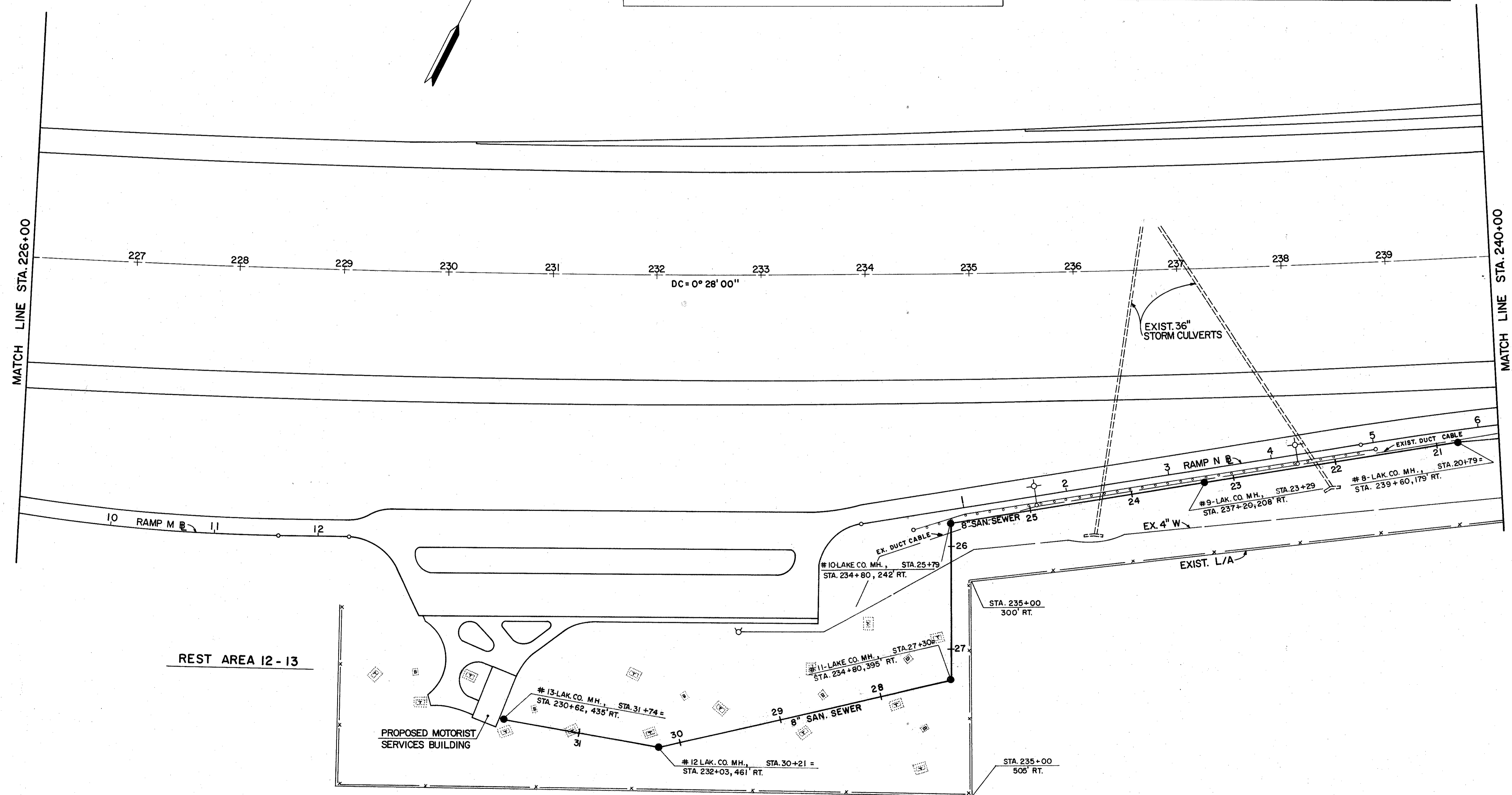
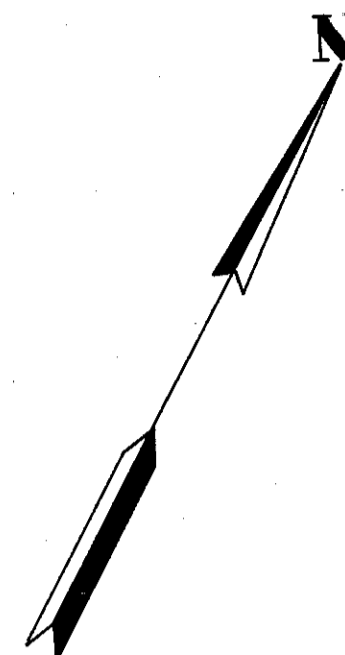

REST AREA 12-13

PROPOSED MOTORIST SERVICES BUILDING

MATCH LINE STA. 226+00

MATCH LINE STA. 240+00