

WESTBOUND - PLANTING PLAN

PLANT LIST

KEY	BOTANICAL NAME	SIZE	CONDITION	QUANTITY
ASS	ACER SACCHARUM 'GREEN MOUNTAIN'	2-2 1/2"	B4 B	1
UPS	ULMUS PARVIFOLIA	2-2 1/2"	B4 B	5
PA	PICEA ABIES	6-8'	B4 B	4
PM	PELIDOTSUGA MENZIESI	6-8'	B4 B	10
AL	AMELANCHIER LAEVIS (CLUMP TYPE)	6-8'	B4 B	3
MP	MYRICA PENNSYLVANICA	18-24"	B4 B	31
TMH	TAXUS MEDIA 'HICKSI'	18-24"	B4 B	13
VPT	VIBURNUM FLICATUM TOMENTOSUM 'MARESHII'	2-3'	B4 B	15
VON	VIBURNUM OPULUS 'NANUM'	12-15"	CONT.	39
VM	VINCA MINOR 'ALBA' *	1YR	FLATS	6500
PT	PACHYSANDRA TERMINALIS *	1YR	FLATS	7600

ESTIMATED QUANTITIES:

ITEM	DESCRIPTION	QUANTITY
GENERAL CONTRACT		
SPECIAL	6' WOOD BENCH	2 EACH
659	COMMERCIAL FERTILIZER	.17 TON
659	SEEDING AND MULCHING	1,850 SQ. YDS.
660	SODDING, AS PER PLAN	200 SQ. YDS.

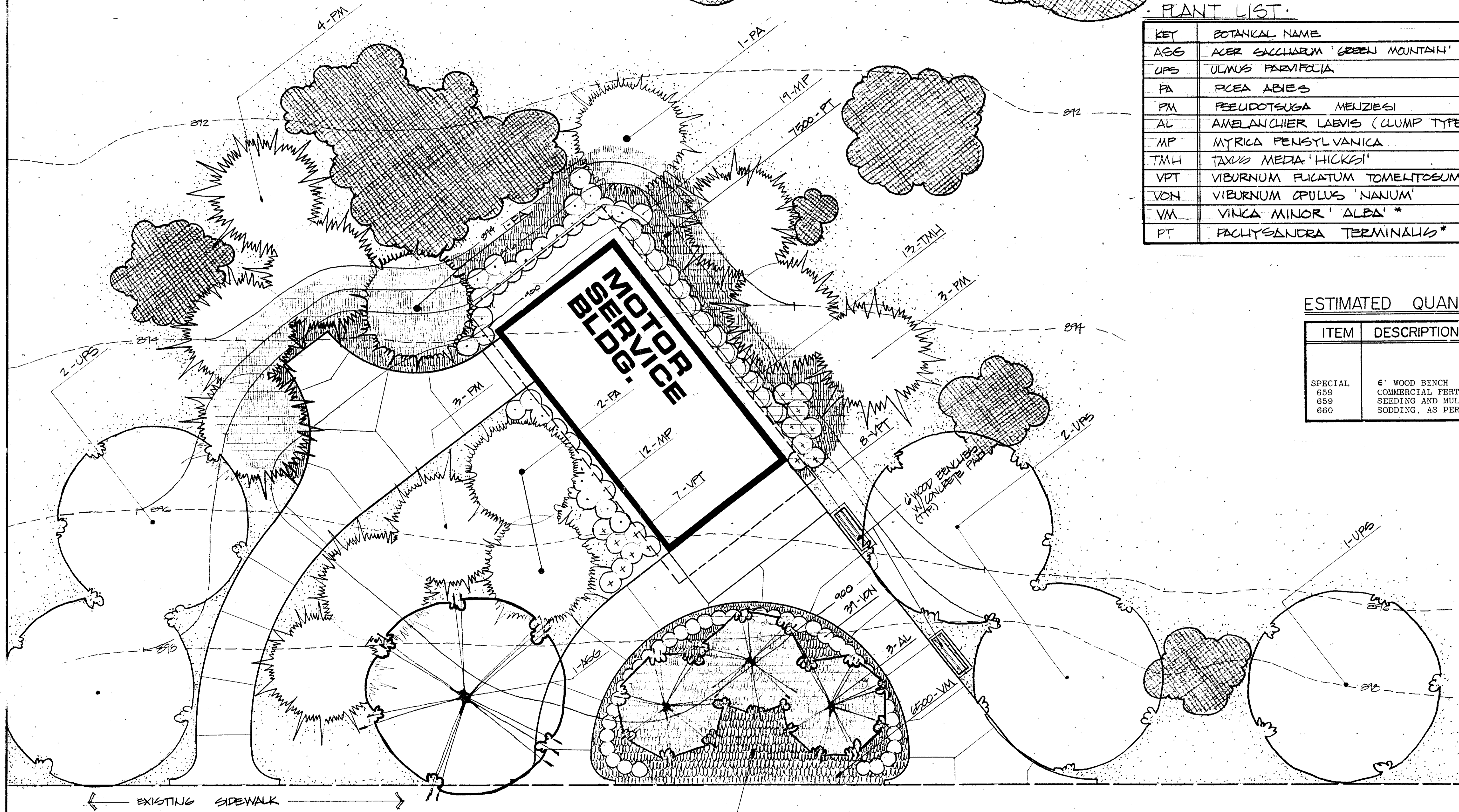

EXISTING TREES TO BE SAVED (FOR TREE REMOVAL SEE SHEET 12.)

* ALL GROUND COVERS PLANTED 6" ON CENTER.

FOR PLANT BED PREPARATION & BACK FILL SEE PLANT HOLE & BED PREPARATION IN GENERAL NOTES, SHEET 2A.