

Location	519		SPECIAL	
	Patching concrete structures, as per plan		Patching concrete with trowelable mortar	
	Est. Quant. - SQ. FT.	Est. Quant. - SQ. FT.	Est. Quant. - SQ. FT.	Est. Quant. - SQ. FT.
Curbs	190			
Parapets			60	
Piers			152	
Abutments			210	
Wingwalls				
50% Expansion Factor	95		211	
Total	285		633	

Survey date: 1-29-92

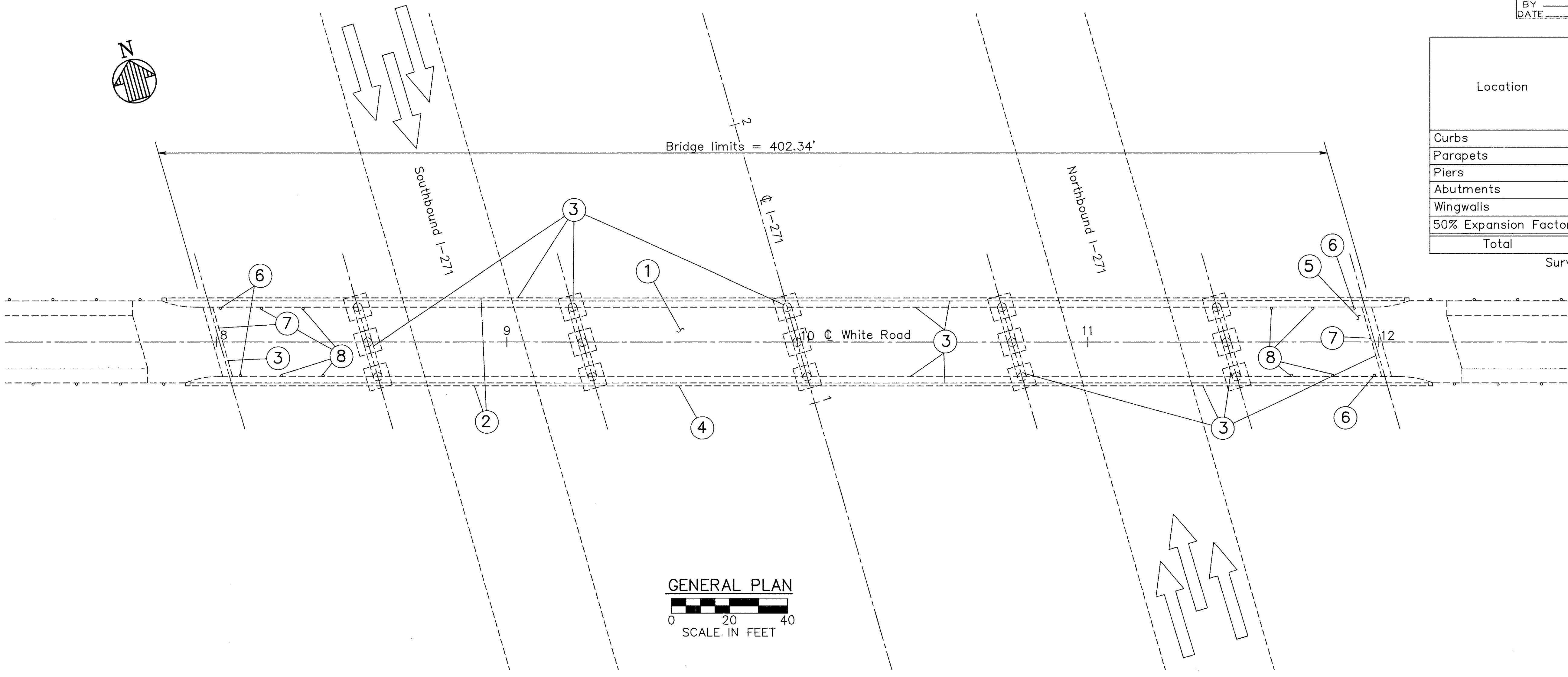

EXISTING STRUCTURE

TYPE: Continuous steel beam with reinforced concrete deck & substructure.

SPANS: 51'-0", 73'-11", 73'-11", 73'-11", 73'-11", 51'-0" c/c bearings

ROADWAY: 24'-0" f/f 2'-0" safety curbs

LOAD FREQUENCY: C.F. = 130(57)

SKEW: 15°59'49" R.F.

WEARING SURFACE: 3/4" monolithic concrete + 1 3/4" concrete overlay

APPROACH SLAB: Special design (25' long)

ALIGNMENT: Tangent

SUPERELEVATION: None

MODIFIED STRUCTURE

TYPE: Continuous steel beam with reinforced concrete deck & substructure.

SPANS: 51'-0", 73'-11", 73'-11", 73'-11", 73'-11", 51'-0" c/c bearings

ROADWAY: 24'-0" f/f 2'-0" safety curbs

LOAD FREQUENCY: C.F. = 130(57)

SKEW: 15°59'49" R.F.

WEARING SURFACE: 2" microsilica modified concrete overlay

APPROACH SLAB: Special design (25' long)

ALIGNMENT: Tangent

SUPERELEVATION: None

INDEX OF PROPOSED WORK ITEMS

Item	Description	Detail Location
1	Replace existing concrete overlay with 2 inch microsilica modified concrete overlay	Gen. Notes & Trans. Section
2	Install vandal protection fence	Gen. Notes & sheet 22 / 22
3	Patch and seal concrete surfaces	Gen. Notes
4	Deck bottom repair	Gen. Notes
5	Slope repair and protection	Gen. Notes
6	Plug existing scupper	Gen. Notes
7	Seal expansion joint with poured polyurethane joint seal	Gen. Notes
8	Modify existing scupper	Gen. Notes

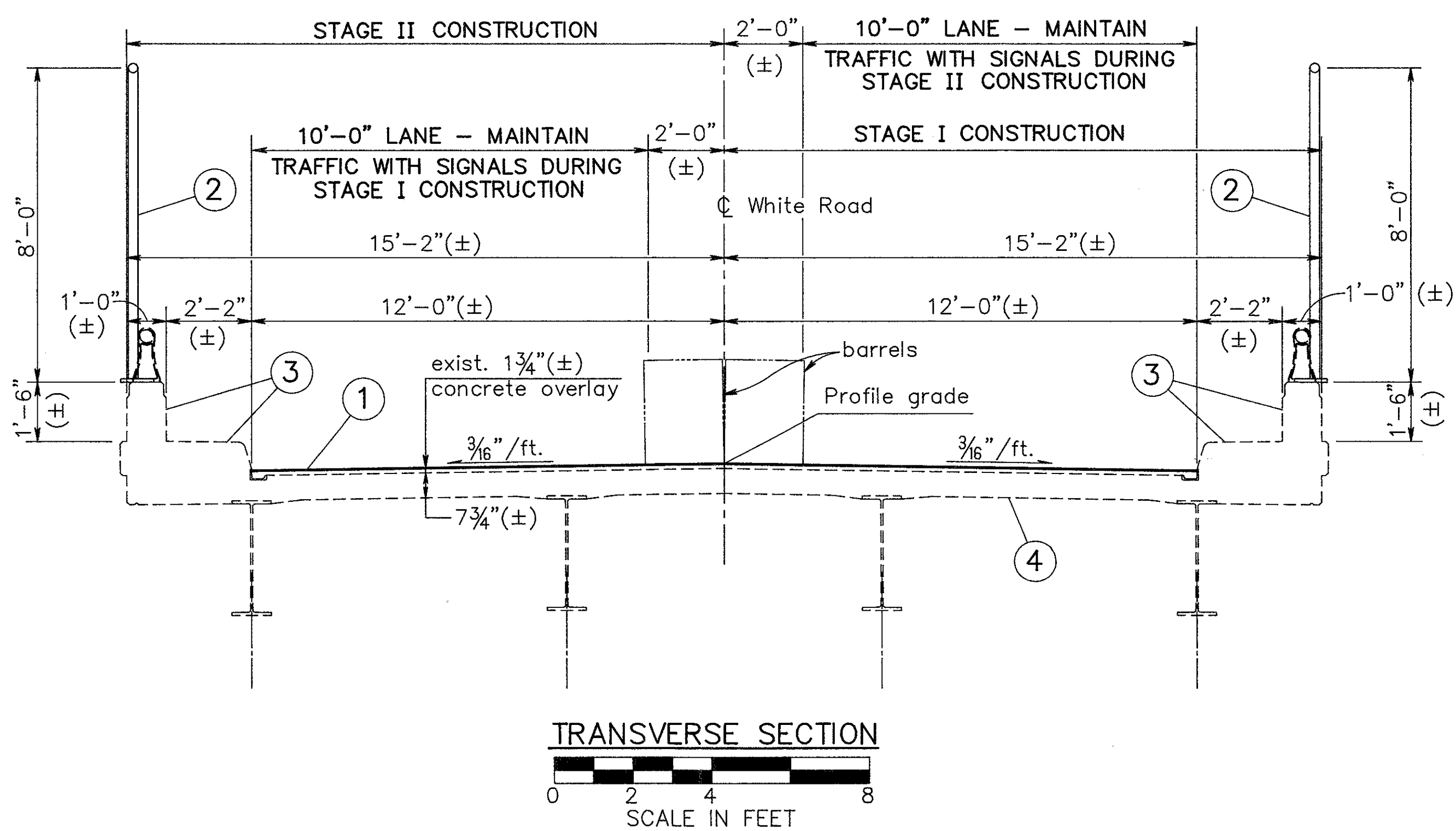

7 / 22

STILSON & ASSOCIATES, INC.
 CONSULTING ENGINEERING AND ARCHITECTURE
 COLUMBUS AND CLEVELAND

GENERAL PLAN & ELEVATION

BRIDGE NO. LAK-271-0001
 UNDER WHITE ROAD

LAKE COUNTY STA. 1+21.89

DESIGNED	DRAWN	TRACED	CHECKED	REVIEWED	DATE	REVISED
W.M.	R.T.P.		V.S.	G.W.M.	2/21/92	