

# TRAFFIC MAINTENANCE

|                                     |                          |                    |
|-------------------------------------|--------------------------|--------------------|
| LAKE COUNTY<br>LAK-90/271-1.88/0.00 | OHIO<br>FHWA<br>REGION 5 | 27<br>185          |
|                                     |                          | FEDERAL<br>PROJECT |

FOR TEMPORARY PAVEMENT MARKING  
LEGEND SEE SHEET 25 .

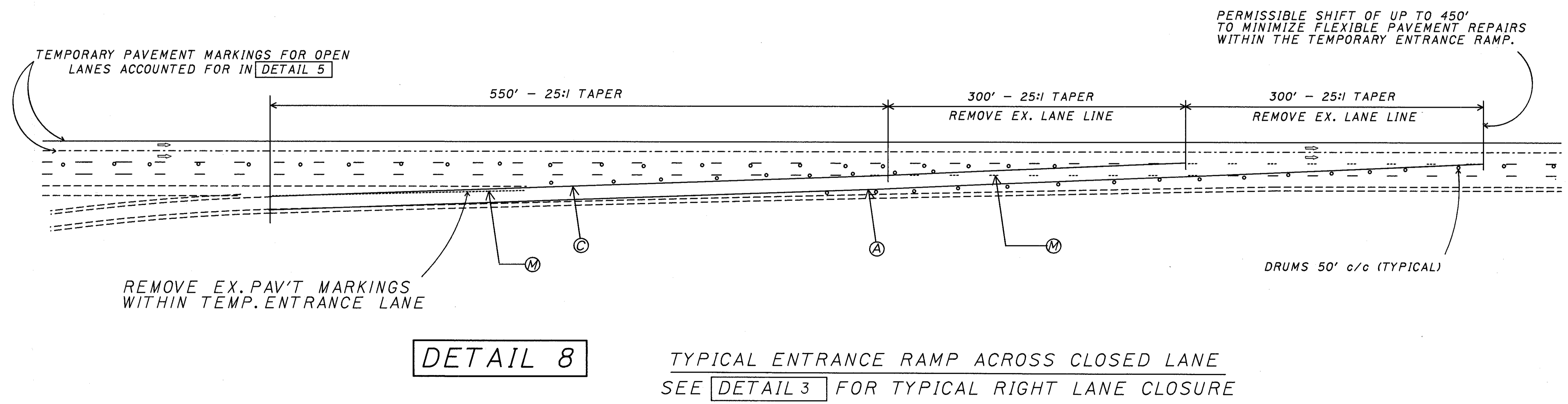
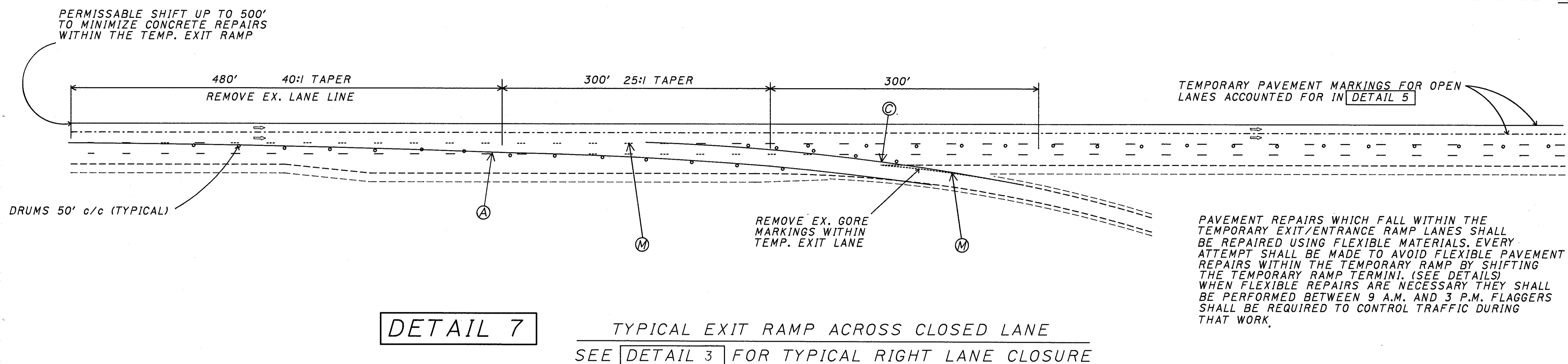

THESE DETAILS ARE APPLICABLE  
DURING PHASE II (RIGHT LANE CLOSURE)

PLOT SUBMITTED BY: uliman

c:\dgn\p1\d05772\05772mde.dgn

PLOT SUBMITTED: 29-OCT-1992 07:51