

TRAFFIC MAINTENANCE

LAKE COUNTY
LAK-90/271-1.88/0.00

OHIO
FHWA
REGION 5
FEDERAL
PROJECT

25
185

PLOT SUBMITTED: 29-OCT-1992 07:43
PLOT SUBMITTED BY: uliman
c:\dgn\p\d05772\05772mdd.dgn

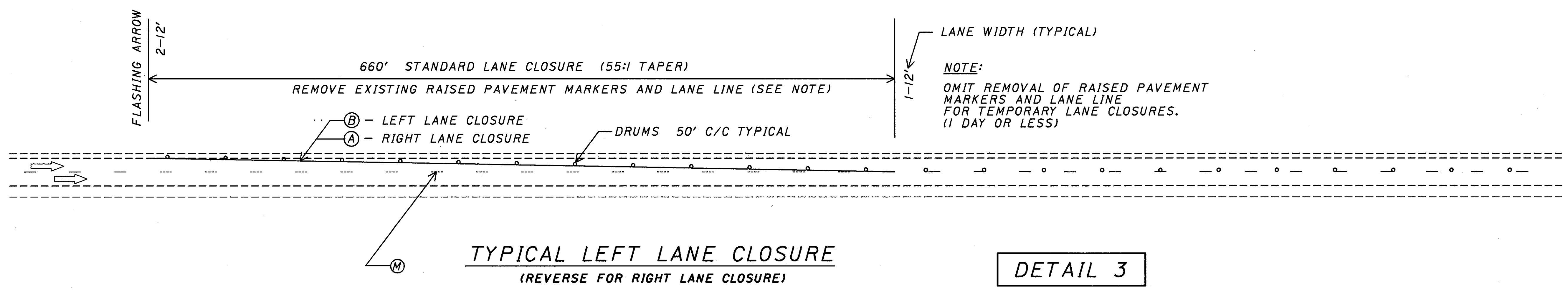
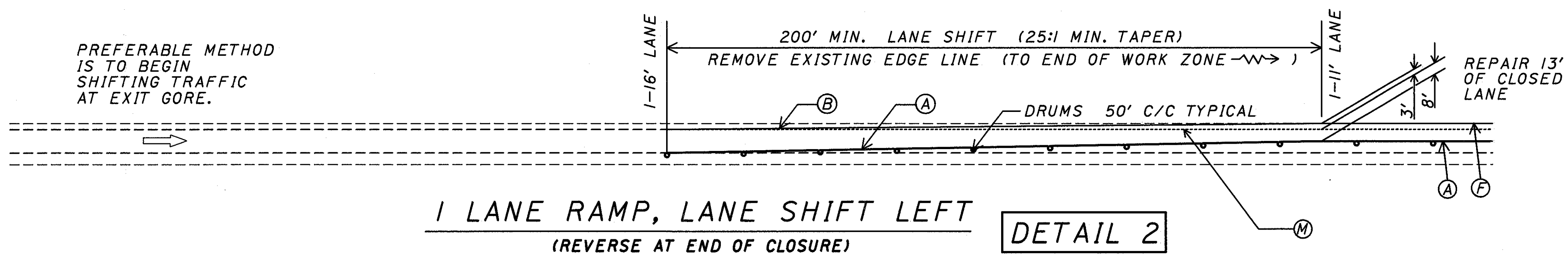
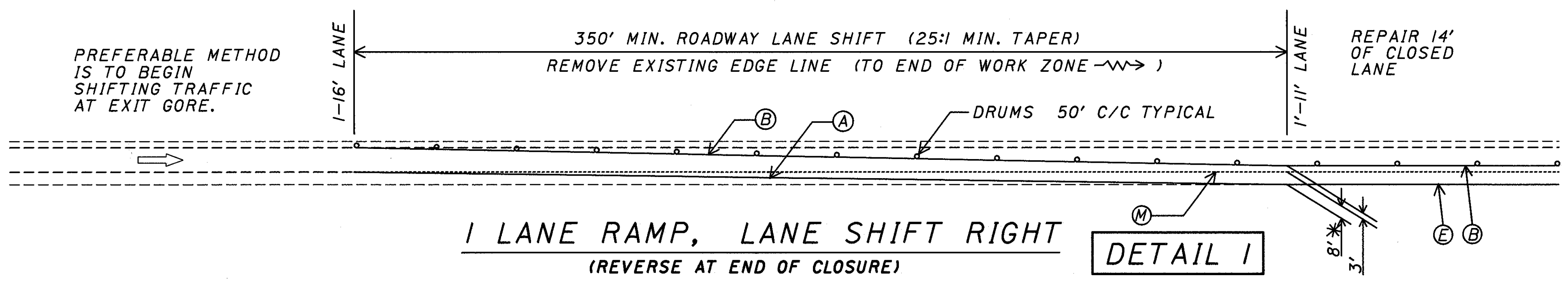

TEMPORARY PAVEMENT MARKING LEGEND

- Ⓐ - TEMPORARY EDGE LINES, CLASS 1, 740.05, TYPE C (WHITE)
- Ⓑ - TEMPORARY EDGE LINES, CLASS 1, 740.05, TYPE C (YELLOW)
- Ⓒ - TEMPORARY CHANNELIZING LINE, CLASS 1, 740.05 TYPE C
- Ⓔ - TEMPORARY EDGE LINE, CLASS 1 (WHITE) ⊕
- Ⓕ - TEMPORARY EDGE LINE, CLASS 1 (YELLOW) ⊕
- Ⓖ - PORTABLE CONCRETE BARRIER, 32"
- Ⓗ - PORTABLE CONCRETE BARRIER, 32", BRIDGE MOUNTED
- Ⓙ - TEMPORARY LANE LINE, CLASS 1 ⊕
- Ⓚ - TEMPORARY LANE LINE, CLASS 1, 740.05, TYPE C
- Ⓛ - TEMPORARY LANE LINE, CLASS 1, REMOVE EX. EDGE LINES Ⓜ
- Ⓜ - REMOVAL OF PAVEMENT MARKINGS
- ⊕ - ALL TEMPORARY PAVEMENT MARKINGS WHICH ARE TO BE INSTALLED BEYOND THE PROPOSED RESURFACING LIMITS SHALL BE 740.05, TYPE C (THIS ALSO INCLUDES ALL BRIDGE DECKS)

NOTE:

RAMP PAVEMENT REPAIR

ALL PROPOSED REPAIRS TO RAMPS ARE TO BE DONE WITH FLEXIBLE REPAIRS USING TEMPORARY DAYTIME LANE CLOSURES. WHEN TEMPORARY LANE CLOSURES ARE USED, NO TEMPORARY PAVEMENT MARKINGS OR REMOVALS SHALL BE REQUIRED AND ONLY DRUMS SPACED AS SHOWN SHALL BE REQUIRED.

IF THE ENGINEER DETERMINES THAT RIGID CONCRETE REPLACEMENT IS NECESSARY, THESE DETAILED TRAFFIC MAINTENANCE SCHEMES INCLUDING TEMPORARY PAVEMENT MARKINGS SHALL BE IMPLEMENTED.

REMOVAL OF EXISTING PAVEMENT MARKINGS

EXISTING PAVEMENT MARKINGS WHICH ARE TO BE REMOVED ARE SHOWN AS SHORT DASHES