

# TRAFFIC MAINTENANCE

LAKE COUNTY  
LAK-90/271-1.88/0.00

OHIO

FHWA  
REGION 5

FEDERAL  
PROJECT

23  
185

## TRAFFIC CONTROL AND SEQUENCING OF PAVEMENT WORK (3 LANE SECTION)

### PHASE I)

SHIFT TRAFFIC TO RIGHT TWO LANES (SEE MAINTENANCE OF TRAFFIC DETAILS NUMBER 3,6,9 AND 11)

- REMOVE WEARING COURSE ON CLOSED LANES.
- CONSTRUCT CONCRETE SHOULDER, REPAIR PAVEMENT AND INSTALL UNDERDRAINS
- PLACE ITEM 301 AND ITEM 446 - INTERMEDIATE COURSE, SAW AND SEAL JOINTS.
- INSTALL TEMPORARY PAVEMENT MARKINGS FOR NEXT PHASE.

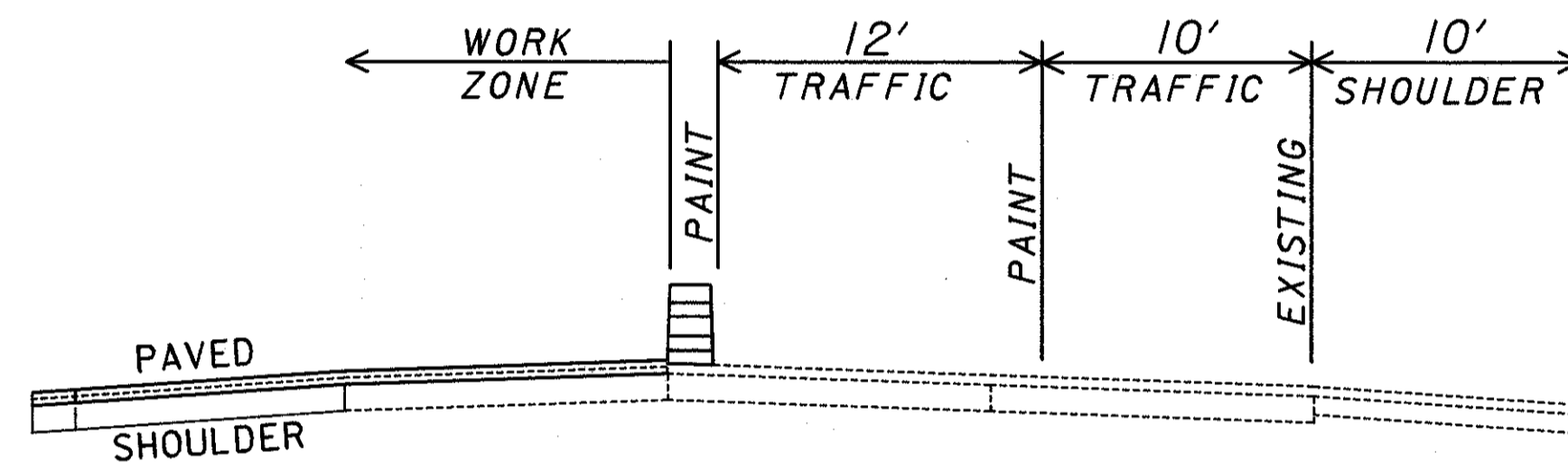

### PHASE II)

SHIFT TRAFFIC ONTO THE LEFT (INSIDE) SHOULDER. (SEE MAINTENANCE OF TRAFFIC DETAILS NUMBER 3,5,10 AND 12.)

- REMOVE WEARING COURSE ON CLOSED LANES AND SHOULDER.
- REPAIR PAVEMENT AND INSTALL UNDERDRAINS.
- PLACE ITEM 301 AND ITEM 446 - INTERMEDIATE AND SURFACE COURSES.
- SAW AND SEAL JOINTS.
- INSTALL TEMPORARY AND FINAL PAVEMENT MARKINGS WHERE APPROPRIATE AT FINAL LOCATIONS.

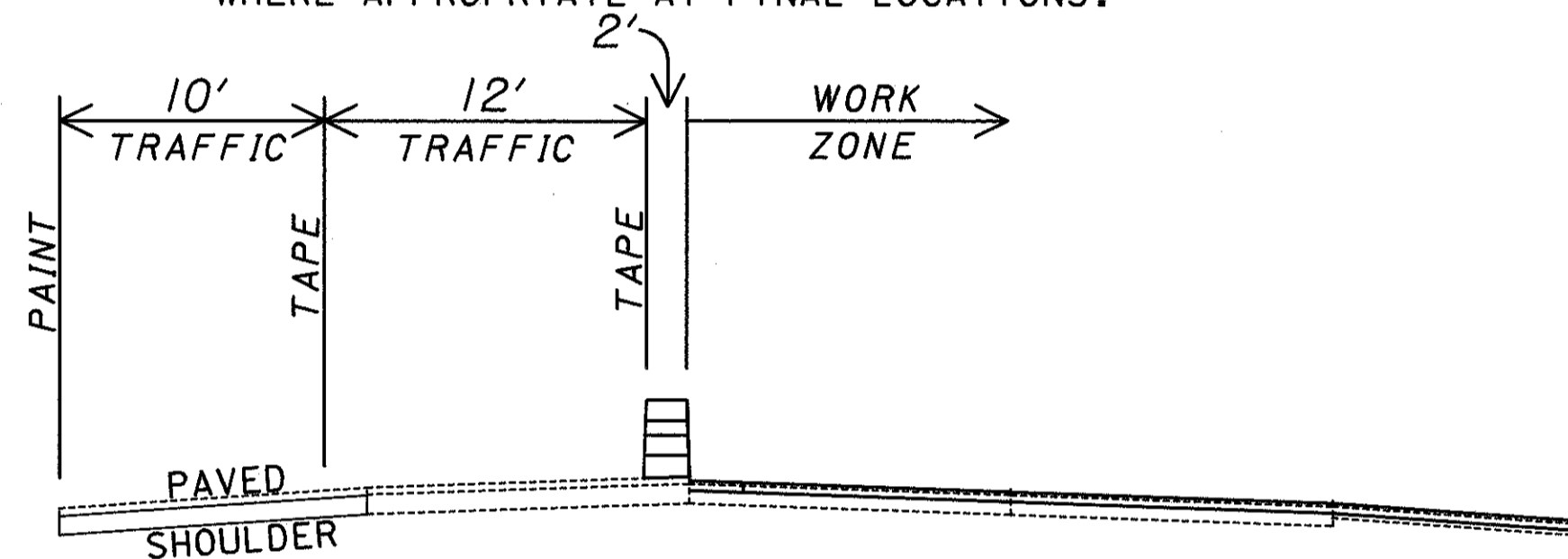

### PHASE III)

RE-OPEN ROADWAY TO ALL LANES.

- CLOSE LEFT LANE USING STANDARD LANE CLOSURES (SHORT TERM, NIGHT TIME ONLY.)
- PLACE ITEM 446 - SURFACE COURSE, SAW AND SEAL JOINTS.
- INSTALL TEMPORARY PAVEMENT MARKING AT FINAL LOCATIONS.

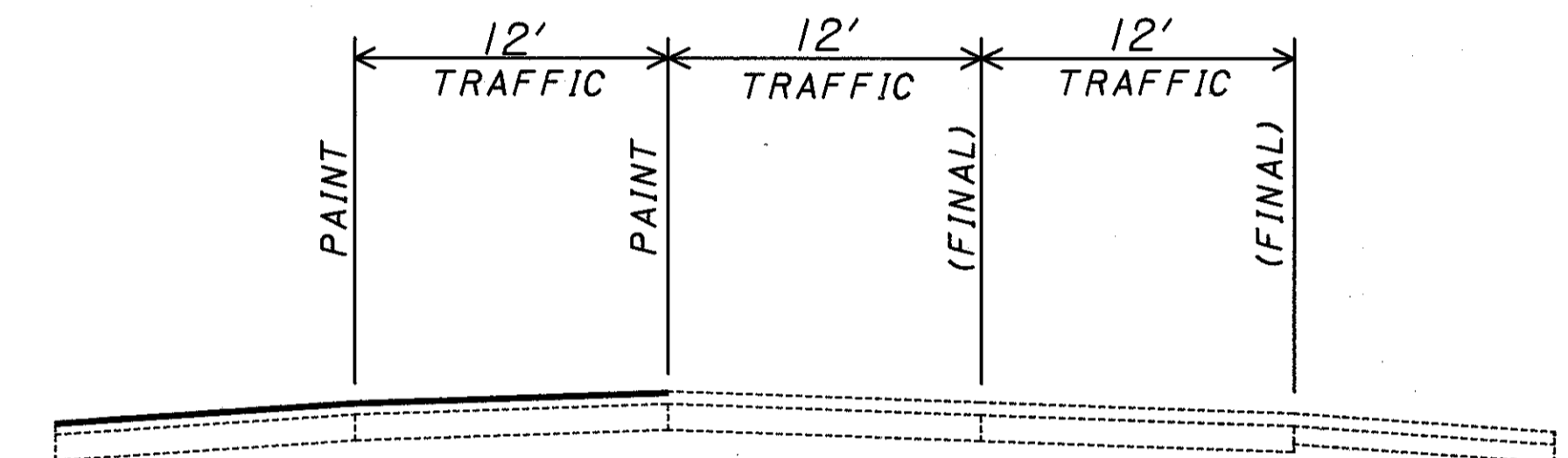

## TRAFFIC CONTROL AND SEQUENCING OF PAVEMENT WORK (1-271-2 LANE SECTION)

### PHASE I)

MOVE TRAFFIC ONTO THE RIGHT LANE AND CLOSE THE LEFT LANE AS PER MAINTENANCE OF TRAFFIC DETAIL 4.

- REMOVE WEARING COURSE ON LEFT LANE.
- CONSTRUCT CONCRETE SHOULDER, REPAIR PAVEMENT AND INSTALL UNDERDRAINS.
- PLACE ITEM 301 AND ITEM 446 - INTERMEDIATE COURSE (LEFT SHOULDER AND 10 FEET OF THE LEFT LANE.)
- SAW AND SEAL TRANSVERSE JOINTS.
- INSTALL TEMPORARY PAVEMENT MARKINGS FOR NEXT PHASE.

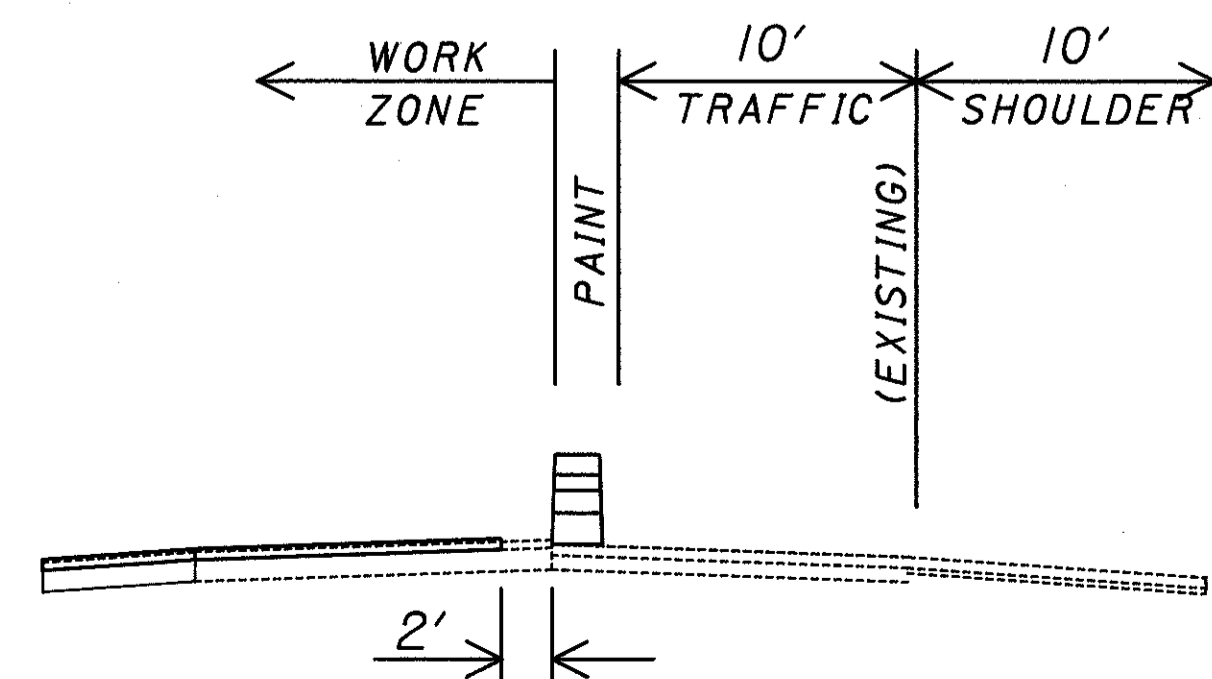

### PHASE II)

MOVE TRAFFIC ONTO THE LEFT LANE AND CLOSE THE RIGHT LANE AND SHOULDER.

- REMOVE WEARING COURSE ON RIGHT LANE AND SHOULDER.
- REPAIR PAVEMENT AND INSTALL UNDERDRAINS.
- PLACE ITEM 301 AND ITEM 446 - INTERMEDIATE AND SURFACE COURSES
- SAW AND SEAL TRANSVERSE JOINTS.
- INSTALL FINAL PAVEMENT MARKINGS AT FINAL LOCATIONS, WHERE APPLICABLE.

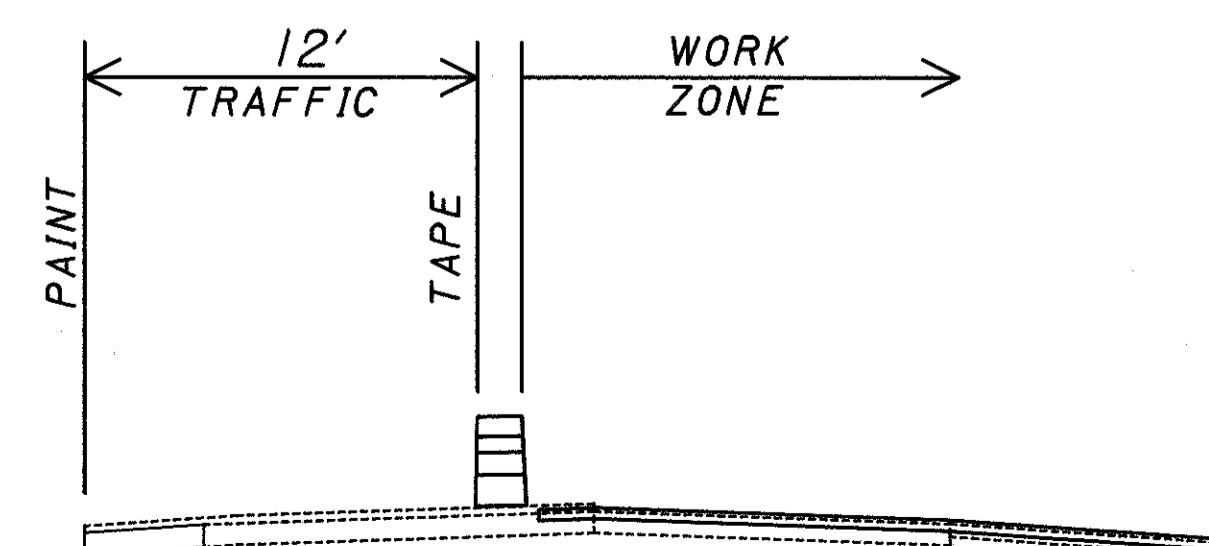

### PHASE III)

RE-OPEN ROADWAY TO ALL LANES.

- CLOSE THE LEFT LANE USING STANDARD LANE CLOSURE (SHORT TERM, NIGHT TIME ONLY.)
- PLACE ITEM 446 - SURFACE COURSE.
- SAW AND SEAL TRANSVERSE JOINTS.
- INSTALL TEMPORARY PAVEMENT MARKINGS AT FINAL LOCATIONS.

