

@ CURVE DATA (IR-90)
 PC STA. = 57+65.60
 PT STA. = 128+76.23
 DELTA = 53°19'47"
 D = 0°45'00"
 R = 7639.44'
 L = 7110.63'
 S.E. = 0.024 FT/FT

@ CURVE DATA (IR-90)
 PC STA. = 204+77.25
 PT STA. = 214+83.73
 DELTA = 1°30'35"
 D = 0°09'00"
 R = 38,197.19'
 L = 1006.48'
 S.E. = ----

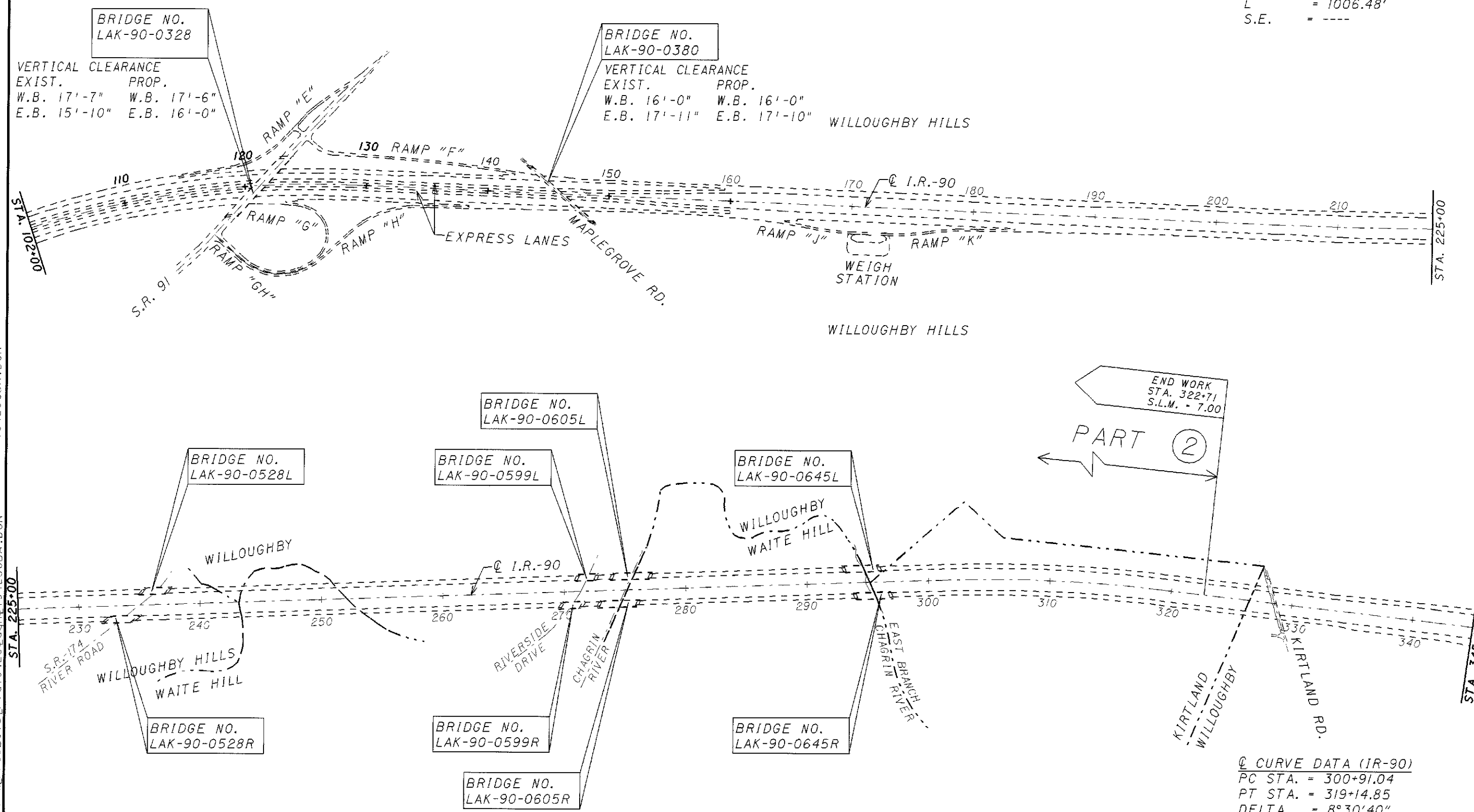

PLOT SUBMITTED: 05-FEB-1999 13:08
 19423GBA.DGN
 19423GBA.DGN
 PLOTTED BY: jarmoyse
 PLOTTED DATE: 01-FEB-1999 13:08



BRIDGE NO. LAK-90-0328
 VERTICAL CLEARANCE
 EXIST. PROP.
 W.B. 17'-7" W.B. 17'-6"
 E.B. 15'-10" E.B. 16'-0"

BRIDGE NO. LAK-90-0380
 VERTICAL CLEARANCE
 EXIST. PROP.
 W.B. 16'-0" W.B. 16'-0"
 E.B. 17'-11" E.B. 17'-10"

BRIDGE NO. LAK-90-0605L

BRIDGE NO. LAK-90-0599L

BRIDGE NO. LAK-90-0645L

BRIDGE NO. LAK-90-0528L

BRIDGE NO. LAK-90-0528R

BRIDGE NO. LAK-90-0599R

BRIDGE NO. LAK-90-0645R

BRIDGE NO. LAK-90-0605R

END WORK
 STA. 322+71
 S.L.M. = 7.00
 PART ②

@ CURVE DATA (IR-90)
 PC STA. = 300+91.04
 PT STA. = 319+14.85
 DELTA = 8°30'40"
 D = 0°28'00"
 R = 12,277.67'
 L = 1823.81'
 S.E. = ----

SCHEMATIC PLAN

LAK-090/271-01.88/00.00