

- TBM**
IP. MON. BOX ©
© ROCKEFELLER DRIVE AND
MILLER AVENUE
STA. 14+77.44
ELEV. 831.67
- TBM**
"M" MATHEWS
HYD. © STA. 9+86.72 ± (LT.)
ELEV. 833.61
- TBM**
"M" MATHEWS
HYD. IN FRONT
HOUSE # 2762 ROCKEFELLER
DRIVE
ELEV. 833.10
- TBM**
INVERT SANITARY MANHOLE
STA. 14+83.60
ELEV. 821.84

- NOTES:**
- EARTHWORK LIMITS SHOWN ARE APPROXIMATE. ACTUAL SLOPES SHALL CONFORM TO PLAN CROSS-SECTIONS.

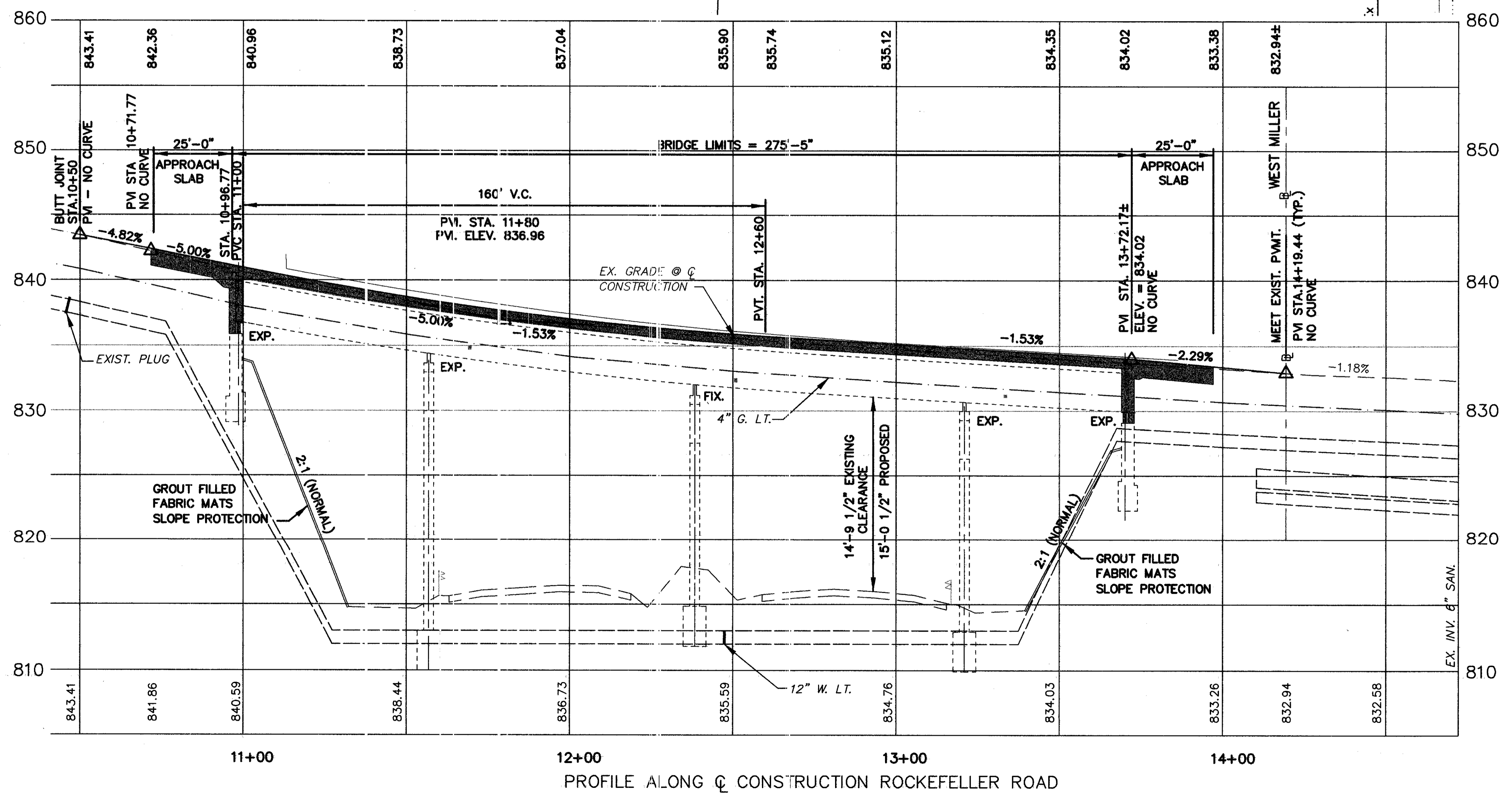

TRAFFIC DATA	
CURRENT ADT (2003)	= 4120
DESIGN ADT (2023)	= 4630
DESIGN ADTT (2023)	= 186
EXISTING STRUCTURE	
TYPE: CONTINUOUS STEEL BEAMS WITH REINFORCED CONCRETE DECK AND SUBSTRUCTURE	
SPANS: 57'-6"(±), 82'-0"(±), 82'-0"(±), 49'-6"(±)	
C/C BEARINGS	
ROADWAY: 24'-0"(±) F/F CURB PLUS 2'-4"-8" SIDEWALKS	
LOADING: C.F. = 130 (57)	
ALIGNMENT: TANGENT	
SKEW: 2' 48" R.F.± (PLAN)	
3' 10" R.F.± (OBSERVED AT ABUT. BACKWALLS)	
WEARING SURFACE: 3/4" MONOLITHIC CONCRETE AND 1 1/4"± CONCRETE OVERLAY	
APPROACH SLAB: 25' (±) (AS-1-54 MODIFIED)	
STRUCTURE FILE NO. 4303458	
PROPOSED STRUCTURE	
PROPOSED WORK: NEW COMPOSITE REINFORCED CONCRETE DECK	
TYPE: CONTINUOUS COMPOSITE INTERIOR STEEL BEAMS, CONTINUOUS NON-COMPOSITE EXTERIOR STEEL BEAMS, WITH REINFORCED CONCRETE DECK, SEMI-INTEGRAL WITH EXISTING CONCRETE ABUTMENTS AND CONCRETE PIERS.	
SPANS: 57'-6"(±), 82'-0"(±), 82'-0"(±), 49'-6"(±)	
C/C BEARINGS	
ROADWAY: 24'-0" F/F CURB PLUS 2'-5'-0" SIDEWALKS	
LOADING: SUPERSTRUCTURE: HS 20-44 (CASE II) AND THE ALTERNATE MILITARY LOADING	
SUBSTRUCTURE: C.F.=130 (57)	
ALIGNMENT: TANGENT	
SKEW: 3' 10" R.F.	
WEARING SURFACE: 1" MONOLITHIC CONCRETE	
FUTURE WEARING SURFACE: NO PROVISION	
APPROACH SLAB: 25' LONG (AS-1-81)	
CROWN: 3/16" / FT.	
LATITUDE : N 41° 35' 30" ; LONGITUDE : W 81° 27' 30"	

Michael Benza & Associates, Inc.
Consulting Engineers and Surveyors

DATE: 12/31/01
REVIEWED: JNS
DRAWN: TEN 2
DESIGNED: TEN
LAKE COUNTY
STA. 10+96.67 TO
STA. 13+72.17

SITE PLAN
LAK - 90 - 0171
ROCKEFELLER RD. OVER I-90

LAK - 90 - 1.71

1 / 13

17
29