

SEALING AND PAINTING OPERATIONS

ITEM SPECIAL - SEALING OF CONCRETE SURFACES (EPOXY URETHANE)

ITEM SPECIAL - URETHANE TOP COAT SEALER

REFERENCE SHALL BE MADE TO THE FOLLOWING PROPOSAL
NOTE: "SEALING OF CONCRETE SURFACES".

THE COLOR OF THE URETHANE TOP COAT UNDER BOTH ITEMS
SHALL BE FEDERAL COLOR STANDARD NO. FS-595A-25630
(BLUE-SEMIGLOSS)

THE FOLLOWING WORK SHALL BE PERFORMED ON THE FOLLOWING PARTS:

SUBSTRUCTURE:

PART 1

SEAL THE ABUTMENTS, WINGWALLS, BACKWALLS AND
BRIDGE SEATS. DO NOT SEAL THE PIERS AND PIER
CAPS. THEY WILL BE SEALED UNDER A DIFFERENT PROJECT.

PARTS 2-11

SEAL ALL EXPOSED SUBSTRUCTURE COMPONENTS INCLUDING
ABUTMENTS, WINGWALLS, PIERS, PIER CAPS, BACKWALLS AND
BRIDGE SEATS WITH EPOXY URETHANE. ALL EXPOSED SUB-
STRUCTURE SURFACES WHICH ALREADY HAVE AN EXISTING
EPOXY-URETHANE SEALER SHALL BE SEALED WITH A URETHANE TOP COAT.

SUPERSTRUCTURE:

PARTS 1-11

SEAL SUPERSTRUCTURE AS PER DETAIL SHOWN BELOW. ALL
EXPOSED SUPERSTRUCTURE SURFACES WHICH ALREADY HAVE
AN EXISTING EPOXY-URETHANE SEALER SHALL BE SEALED
WITH A URETHANE TOP COAT.

LIMITS OF SEALING CONCRETE PARAPETS
WITH EPOXY-URETHANE.

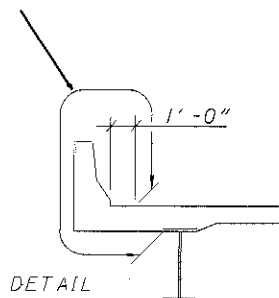

ITEM 885- FIELD PAINTING OF EXISTING STEEL, SYSTEM OZEU

- A. PAINT SYSTEM: SUPPLEMENTAL SPECIFICATION 885 FIELD PAINTING OF EXISTING STEEL, SYSTEM OZEU SHALL BE USED TO COAT THE STRUCTURES IN THIS PROJECT.
- B. COLOR OF FINISH COAT: THE FINISH COAT SHALL MATCH FEDERAL COLOR STANDARD NO. FS-595A-15180 (BLUE-GLOSS)

ITEM 885 FIELD PAINTING OF EXISTING STEEL UTILITY SUPPORTS, SYSTEM OZEU.

- A. PAINT SYSTEM: SUPPLEMENTAL SPECIFICATION 885 FIELD PAINTING OF EXISTING STEEL, SYSTEM OZEU SHALL BE USED TO COAT THE UTILITY SUPPORTS IN THIS PROJECT.
- B. COLOR OF FINISH COAT: THE FINISH COAT SHALL MATCH FEDERAL COLOR STANDARD NO. FS-595A-15180 (BLUE-GLOSS)
- C. STEEL UTILITY SUPPORTS SHALL BE PAINTED. UTILITY LINES SHALL NOT BE PAINTED.

ORIGINAL CONSTRUCTION DRAWING

THE ORIGINAL CONSTRUCTION DRAWINGS FOR THESE STRUCTURES ARE AVAILABLE FOR VIEWING AT:

ODOT, DISTRICT 12
5500 TRANSPORTATION BOULEVARD
GARFIELD HEIGHTS, OHIO
(216) 581-2100

ITEM SPECIAL - CELLULAR PHONE:

THE CONTRACTOR SHALL PROVIDE TWO (2) CELLULAR PHONES FOR USE BY ODOT ENGINEERS/SUPERVISORS/INSPECTORS.

PAYMENT FOR ALL MATERIAL, LABOR AND EQUIPMENT, INSTALLATION AND MAINTENANCE SHALL BE MADE AT THE CONTRACT BID PRICE FOR ITEM SPECIAL - CELLULAR PHONE.

CONVERSION OF METRIC STANDARD DRAWINGS

THE METRIC STANDARD DRAWINGS REFERENCED IN THIS PLAN SHALL BE CONVERTED TO ENGLISH UNITS USING THE SI (METRIC) TO ENGLISH CONVERSION FACTORS PROVIDED IN SECTION 109.011 OF THE CMS. THE APPENDIX OF ASTM E 380 SHALL BE UTILIZED FOR ANY ADDITIONAL CONVERSION FACTORS REQUIRED. CONVERSIONS SHALL BE APPROXIMATELY PRECISE AND SHALL REFLECT STANDARD INDUSTRY ENGLISH VALUES WHERE SUITABLE.

I:\PROJECTS\PID18746\18746.dgn 24-MAY-2000 11:00AM jgrmovse

<p>GENERAL NOTES</p>	<p>LAK-90-00.80/ VAR</p>
<p>3</p>	<p>8</p>
<p>CALCULATED</p>	<p>CHECKED</p>