

149 150 151 152 153 154 155 156 157 158 159 160 161 162 163 164 165 166 167 168 169 170 171 172 173 174 175 176 177 178 179 180 181

B.M. 28 Elevation 722.29
Spike in root chestnut
south side of road
Sta 150+30

B.M. 29 Elevation 707.15
Spike in root chestnut
south side of Road
Sta 155+50

B.M. 30 Elevation 694.17
Spike in root Oak south
side of road Sta 157+75

B.M. 31 Elevation 682.90
Top of boulder 30' south
of E of road Sta 160+75

B.M. 33 Elevation 643.43
Spike in root Elm east
side of road Sta 167+0

B.M. 34 Elevation 635.28
Knob on SW corner of
S.W. wingwall bridge
Sta 170+0

B.M. 35 Elevation 622.87
Spike in telephonic pole.
Sta 177+90

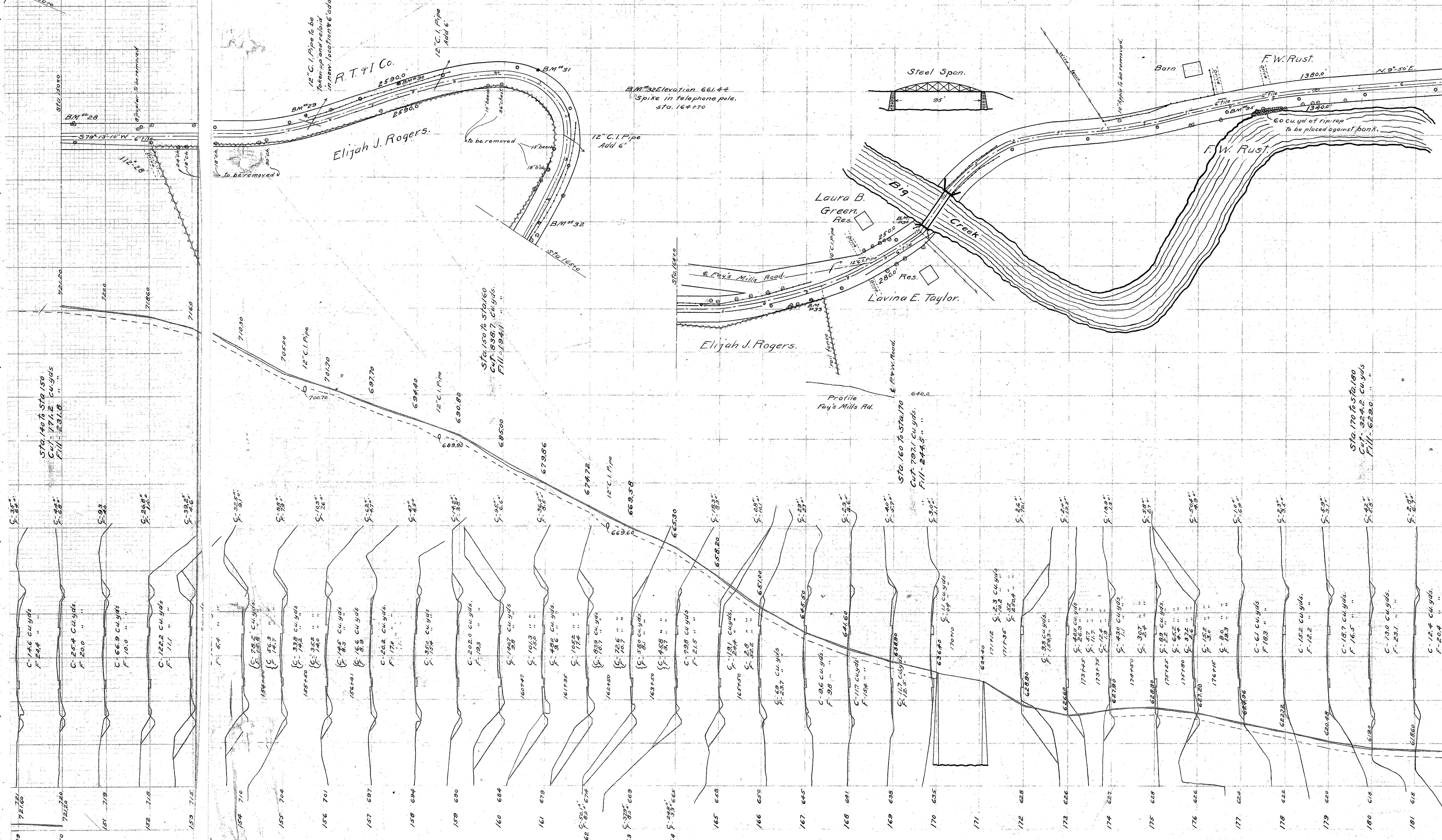

Sta 140 to Sta 150
Cut - 174.2 cu yds
Fill - 231.8 "

Sta 150 to Sta 160
Cut - 887.7 cu yds
Fill - 194.1 "

Profile
Fay's Mills Rd.
Sta 160 to Sta 170
Cut - 797.1 cu yds
Fill - 244.5 "

Sta 170 to Sta 180
Cut - 324.2 cu yds
Fill - 629.0 "

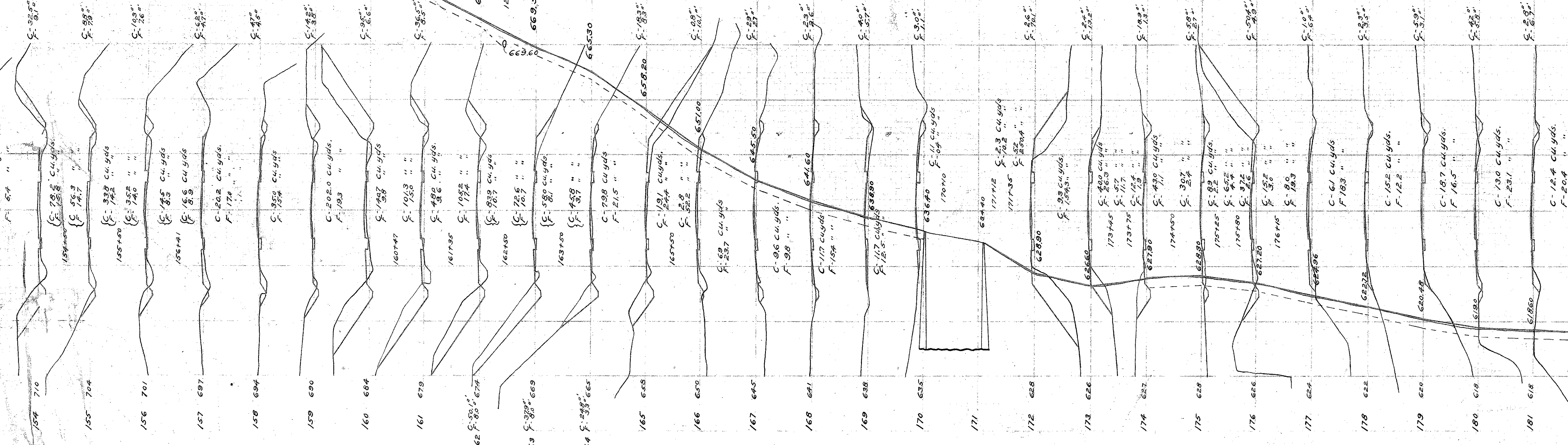
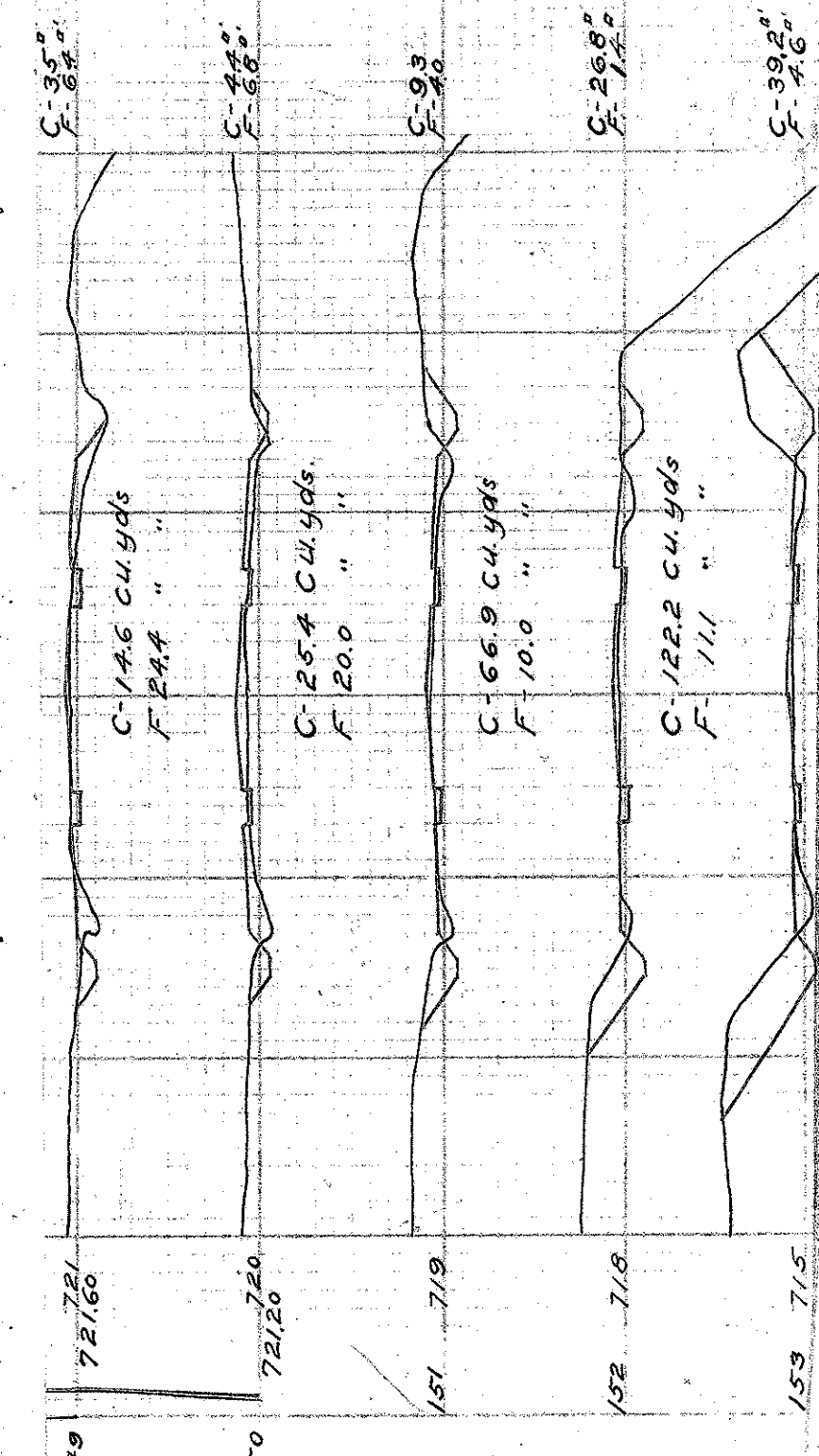

54/6