

SECTION A-A

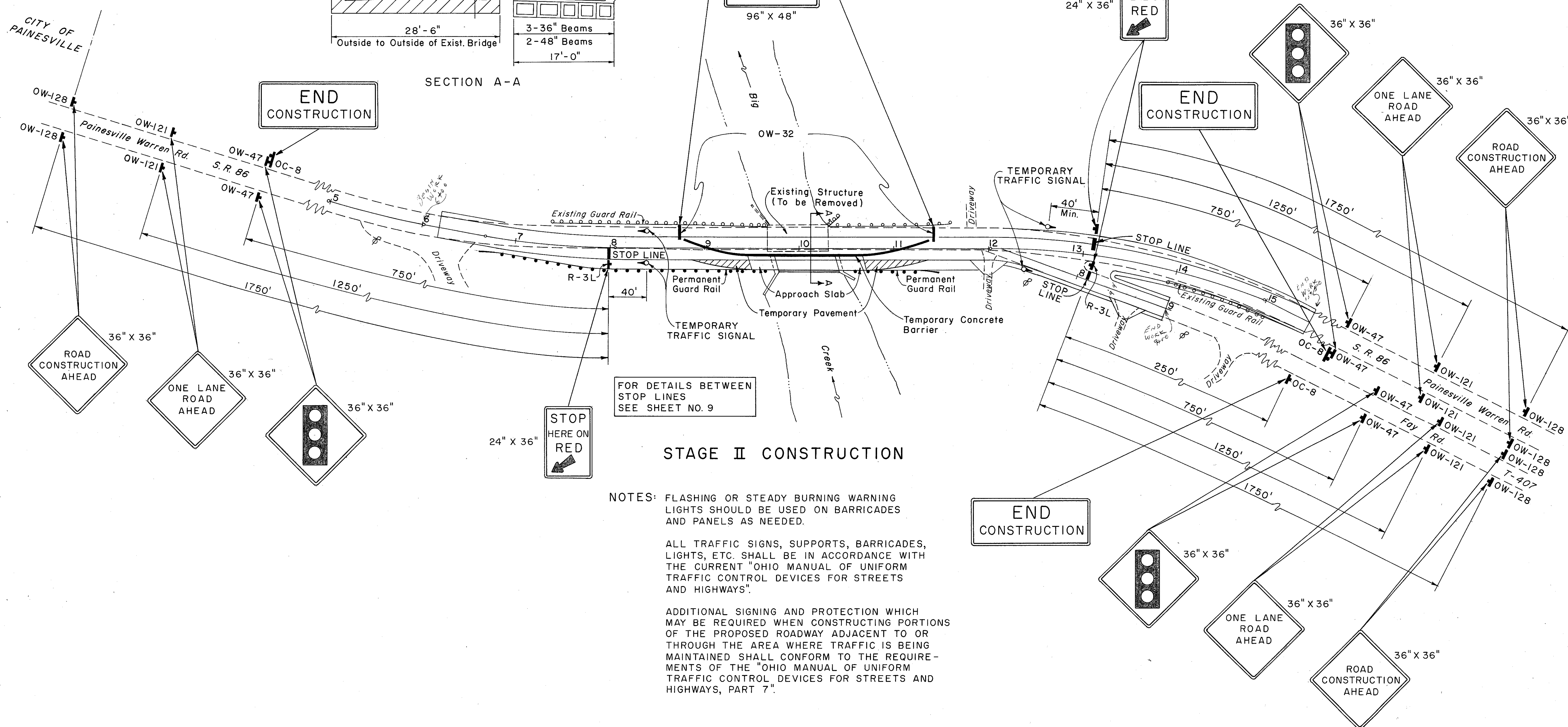

STAGE II CONSTRUCTION

NOTES: FLASHING OR STEADY BURNING WARNING LIGHTS SHOULD BE USED ON BARRICADES AND PANELS AS NEEDED.

ALL TRAFFIC SIGNS, SUPPORTS, BARRICADES, LIGHTS, ETC. SHALL BE IN ACCORDANCE WITH THE CURRENT "OHIO MANUAL OF UNIFORM TRAFFIC CONTROL DEVICES FOR STREETS AND HIGHWAYS".

ADDITIONAL SIGNING AND PROTECTION WHICH MAY BE REQUIRED WHEN CONSTRUCTING PORTIONS OF THE PROPOSED ROADWAY ADJACENT TO OR THROUGH THE AREA WHERE TRAFFIC IS BEING MAINTAINED SHALL CONFORM TO THE REQUIREMENTS OF THE "OHIO MANUAL OF UNIFORM TRAFFIC CONTROL DEVICES FOR STREETS AND HIGHWAYS, PART 7".