

SECTION "A-A"

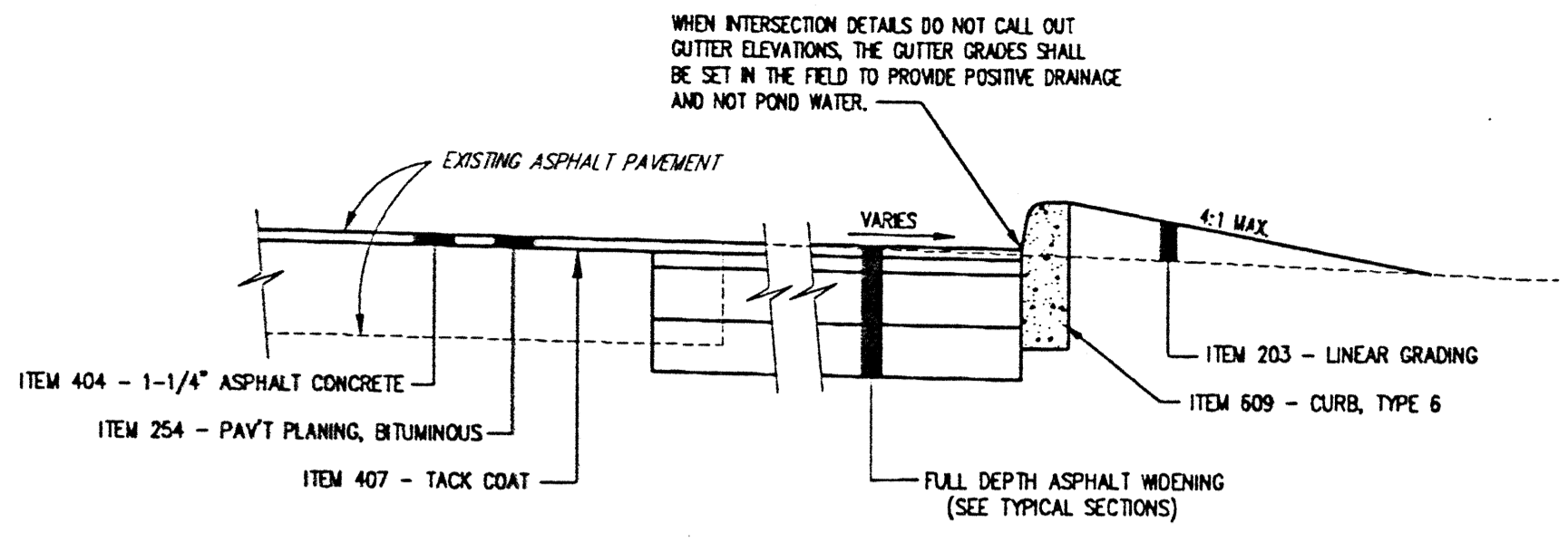

SECTION "B-B"

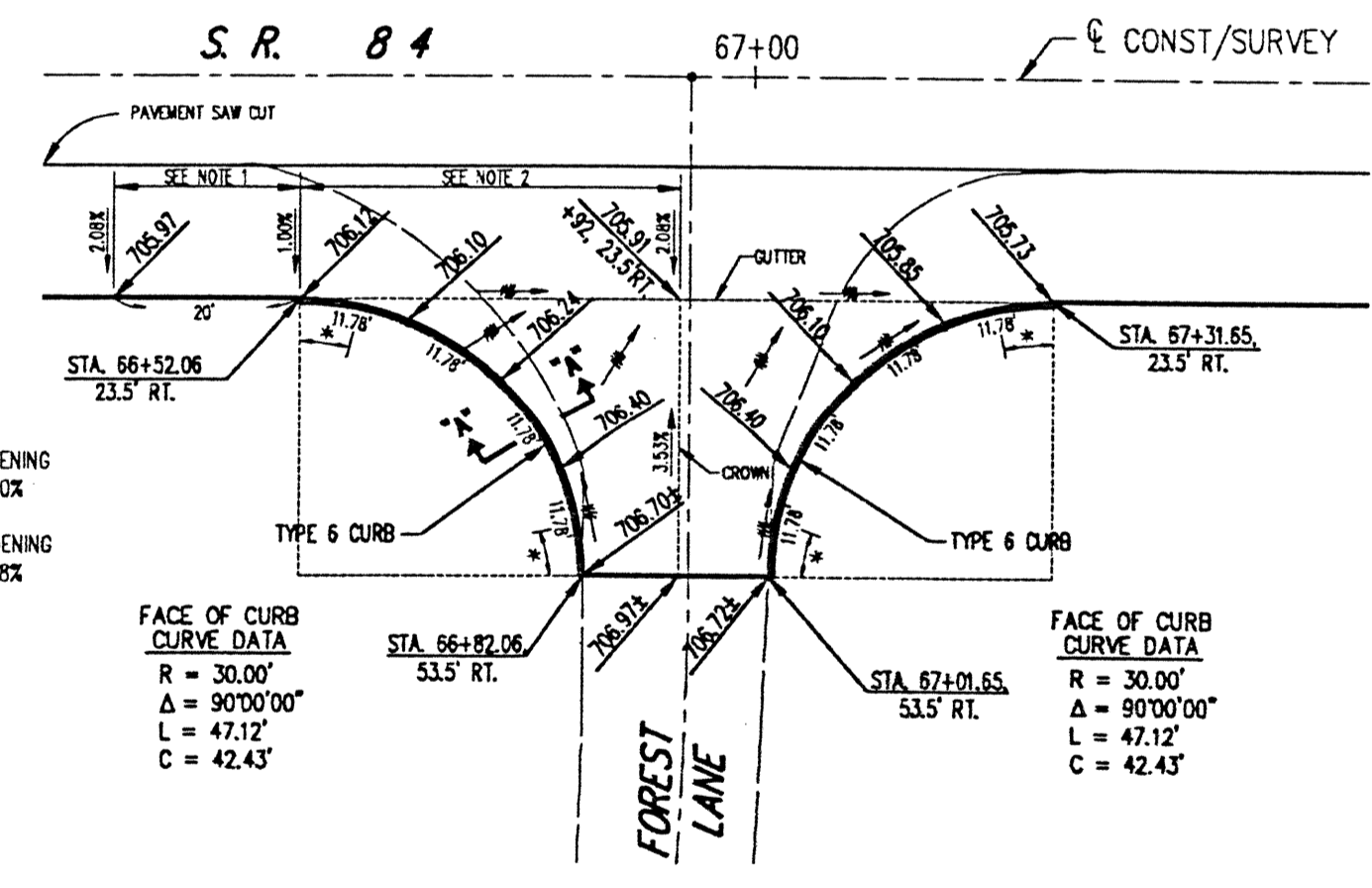
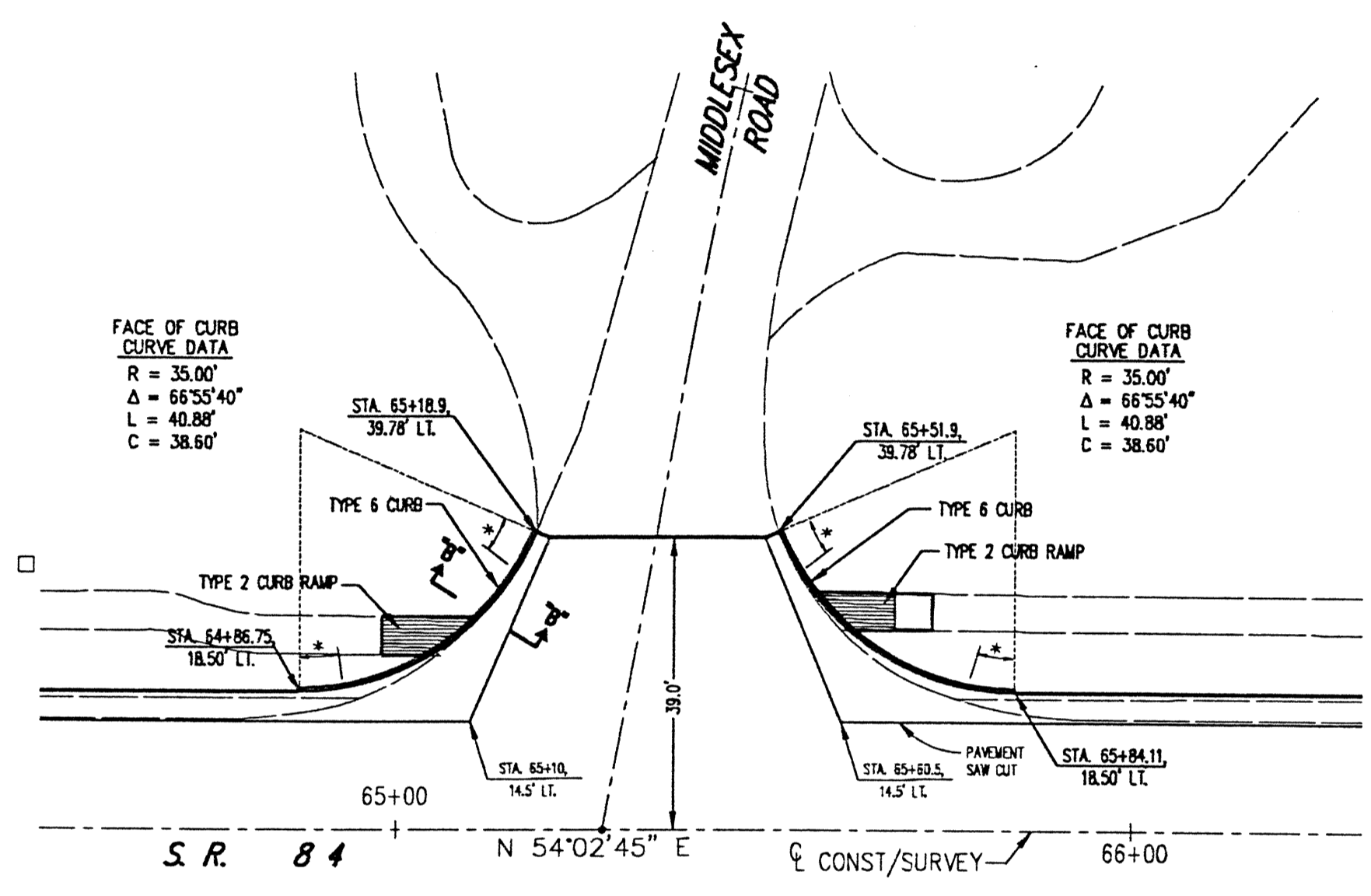
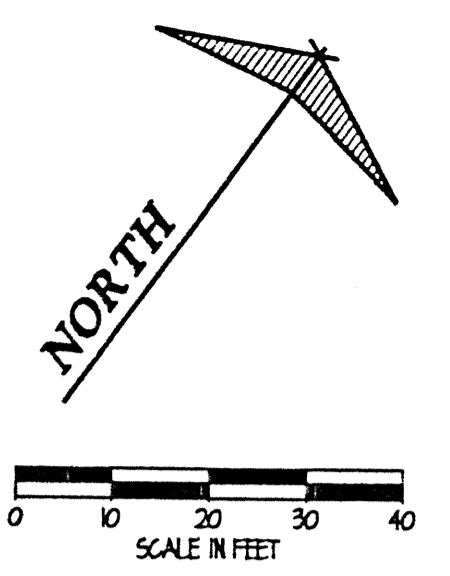

NOTE 1: TRANSITION PAVEMENT WIDENING
GROSS-SLOPE FROM 2.08% TO 1.00%

NOTE 2: TRANSITION PAVEMENT WIDENING
GROSS-SLOPE FROM 1.00% TO 2.08%

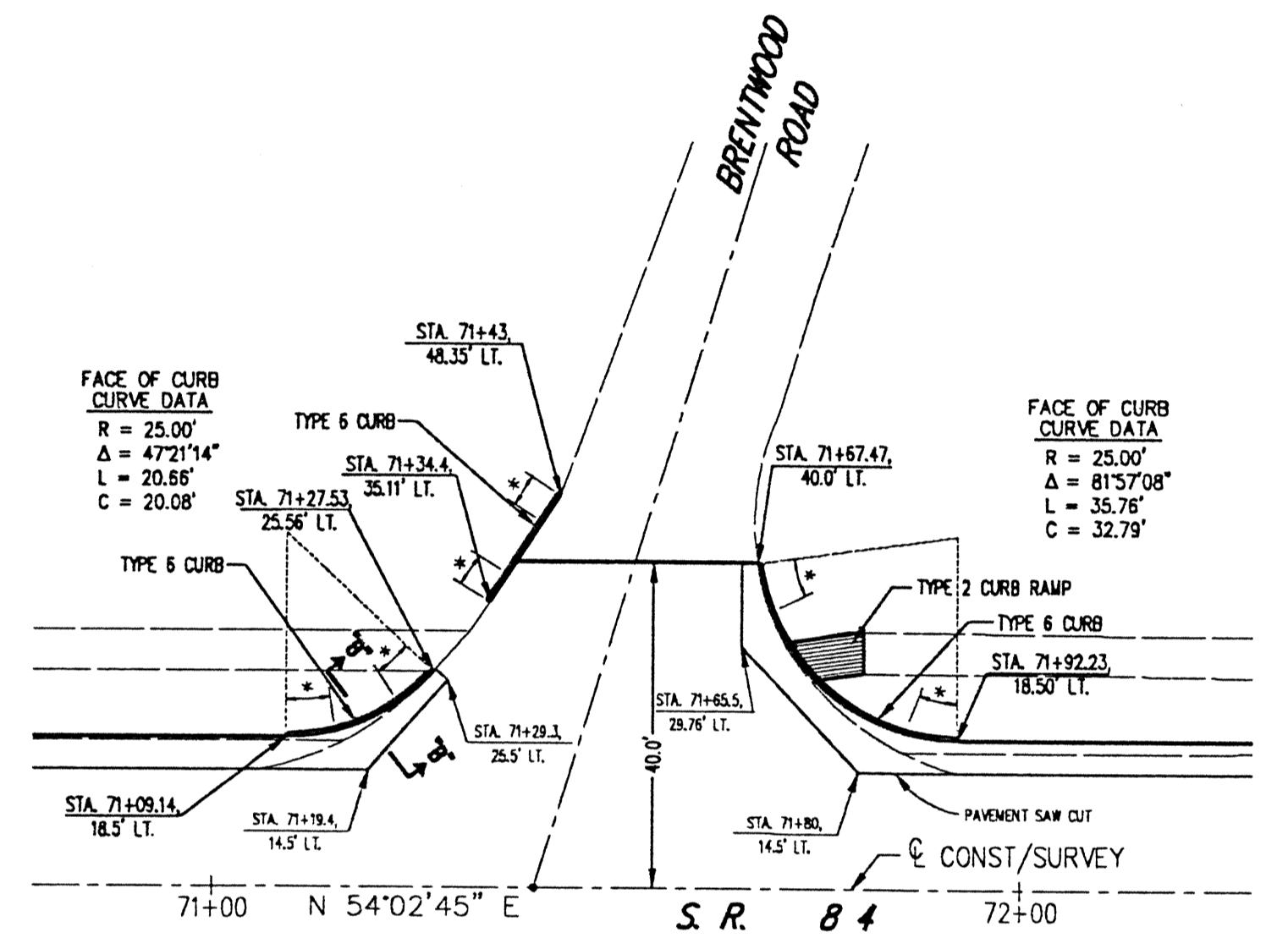

* NOTE: TRANSITION CURB HEIGHT
FROM 6" TO 0" IN 6'-0".

NOTE: ALL DIMENSIONS AND ELEVATIONS ARE TO
THE FACE/GUTTER OF PROPOSED CURB,
UNLESS OTHERWISE INDICATED.

H:\2000\00123\DWG\00123503.DWG - PLOT SCALE = 1:20

REV. NO.	DESCRIPTION	DATE	BY	CHK'D.

STATE ROUTE 84
INTERIM WIDENING & RESURFACING
IMPROVEMENTS
CITY OF MENTOR, LAKE COUNTY, OHIO

DATE: AUGUST, 2000
DRAWN BY: J.J.C.
CHECKED BY: C.C.H.
APPROVED BY: C.C.H.
F.B. No. PG.

MISCELLANEOUS
INTERSECTION DETAILS

SCALE	
HOR.	1" = 20'
VERT.	—
CONTRACT No.	
00123	
SHEET NO.	OF
50	74