

**CULVERT DATA**

Type: Std. sideroad V.S.P. culvert and std. V.S.P. culvert Dr. #300  
 Size: 12" x 54' sideroad & 12" x 56'  
 Work Req: Build 12" x 54' std. sideroad V.P. (enc.) culvert 20' to R of & 1 hr. and build 12" x 56' std. V.P. (enc.) culvert with l.B. on R & hw. on L  
 Drawn by Cumings & Plummer Checked L.A. Breen  
 Date 1/19/28 Date 2-7-28 Div'n. Engr.

**EST. QUANTITIES**

Exc. 25.0 cu.yds. = 11 + 14  
 Conc. 1-5 1/2 2.3 cu.yds. = 1.3 + 1.0  
 Conc. 1-8 11.52 cu.yds. = 5.65 + 5.87  
 12" V.S.P. 110. lin. ft. = 54 + 56  
 Reinf. steel 66 lbs. = 33 + 33  
 Inlet basins comp. 1  
 Sta. 101+02 - 101+56 & 101+75

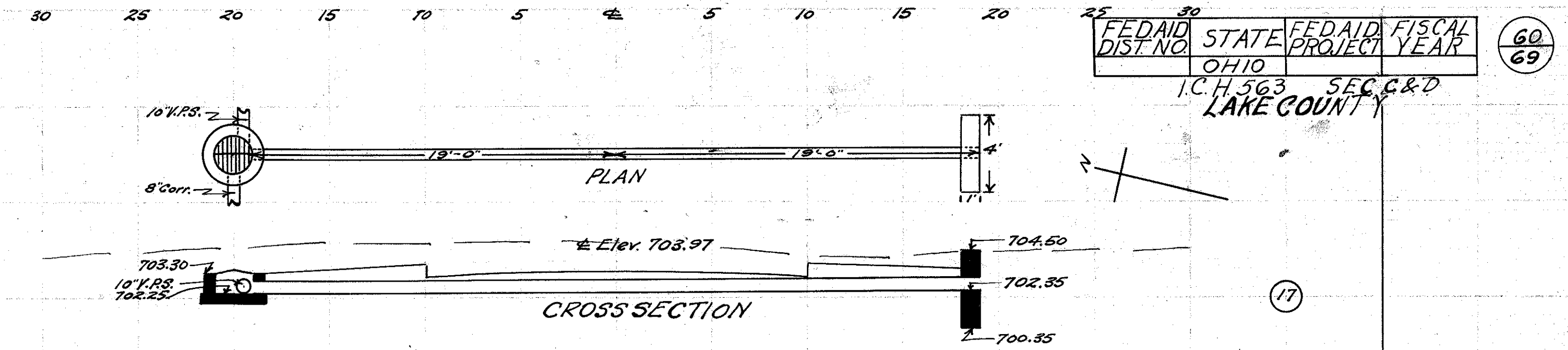

**CULVERT DATA**

Type: Std. corr. iron pipe culvert Dr. #300  
 Size: 8" x 38'  
 Work Req: Build 8" x 38' std. corr. iron pipe culvert l.B. on L and hw. on R  
 Drawn by Cumings & Plummer Checked L.A. Breen  
 Date 1/19/28 Date 2-7-28 Div'n. Engr.

**EST. QUANTITIES**

Exc. 4 cu.yds.  
 Conc. 1-5 1/2 0.7 cu.yds.  
 Reinf. steel 33 lbs.  
 8" corr. iron pipe 38 lin. ft.  
 Inlet basins comp. 1  
 Sta. 155+25

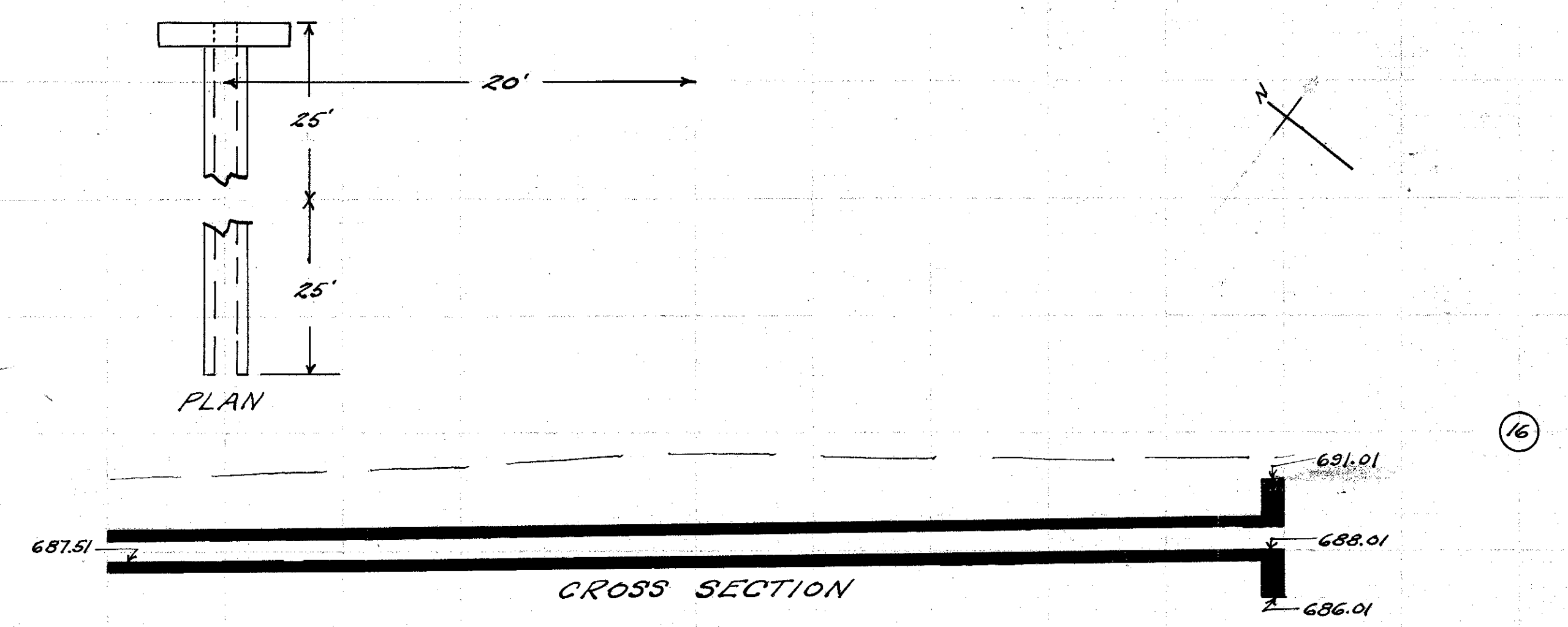

**CULVERT DATA**

Type: std. side road culvert Dr. #300  
 Size: 12" x 50'  
 Work Req: Build 12" x 50' std. sideroad V.P. (enc.) culvert 20' to L of & 1 hr. connect with 12" V.P.S.  
 Drawn by Cumings & Plummer Checked L.A. Breen  
 Date 1/19/28 Date 2-7-28 Div'n. Engr.

**EST. QUANTITIES**

Exc. 16 cu.yds.  
 Conc. 1-8 5.33 cu.yds.  
 Conc. 1-5 1/2 1.0 cu.yds.  
 Reinf. steel 33 lbs.  
 12" V.S.P. 50 lin. ft.  
 Sta. 126+86 to Sta. 127+56

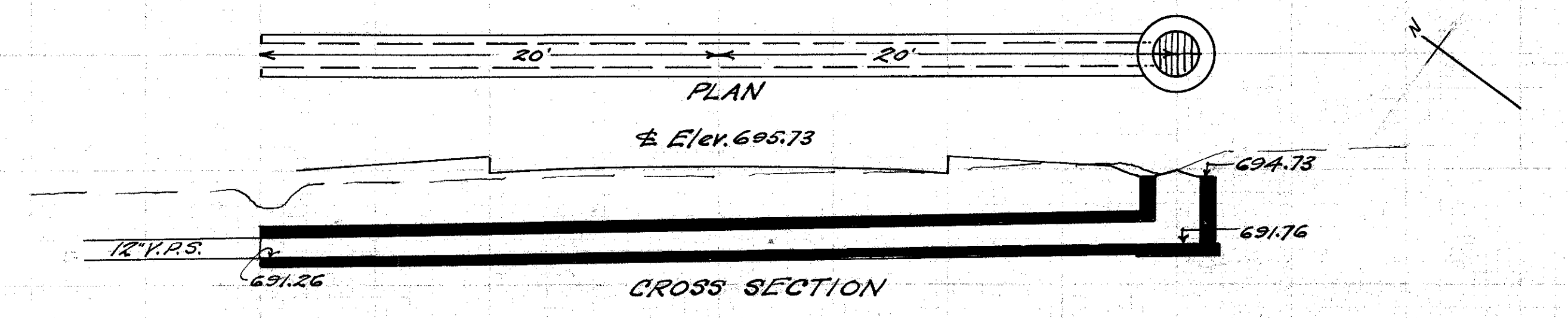

**CULVERT DATA**

Type: Std. V.S.P. culvert Dr. #300  
 Size: 12" x 40'  
 Work Req: Build 12" x 40' std. V.P. (enc.) culvert and l.B. on R. Connect with 12" V.P.S. on L.  
 Drawn by Cumings & Plummer Checked L.A. Breen  
 Date 1/19/28 Date 2-7-28 Div'n. Engr.

**EST. QUANTITIES**

Exc. 10 cu.yds.  
 Conc. 1-8 4.25 cu.yds.  
 12" V.S.P. 40 lin. ft.  
 Inlet basins comp. 1  
 Sta. 106+0