

B.M. SPIKE IN POLE (P.C. 5233), STA. 96+20  
S.R. NO 84 (21L) ELEV. 723.35

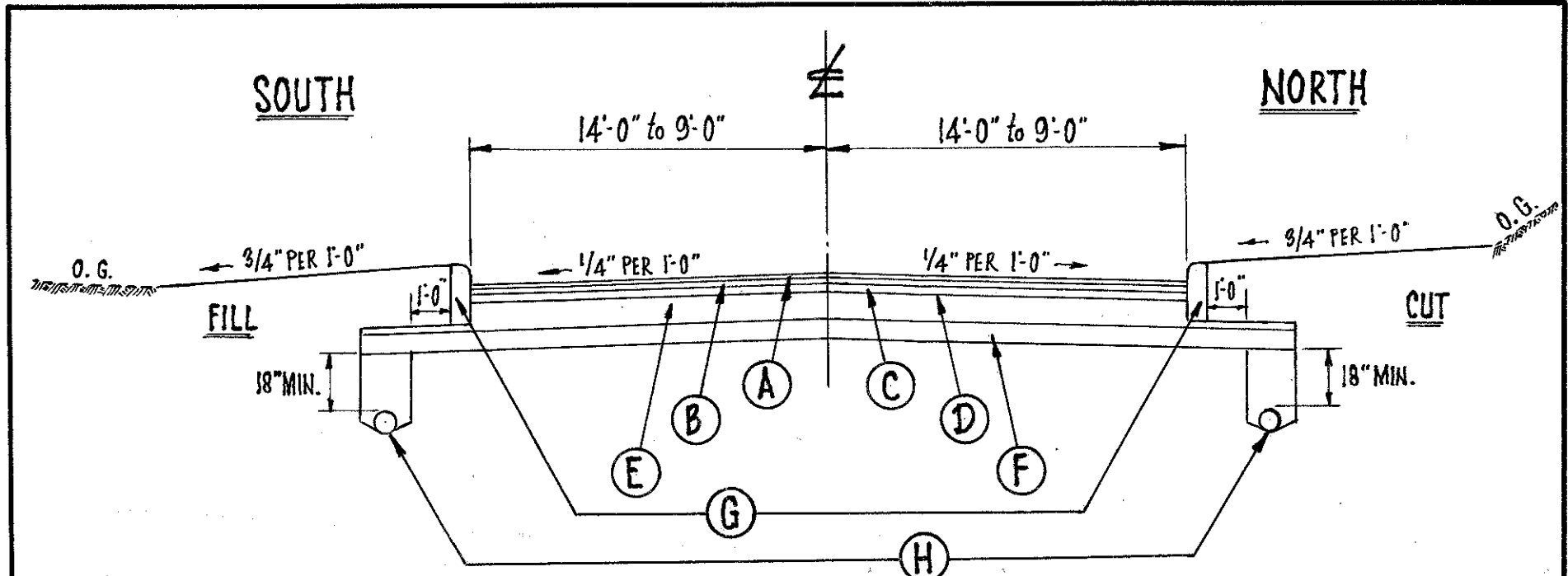
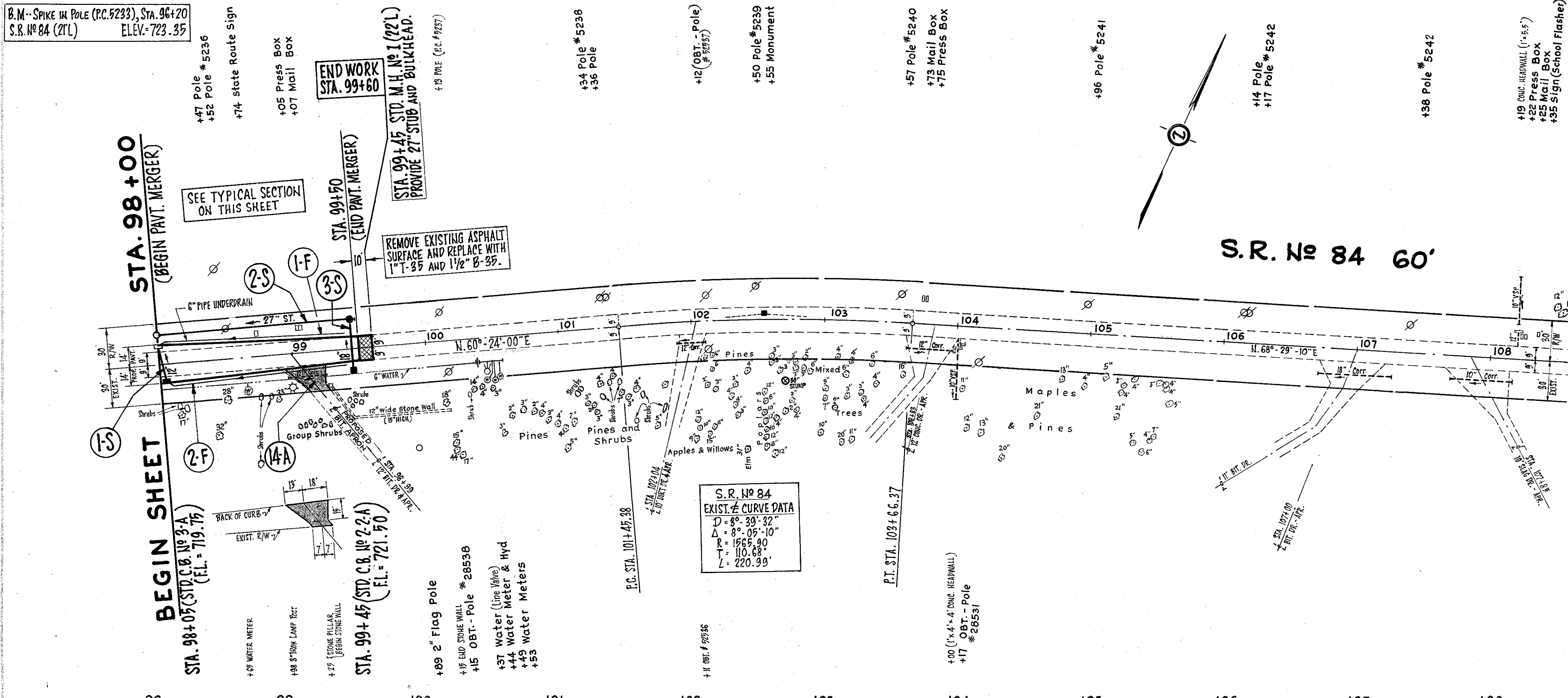

**TYPICAL SECTION S.R. No 84**  
STA. 98+00 to STA. 99+50  
SCALE: 1/4" = 1'-0"

- \* (A) T-35 -- 1" ASPHALTIC CONCRETE SURFACE COURSE TYPE "C" (70-85)
- \* (B) B-35 -- 1 1/2" ASPHALTIC CONCRETE LEVELING COURSE (70-85)
- \* (C) B-35 -- 3" ASPHALTIC CONCRETE BASE COURSE
- (D) T-30 -- BITUMINOUS PRIME COAT @ 0.4 GALS. PER SQ. YD., Sec. M-5.7, RT-2 or RT-3
- (E) B-19 -- 8" AGGREGATE BASE COURSE
- (F) I-22 -- 6" SUBBASE, GRADING "A" or "B"
- (G) I-12 -- CONCRETE CURB (TYPE 6)
- (H) I-1 -- 6" PIPE UNDERDRAIN, (CLASS I-3)

\* THICKNESSES SHOWN ARE DESIGNED THICKNESSES AS DESCRIBED IN SECTIONS T-35.01 AND B-35.01

**NOTE:** CROSS SECTIONS SHALL GOVERN OVER TYPICAL SECTIONS WHERE VARIABLE CONDITIONS ARE ENCOUNTERED IN SLOPES.

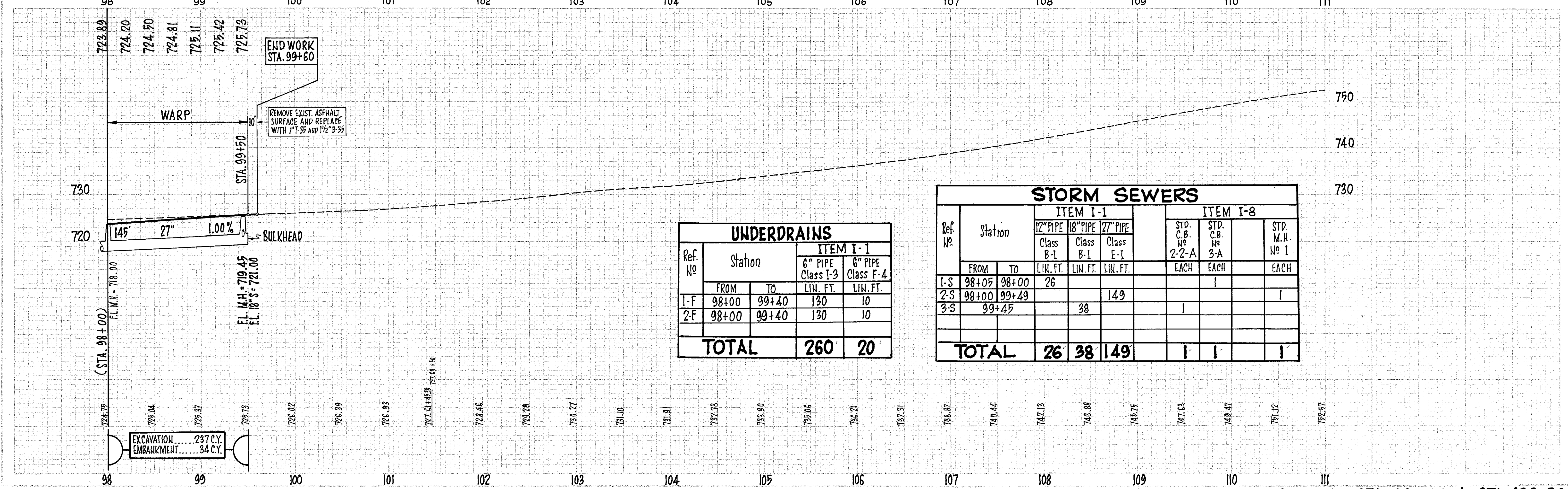

UNDERDRAINS			
Ref. No	Station	ITEM I-1	
		6" PIPE Class I-3	6" PIPE Class F-4
		FROM TO LIN. FT.	FROM TO LIN. FT.
1-S	98+05 98+00	26	
1-F	98+00 99+40	130	10
2-F	98+00 99+40	130	10
<b>TOTAL</b>		<b>260</b>	<b>20'</b>

STORM SEWERS							
Ref. No	Station	ITEM I-1			ITEM I-8		
		12" PIPE Class B-1	18" PIPE Class B-1	27" PIPE Class E-1	STD. C.B. No 2-2-A	STD. C.B. No 3-A	STD. M.H. No 1
		FROM TO LIN. FT.	FROM TO LIN. FT.	FROM TO LIN. FT.	EACH	EACH	EACH
1-S	98+05 98+00	26					
2-S	98+00 99+49			149			
3-S	99+45		38				
<b>TOTAL</b>		<b>26</b>	<b>38</b>	<b>149</b>	<b>1</b>	<b>1</b>	<b>1</b>