

DRIVEWAY SUB-SUMMARY

SHEET NO.	REFERENCE NO.	STATION	SIDE	REPLACEMENT LENGTH			"W" DRIVE WIDTH	TYPICAL DRIVE SECTION	AREA OF DRIVE (BY PLANIMETER)	ITEM						
				CONC.	ASPH.	STONE				EMBANKMENT	EXCAVATION NOT INCLUDING EMBANKMENT CONSTRUCTION	203	301	404	304	452
												4" BITUMINOUS AGGREGATE BASE AC-20	5" BITUMINOUS AGGREGATE BASE AC-20	1" ASPHALT CONCRETE AC-20 (DRIVEWAYS)	8" STABILIZED CRUSHED AGGREGATE	6" PLAIN CEMENT CONCRETE
S.Y.	C.Y.	C.Y.	C.Y.	C.Y.	C.Y.	C.Y.	S.Y.									
P1	523+42	LT.		33'	9'	-	22'	A,D	142.2	-	5.0	4.0	-	1.0	-	107.0
P2	524+22	LT.		7'	21'	-	20'	A,D	87.8	-	10.0	8.0	-	2.0	-	16.0
P1	525+67	RT.		-	32'	-	24'	C	112.9	-	19.0	-	16.0	3.0	-	-
P2	526+37	LT.		-	24'	2'	11'	B,D	46.9	-	10.5	8.3	1.7	-	0.5	-
P3	528+26	RT.		-	51'	-	30'	C	257.8	-	36.0	-	30.0	6.0	-	-
P1	530+05	RT.		-	86'	-	25'	C	396.0	-	66.0	-	55.0	11.0	-	-
LIBERTY STREET																
P1	11+20	LT.		12'	-	10'	12'	A,B	35.3	-	7.0	-	-	-	3.0	22.0
SUB-TOTAL																
TOTAL *																
											20.3	102.7				
											-	154	123	23	4	145

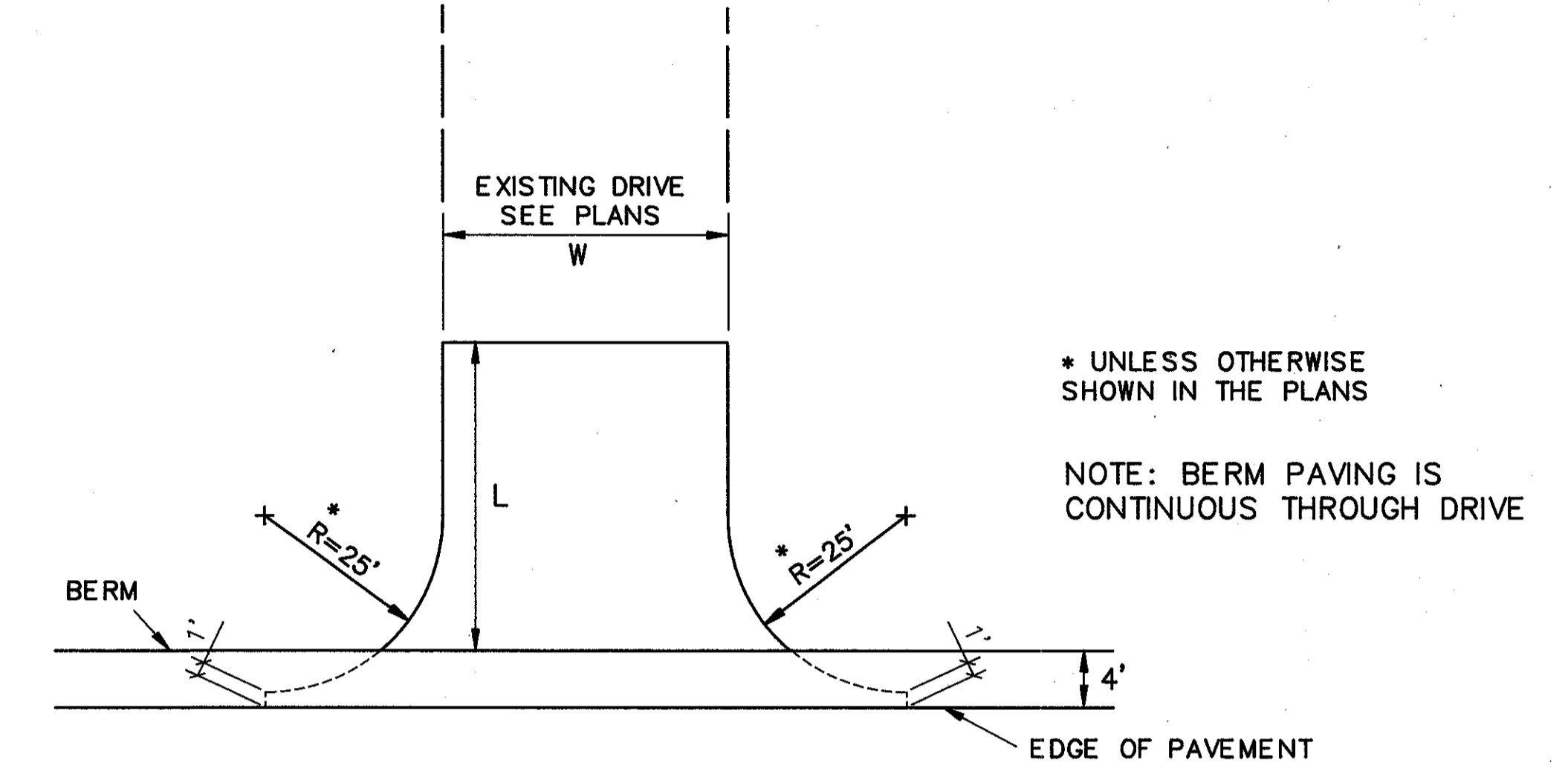

TYPICAL DRIVE DETAIL

* TOTALS HAVE BEEN TRANSFERRED TO THE GENERAL SUMMARY SEE SHEET NO. 11-12

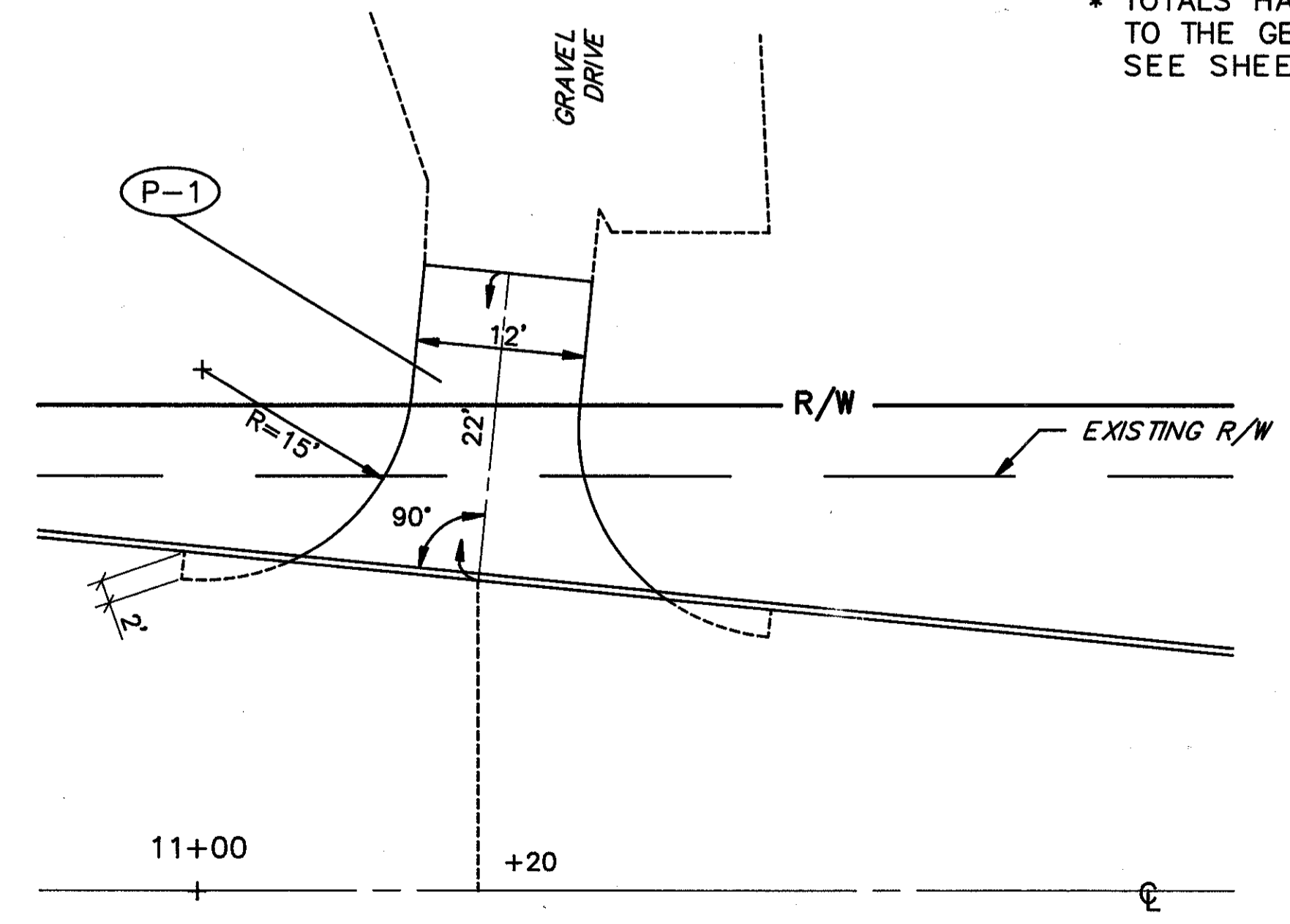

LIBERTY STREET DRIVE DETAILS

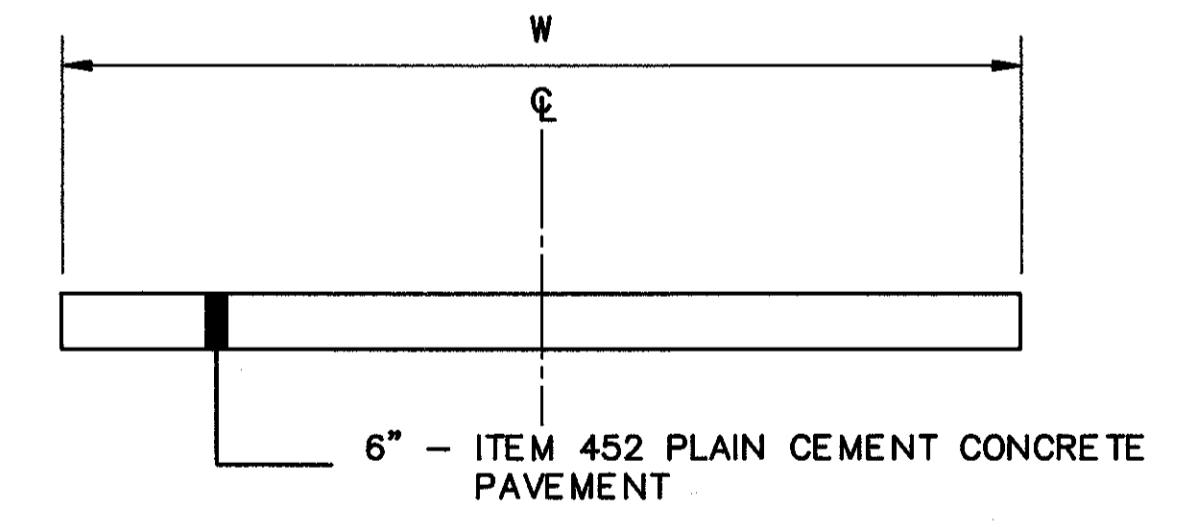

TYPICAL DRIVE SECTION "A"
(RESIDENTIAL)

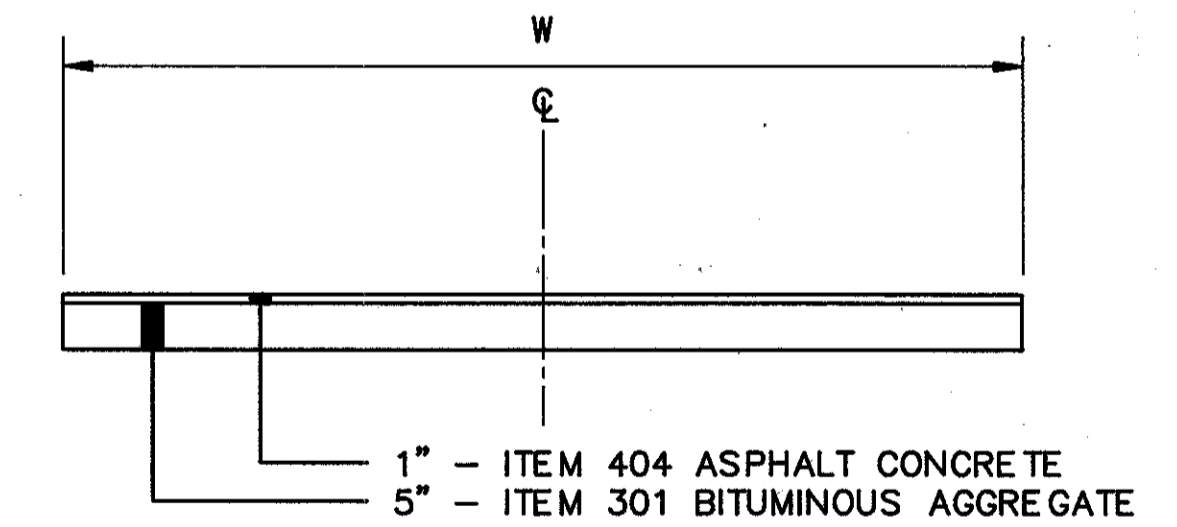

TYPICAL DRIVE SECTION "C"
(COMMERCIAL)

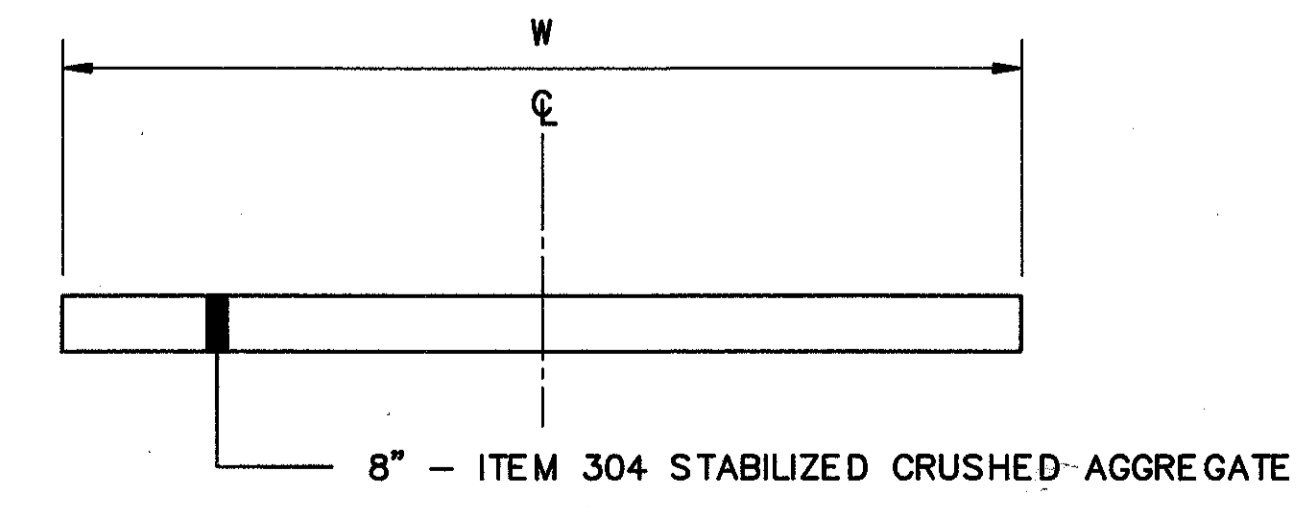

TYPICAL DRIVE SECTION "B"
(RESIDENTIAL)

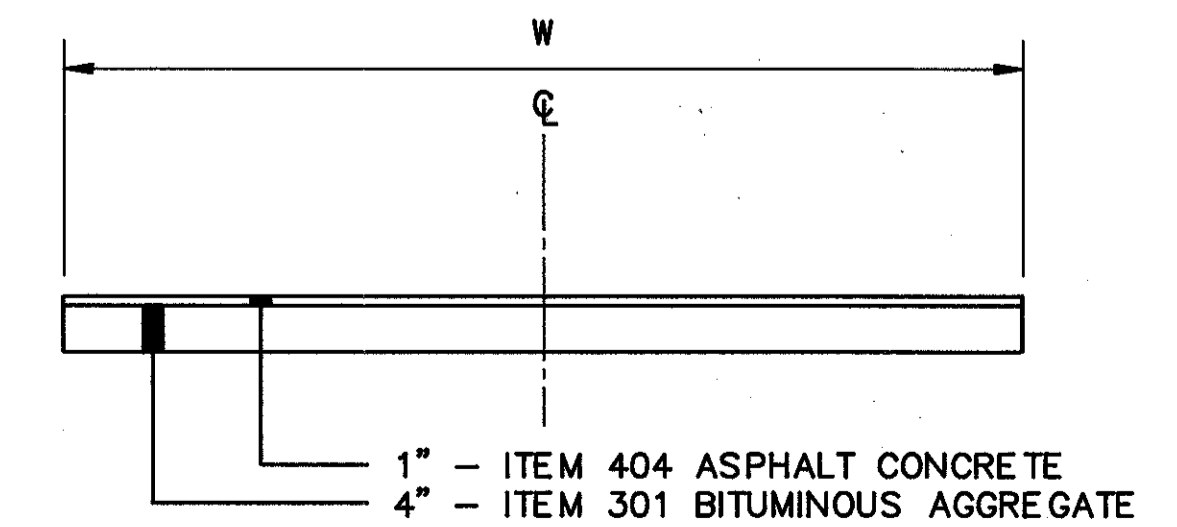

TYPICAL DRIVE SECTION "D"
(RESIDENTIAL)