

674

G-16

STATE OF OHIO

DEPARTMENT OF HIGHWAYS

WICKLIFFE-MADISON ROAD

S.H.(I.C.H.) NO. 563 WICKLIFFE & B.

PET. NO. 6625

LAKE

COUNTY

WILLOUGHBY TWP.

MARCH 1928

FED. RD. DIST. NO.	STATE	FED. AID PROJECT	FISCAL YEAR	1/34
	OHIO			

S.H.(I.C.H.) NO. 563 WICKLIFFE & B. LAKE COUNTY

SR 84

LAK
C-50-471±

The Standard Specifications of the State of Ohio, Department of Highways in force on date of contract will govern this improvement.

I hereby approve these plans and declare that the making of this improvement will require the closing to traffic of the highway and that detours will be provided as shown on the plan and estimates.

CONVENTIONAL SIGNS

State line	_____
County line	_____
Township line	_____
Section line	_____
Property line not fenced	_____
Center line	_____
City or Village line	_____
Fence	_____
Telephone or Telegraph	TTTTTTTT
Stream Railroad	_____
Electric line	_____
Guard Rail	_____
Drain Pipe - new	_____
Drain Pipe - old	_____

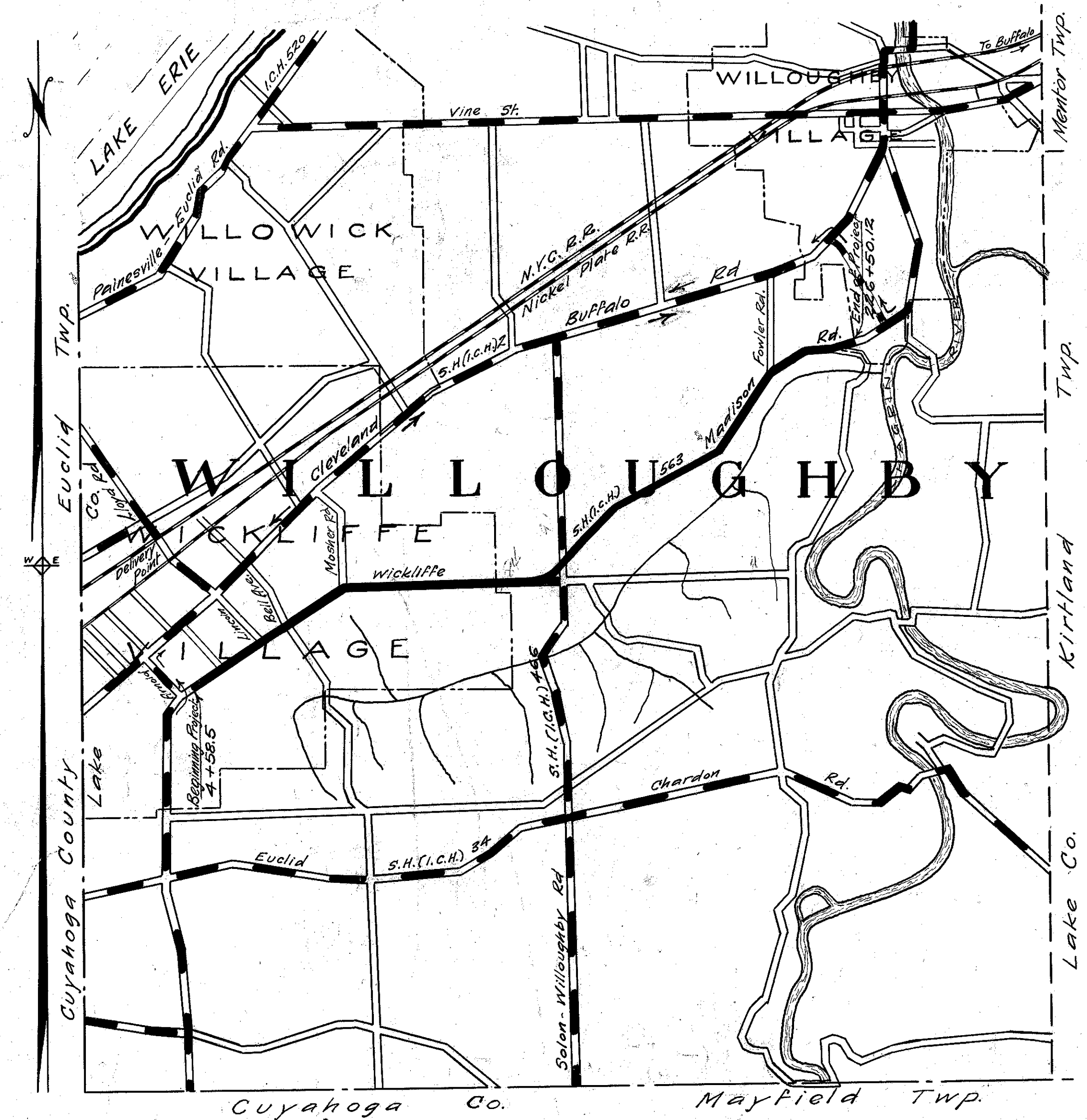

We, the Commissioners of Lake County hereby approve these plans and certify that the right of way 60' wide is available for the construction, maintenance and repair of the above highway.

R.D. Reynolds
Chas. Manchester

Date, _____ County Commissioners

SCALES

Plan	1" = 100'
Profile (Vertical)	1" = 10'
Profile (Horizontal)	1" = 100'
Cross Sections	1" = 5'

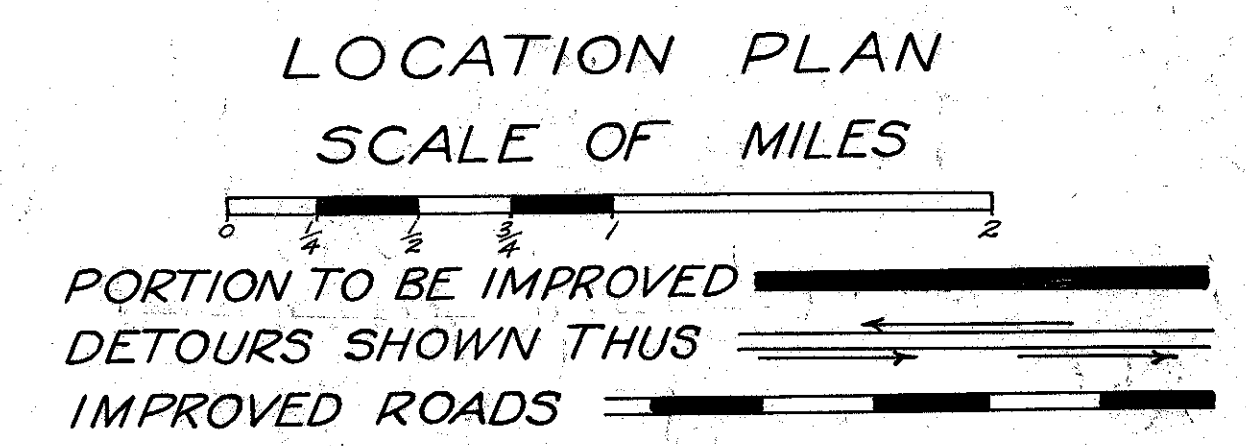

INDEX OF SHEETS
PROJECT TRACINGS

Title Page	p. 1
Typical Cross Section	p. 2
Plans and Profile	p. 3-10
Cross Sections	p. 11-24
Structural Plans	p. 25-32
Special Structure	p. 33
Standard Drawings	p. 33
Summary Sheet	p. 34

Approved: Clyde Hadden
Date, 4-26-28 Resident District Deputy Director

Approved: L. A. Bruen
Date, 4-28-28 Resident Division Deputy Director

Approved: Post. D. Reigman
Date, 5-2-28 Deputy Director Bureau of Construction

Approved: _____
Date, _____ Deputy Director Bureau of Maintenance

Approved: _____
Date, _____ Deputy Director Bureau of Bridges

Approved: Harry Dix
Date, 5-2-28 Assistant Director

Approved: G. F. Schlesinger
Date, 5-2-28 Director of Highways

Recommended For Approval: _____
Date, _____ District Engineer Bureau of Public Roads

Recommended For Approval: _____
Date, _____ Chief Engineer Bureau of Public Roads

Approved: _____
Date, _____ Chief of Bureau

