

# 48" ROADWAY PIPE CULVERT

STA. 20+69.5

SCALE 3/16" = 1'0"

REF.# 1-C SH.# 10

FED. RD. DIVISION	STATE	PROJECT	FISCAL YEAR
2	OHIO		

69  
73

LAK. 84 (043-1.44)  
LAKE COUNTY

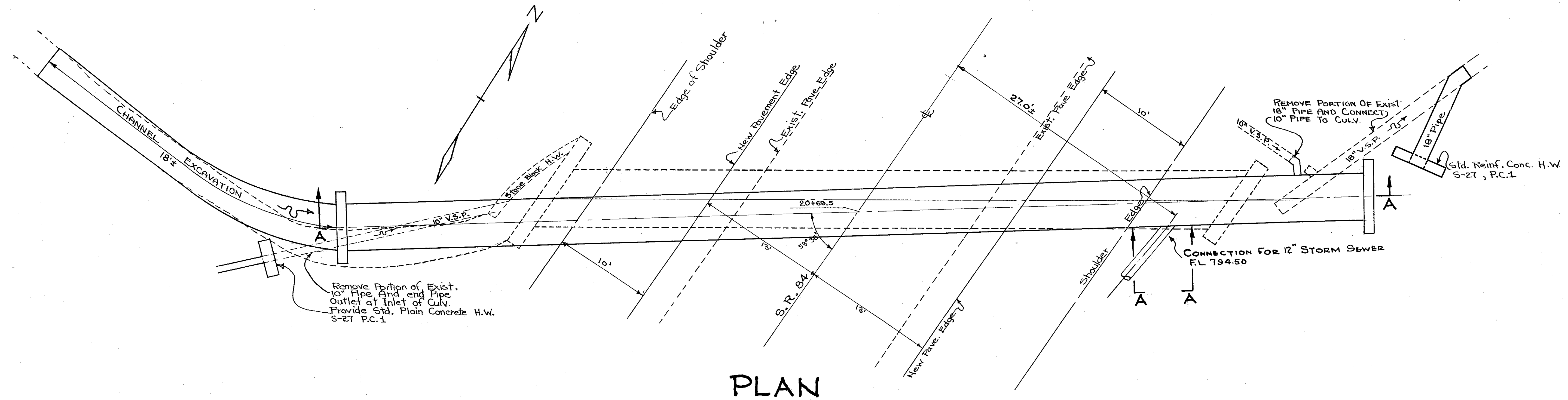

PLAN

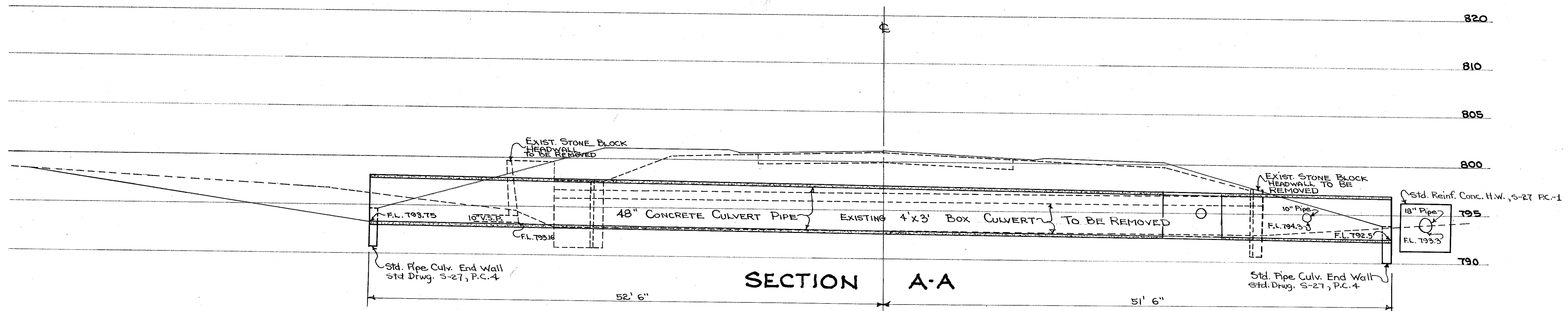

SECTION A-A

NOTE: 10" and 18" EXISTING V.S.P. TO BE REMOVED SHALL BE INCLUDED IN THE COST OF ITEM E-2.

ESTIMATED QUANTITIES	
I-22 4" SUBBASE GRADE "D" or "C"	25 Cu. Yds.
E-2 EXCAVATION FOR STRUCTURES	84 CU. YDS.
E-3 CHANNEL EXCAVATION	10 CU. YDS.
E-8 REMOVAL OF EXISTING PAYEMENT	22 CU. YDS.
S-24 REMOVAL OF EXISTING STRUCTURES	LUM. SUM
I-5 10" PIPE SPECIAL (45° CUT CURVE)	1 EACH
I-5 18" PIPE SPECIAL (45° CUT CURVE)	1 EACH
I-2 10" STORM SEWER, Class "B"	8 LIN. FT.
I-2 18" STORM SEWER, Class "B"	4 LIN. FT.
S-1 CONCRETE FOR STRUCTURES (Class "E")	3.7 CC. YDS.
S-1 CONCRETE FOR STRUCTURES (Class "C")	2.2 CC. YDS.
B-70 8" PORTLAND CEMENT CONCRETE BASE COURSE	22 SQ. YDS.
S-27 48" PIPE FOR ROADWAY CULVERT	100 LIN. FT.
S-4 REINFORCING STEEL	52 LBS.
I-5 48" Pipe Special (48"x12" Wye)	1 EACH