

TYPICAL SECTION

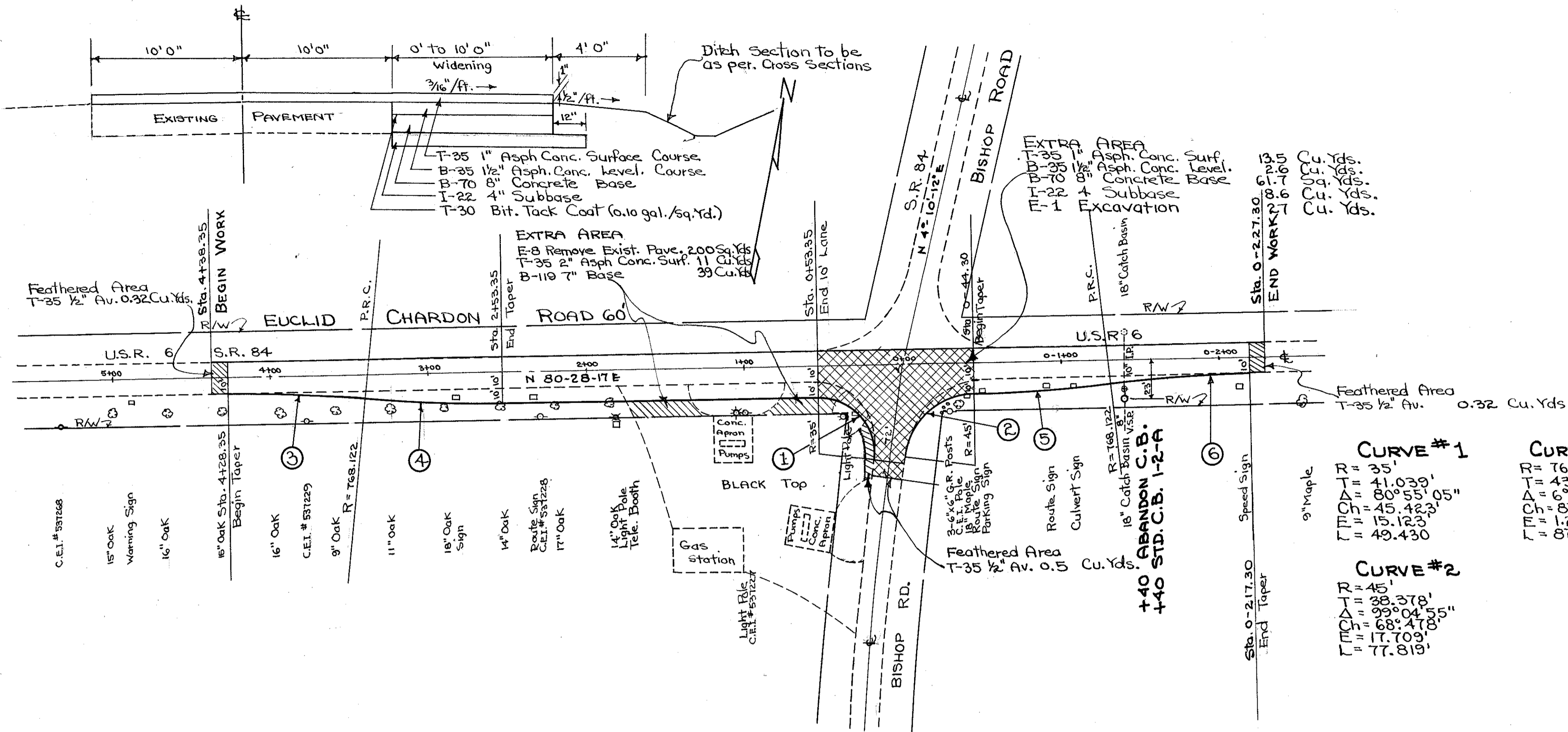

LAK. 84-(0.43-1.44)
LAKE COUNTY

SHEET NO.	DATE	PROJECT	TYPE
2	OHIO		

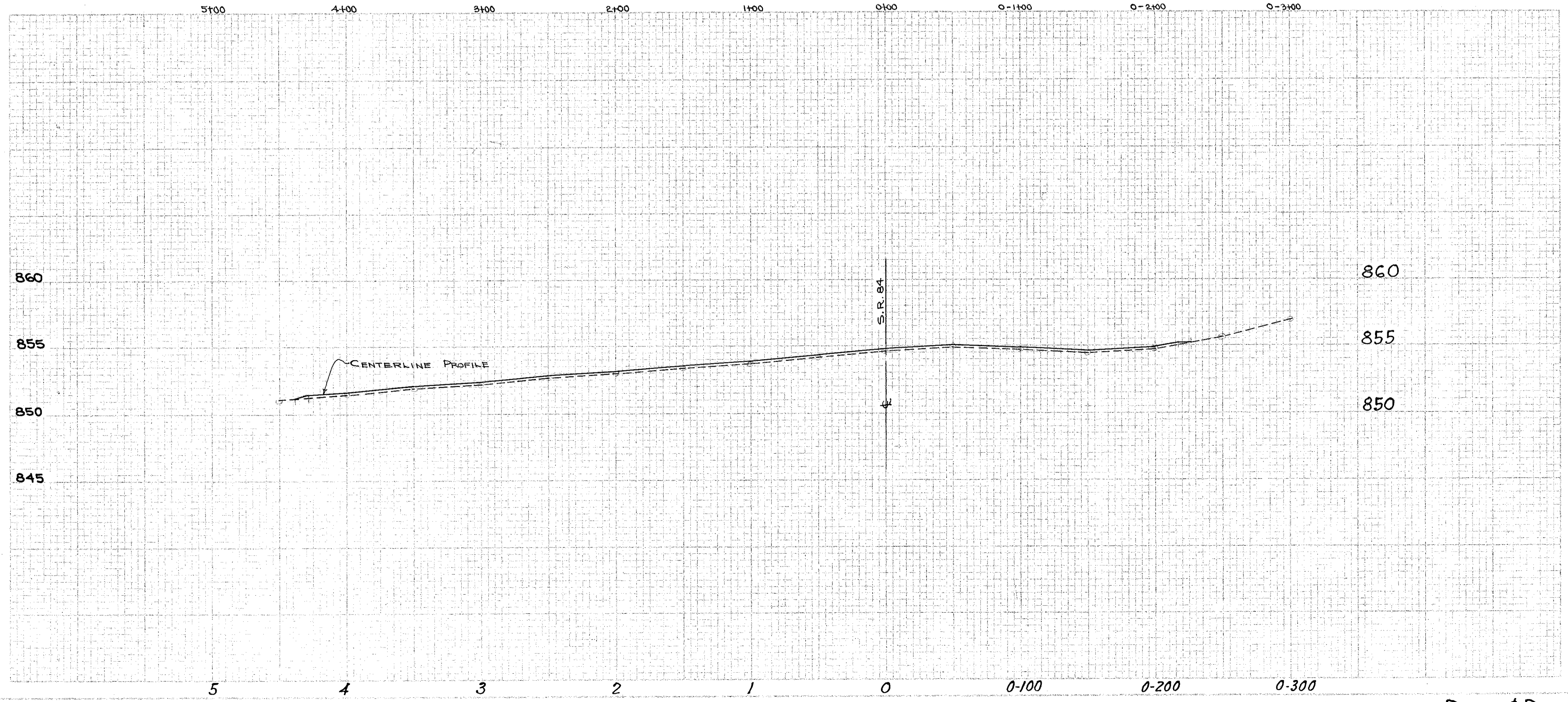

ESTIMATED QUANTITIES

ITEM NO.	STATION TO STATION	QUANTITY	UNIT
T-35	Asph. Conc. Surf. Course	33.9	Cu. Yds.
B-35	1/2" Asph. Conc. Level. Course	6.0	Cu. Yds.
B-70	8" Conc. Base	11.0	Cu. Yds.
I-22	4" Subbase	13.5	Cu. Yds.
B-35	1/2" Asph. Conc. Surf. Course	215.4	Cu. Yds.
B-70	8" Conc. Base	30.7	Cu. Yds.
I-22	4" Subbase	30.7	Cu. Yds.
E-6	Removal of Existing Pavement	2.00	39.0
B-119	7" Conc. Base	39.0	
E-1	Excavation	27	
TOTALS		655	11.6 271.1 39.3 200 39 27

CURVE #1
R = 35'
T = 41.039'
Δ = 80° 55' 05"
Ch = 45.423'
E = 15.123'
L = 49.430'

CURVE #2
R = 45'
T = 38.378'
Δ = 99° 04' 55"
Ch = 68.478'
E = 17.709'
L = 77.819'

CURVES #3,4,5,6
R = 768.122'
T = 43.893'
Δ = 6° 32' 27.54"
Ch = 87.643'
E = 1.253'
L = 87.691'

PLAN & PROFILE CHARDON RD.-S.R. 84 & U.S. 6 STA. 4+38.35 TO STA. 0+227.30