

VINE STREET (STATE ROUTE 640) WIDENING IMPROVEMENTS

CITIES OF WILLOWICK & EASTLAKE, LAKE COUNTY, OHIO

INDEX OF DRAWINGS

TITLE SHEET	1
GENERAL NOTES	2-3
MAINTENANCE OF TRAFFIC NOTES	4
SCHEMATIC PLAN	5
TYPICAL SECTIONS	6-8
PLAN & PROFILES	9-18
INTERSECTION DETAILS	19-20
CROSS-SECTIONS	21-31
DRIVE PROFILES	32-36
DRIVE REPLACEMENT SCHEDULE & DETAILS	37
WATERLINE DETAILS & NOTES	38-39
MISCELLANEOUS DETAILS	40-42
PAVEMENT MARKING & SIGNING PLANS	43-45
SIGNALIZATION PLANS & DETAILS	46-50
ALTERNATE STREETScape PLANS	51-52

JULY, 2000

MEMBERS OF COUNCIL

CITY OF WILLOWICK

RICHARD J. BONDE (President)
ANDREW ALLAN (Ward 1)
JUDY MORAN (Ward 1)
TOM WELLS (Ward 2)
JEFFRY PERPAR (Ward 2)
JOHN O'DONNELL (Ward 3)
RICHARD LUCARELLI (Ward 3)
JANE TUFT (Clerk)

CITY OF EASTLAKE

WILLIAM PHILIPP (President)
ROBERT MAHLER (President Pro Tempore)
LYNN CURTIS
STEVE KOMARJANSKI
ROGER NISSEN
RON PLUMB
BRUNO RAZOV

OFFICIALS

CITY OF WILLOWICK

MAYOR
LAW DIRECTOR
CITY ENGINEER
FINANCE DIRECTOR
CHIEF OF POLICE
FIRE CHIEF
SERVICE DIRECTOR

LORRAINE M. FENDE
JAMES LOIACNO
DAVID HOOPS, P.E.
SHERYL KILLEN
JOHN GERM
HARVEY RUDERSDORF
DONALD FITZGERALD

CITY OF EASTLAKE

MAYOR
LAW DIRECTOR
CITY ENGINEER
RECREATION DIRECTOR
FINANCE DIRECTOR
SERVICE DIRECTOR
SAFETY DIRECTOR
CHIEF BUILDING OFFICIAL

DAN DILIBERTO
THEODORE KLAMMER
STEPHEN L. GUARD, P.E.
MICHAEL HUTCHINSON
JACK MASTERSON
BERT HUFFMAN
DAN DILIBERTO
EDWARD WALSH

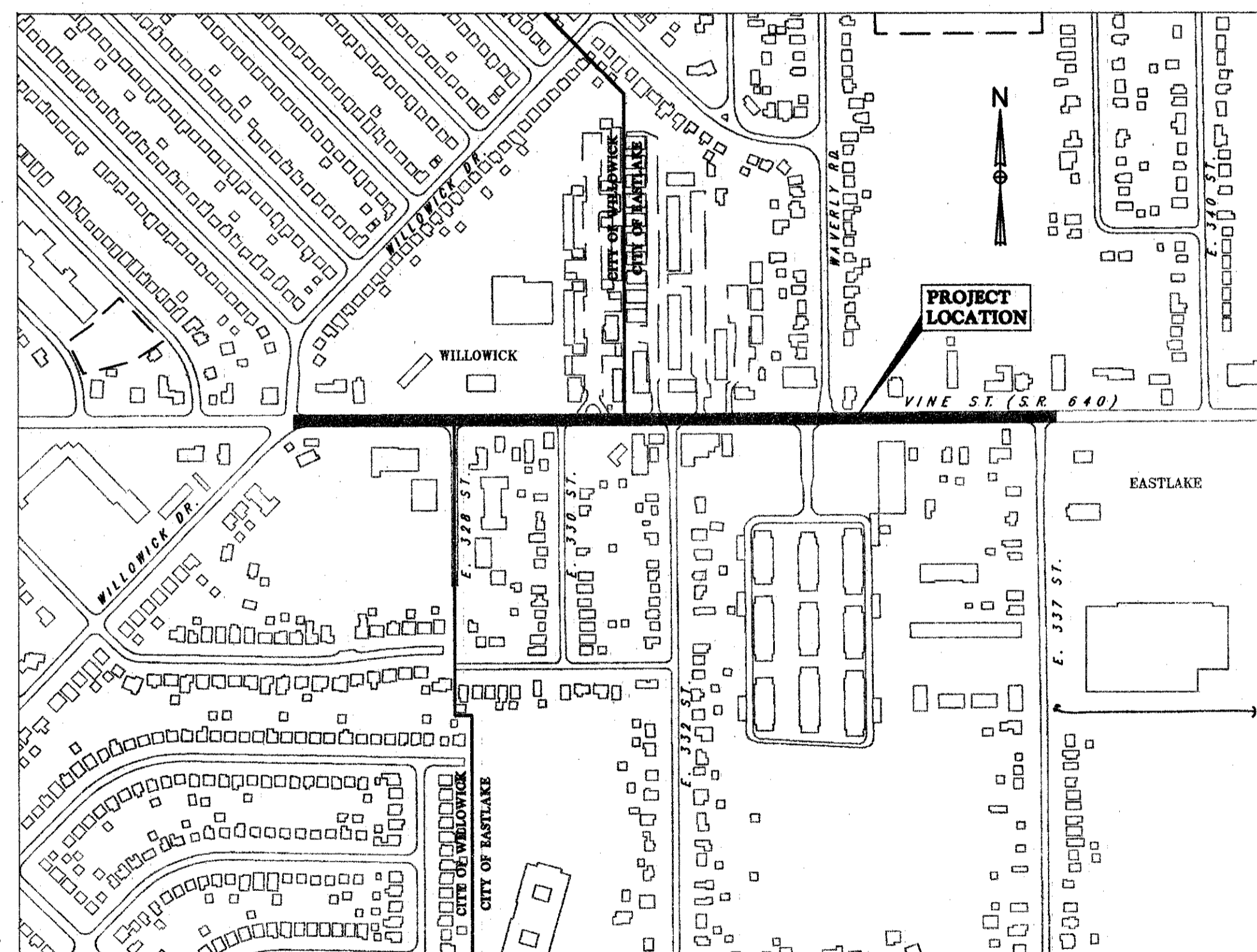

LOCATION MAP

NOT TO SCALE



Clyde C. Madden
CLYDE C. MADDEN P.E. No. 54964

11/7/00
DATE



APPROVALS

<i>David R. Hoops</i> CITY OF WILLOWICK ENGINEER	DAVID R. HOOPS, P.E.	11/7/00 DATE
<i>Stephen L. Guard</i> CITY OF EASTLAKE ENGINEER	STEVEN L. GUARD, P.E.	11/8/00 DATE

UNDERGROUND UTILITIES
TWO WORKING DAYS
BEFORE YOU DIG
CALL 800-362-2764 (TOLL FREE)
OHIO UTILITIES PROTECTION
SERVICE
NON-MEMBERS
MUST BE CALLED DIRECT

NOTE:
THE SURVEY SHOWN ON THESE PLANS WAS OBSERVED IN THE FIELD FOR CONSTRUCTION PURPOSES ONLY AND MAY NOT BE SUITABLE FOR PROPERTY LINE SURVEYS OR ANY OTHER PURPOSE.