

UG BRIDGE 164.22 Carrying the Chicago Line, LC 50-3500,
MP 164.22, DOT#523292s, Dearborn Division W041750(41750a)

SEE SHEET 105 FOR ESTIMATED DRAINAGE QUANTITIES

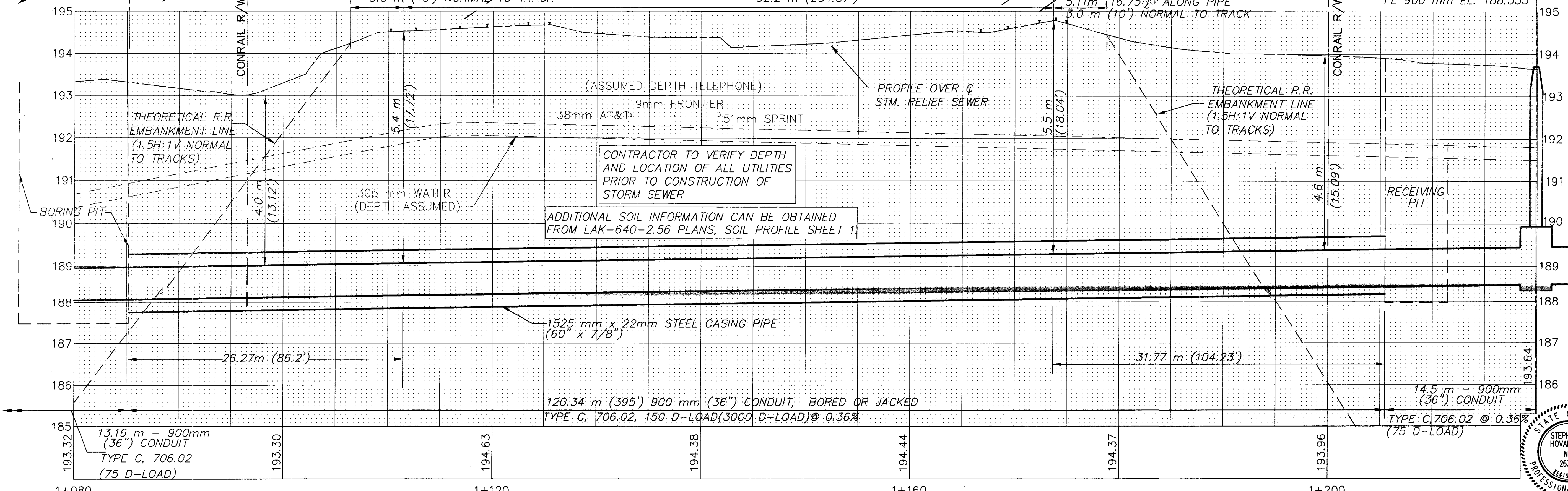
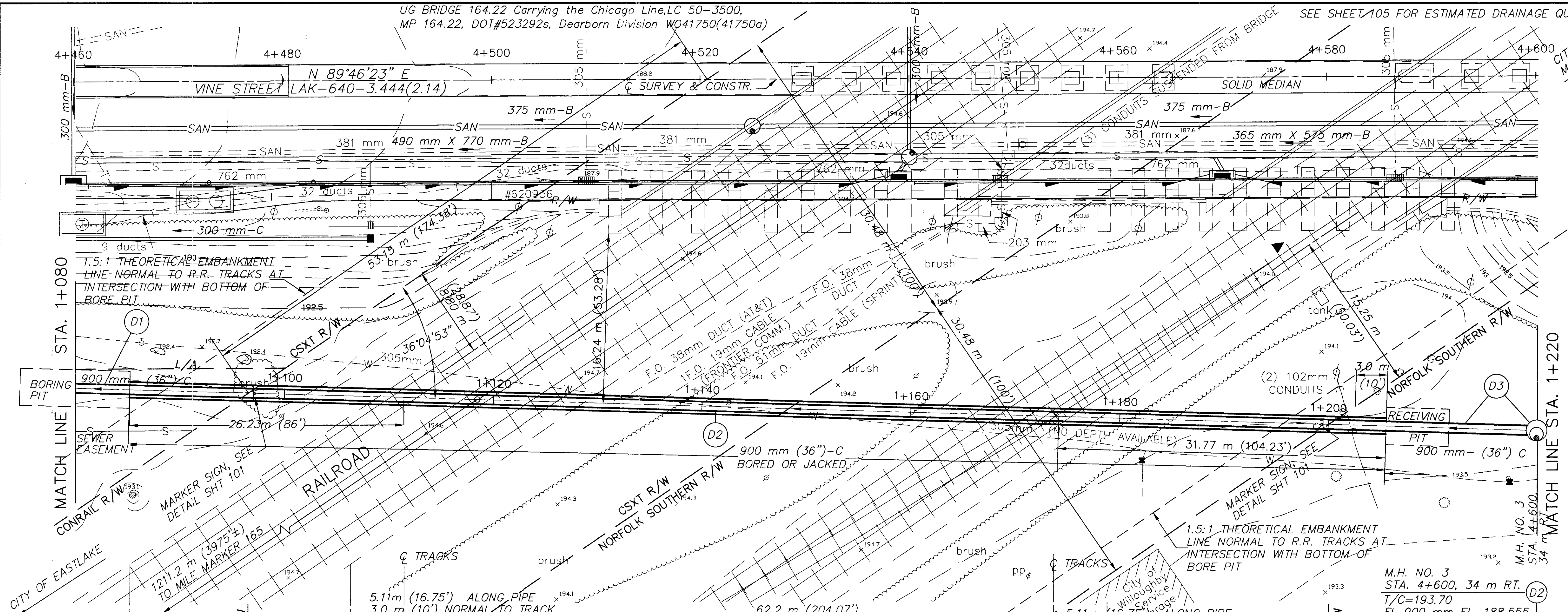

CONTRACTOR TO VERIFY DEPTH AND LOCATION OF ALL UTILITIES PRIOR TO CONSTRUCTION OF STORM SEWER

ADDITIONAL SOIL INFORMATION CAN BE OBTAINED FROM LAK-640-2.56 PLANS, SOIL PROFILE SHEET 1

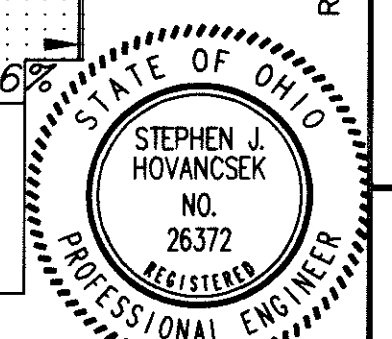

CITY OF WILLOUGHBY, LAKE COUNTY, OHIO
 PROPOSED STORM RELIEF SEWER
 STA. 4+460 TO STA. 4+600
 LAK-640-3.444
 102
 214