

CALC. BY: _____
CHECKED BY: _____

PLAN AND PROFILE SHEET
STA. 5+200 TO STA. 5+300 S.R.: 640

LAK-640-3.444

94
214

SEE SHEET 178 FOR CLARK STREET EXTRA AREA
SEE SHEETS 141, 183 FOR CATCH BASIN CROSS-OVERS
SEE SHEET 202 FOR WATER WORK QUANTITIES
SEE SHEET 60 FOR STORM CONNECTIONS
SEE SHEET 61 FOR DRIVE QUANTITIES
SEE SHEET 96 FOR ESTIMATED DRAINAGE QUANTITIES
SEE SHEET 202 FOR UTILITY RELOCATION

LEGEND

- W --- EX. WATER LINE
- SAN --- EX. SANITARY LINE
- G --- EX. GAS LINE
- S --- EX. STORM LINE
- T --- EX. TELEPHONE LINE

BENCH MARK: ELEV. 198.660
STA. 5+259.17, OFFSET 7.26 m LT.
HYDRANT TOP STEM

(*) 707.41 NON-PERFORATED,
ASTM D-3034 SDR 35,
707.33 OR 707.42

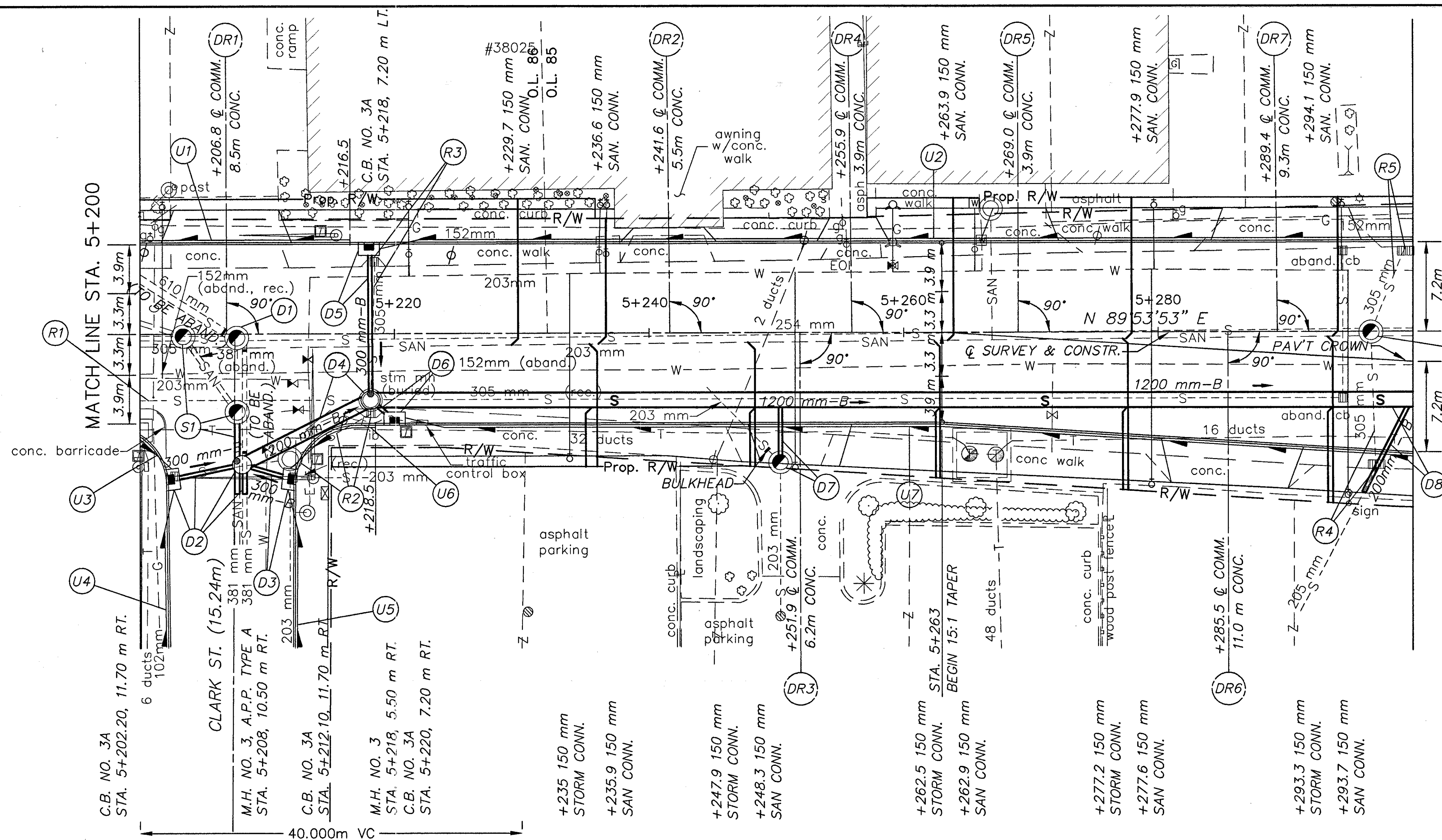

REFERENCE NUMBER		STATION		SIDE	UNDERDRAINS		BENDS AND BRANCHES FOR INFORMATION ONLY
		FROM	TO		150 mm CONDUIT, TYPE F (*)	150 mm SHALLOW PIPE UNDERDRAIN WITH FABRIC WRAP	
		ELEV.	ELEV.		METER	METER	EACH
U1		5+200	5+216.5	L		16.5	
		195.92	196.14				
U2		5+218	5+300	L	3	79	1
		196.15	196.82				
U3		5+200	5+202	R	3	1	1
		195.92	195.90				
U4		5+202	5+202	R	3	20.3	1
		195.90	196.58				
U5		5+212	5+212	R	3	20.3	1
		195.90	196.58				
U6		5+212	5+218.5	R	3	5.8	1
		195.90	196.17				
U7		5+220	5+300	R	3	77	1
		196.21	196.77				
TOTALS CARRIED TO SHEET 96					18	219.9	6

