

SEE SHEETS 126 FOR CATCH BASIN CROSS-OVERS
 SEE SHEET 88 FOR ESTIMATED DRAINAGE QUANTITIES
 SEE SHEET 200 FOR UTILITY RELOCATION

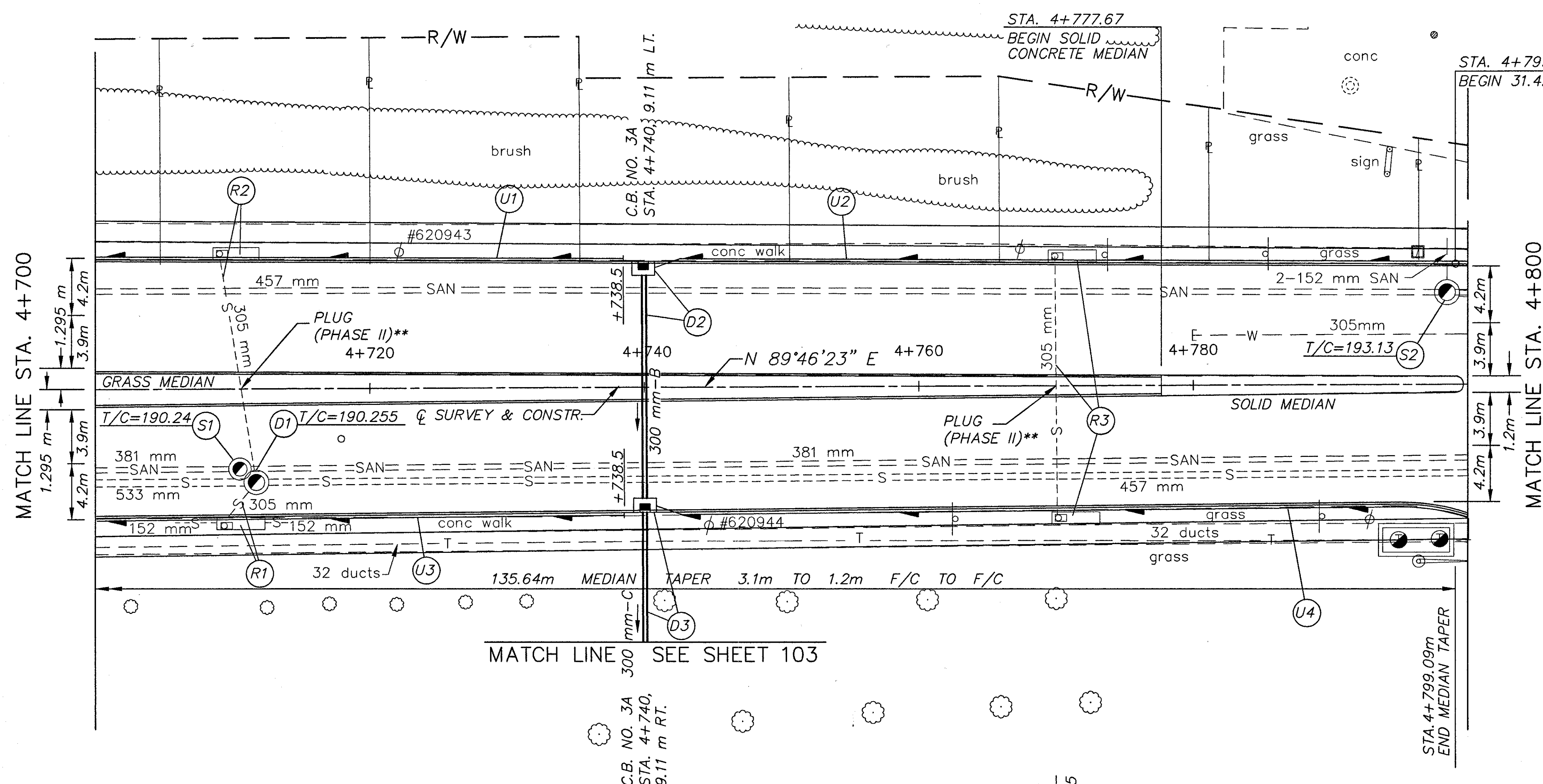
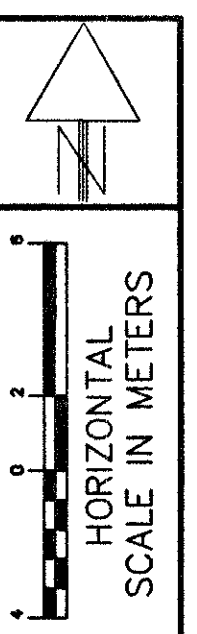

- LEGEND**
- W — EX. WATER LINE
 - SAN — EX. SANITARY LINE
 - G — EX. GAS LINE
 - S — EX. STORM LINE
 - T — EX. TELEPHONE LINE

BENCH MARK: ELEV. 194.475
 STA. 4+796.6, OFFSET 36.0 m RT.
 HYDRANT
 TOP STEM

** EXISTING CROSS-OVERS ON SOUTH SIDE OF ROAD ARE NOT TO BE REMOVED DURING PHASE I CONSTRUCTION, IN ORDER TO MAINTAIN POSITIVE DRAINAGE FROM THE NORTH SIDE OF VINE ST. THE PIPES SHALL BE PLUGGED AT THE CENTERLINE DURING PHASE II.

(*) 707.41 NON-PERFORATED,
 ASTM D-3034 SDR 35,
 707.33 OR 707.42

UNDERDRAINS

REFERENCE NUMBER	STATION		SIDE	603		605		BENDS AND BRANCHES FOR INFORMATION ONLY
	FROM	TO		150 mm CONDUIT, TYPE F (*)	150 mm SHALLOW PIPE UNDERDRAIN WITH FABRIC WRAP	150 mm x 45°		
	E ELEV.	E ELEV.					METER	
U1	4+700	4+738.5	L	188.685	190.095		38.5	
U2	4+740	4+800	L	190.150	191.995	3	57	1
U3	4+700	4+738.5	R	188.685	190.095		38.5	
U4	4+740	4+800	R	190.150	191.995	3	57	1
TOTALS CARRIED TO SHEET 88						6	191	2

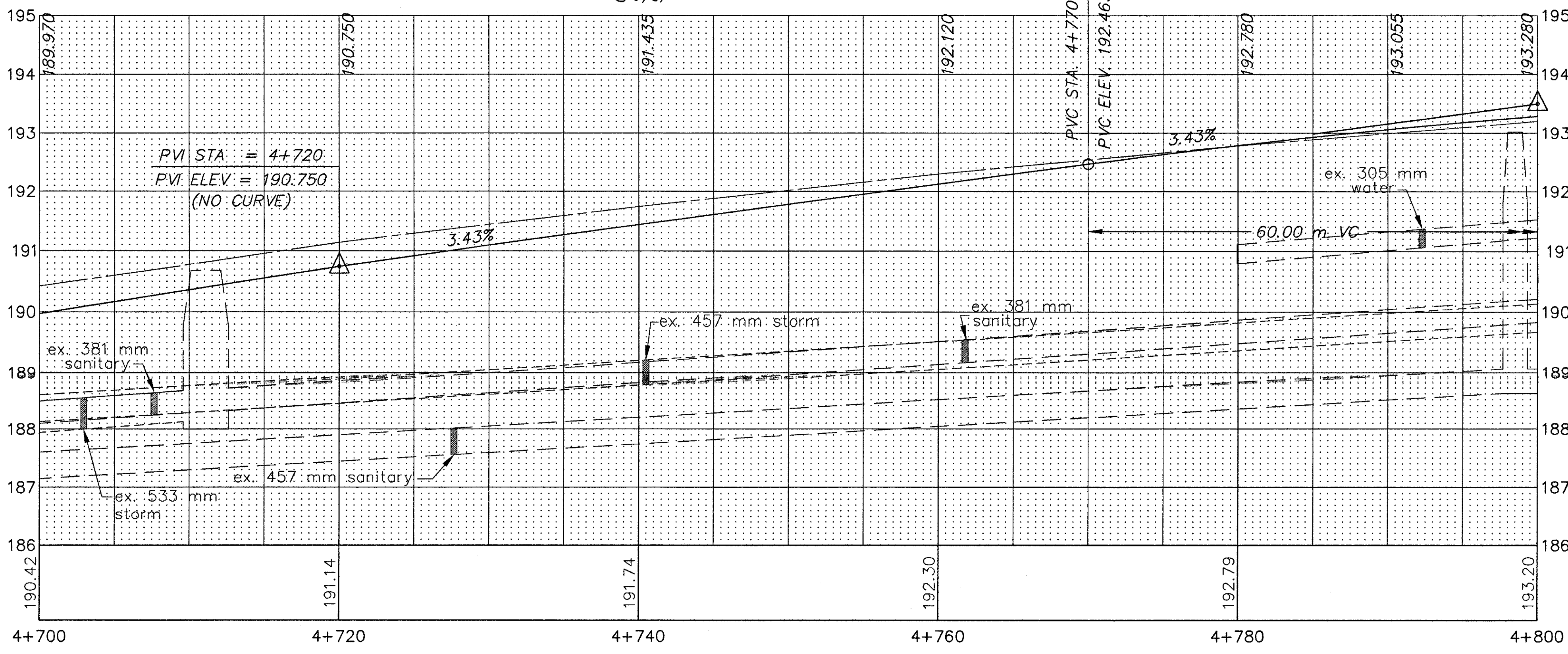

MATCH LINE STA. 4+700

MATCH LINE STA. 4+800

MATCH LINE SEE SHEET 103

PLAN AND PROFILE SHEET
 STA. 4+700 TO STA. 4+800 S.R. 640

LAK-640-3.444