

TEMPORARY YELLOW EDGE LINE CLASS 1, 740.06, TYPE I

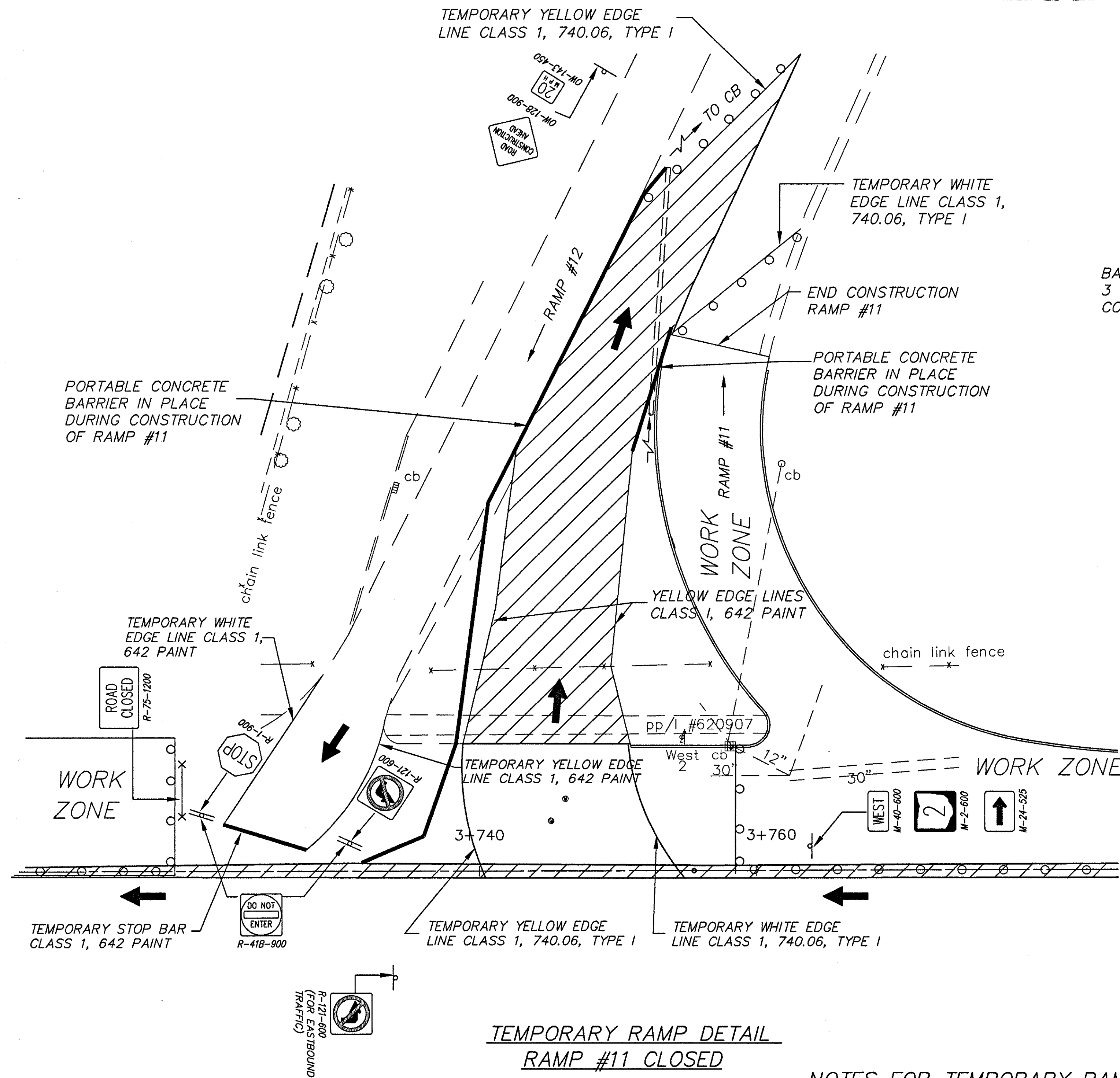

**TEMPORARY RAMP DETAIL  
RAMP #11 CLOSED**  
POSTED SPEED FOR RAMPS  
(20 MPH)

**NOTES FOR TEMPORARY RAMP CONSTRUCTION  
RAMPS 11 AND 12**

- FENCE BETWEEN RAMPS TO BE REMOVED FOR CONSTRUCTION OF TEMPORARY RAMP AND REPLACED AT THE COMPLETION OF THE RAMP CONSTRUCTION.
- PORTIONS OF THE MEDIAN SHALL BE REMOVED AND REPLACED WITH THE TEMPORARY PAVEMENT TO ALLOW FOR ACCESS TO RAMPS.
- RAMP #11 TO BE CONSTRUCTED FIRST.
- YELLOW EDGE LINES TO BE PAINTED ALONG BOTH SIDES OF TEMPORARY RAMP.
- 18 m CONDUIT TO BE INSTALLED FOR TEMPORARY DRAINAGE BETWEEN RAMPS.  
QUANTITY CARRIED TO SHEET NO. 62
- BARRELS TO BE 3 m APART ON ALL TAPERS.

BARRELS TO BE SPACED  
3 m C/C DURING  
CONSTRUCTION OF RAMP #12

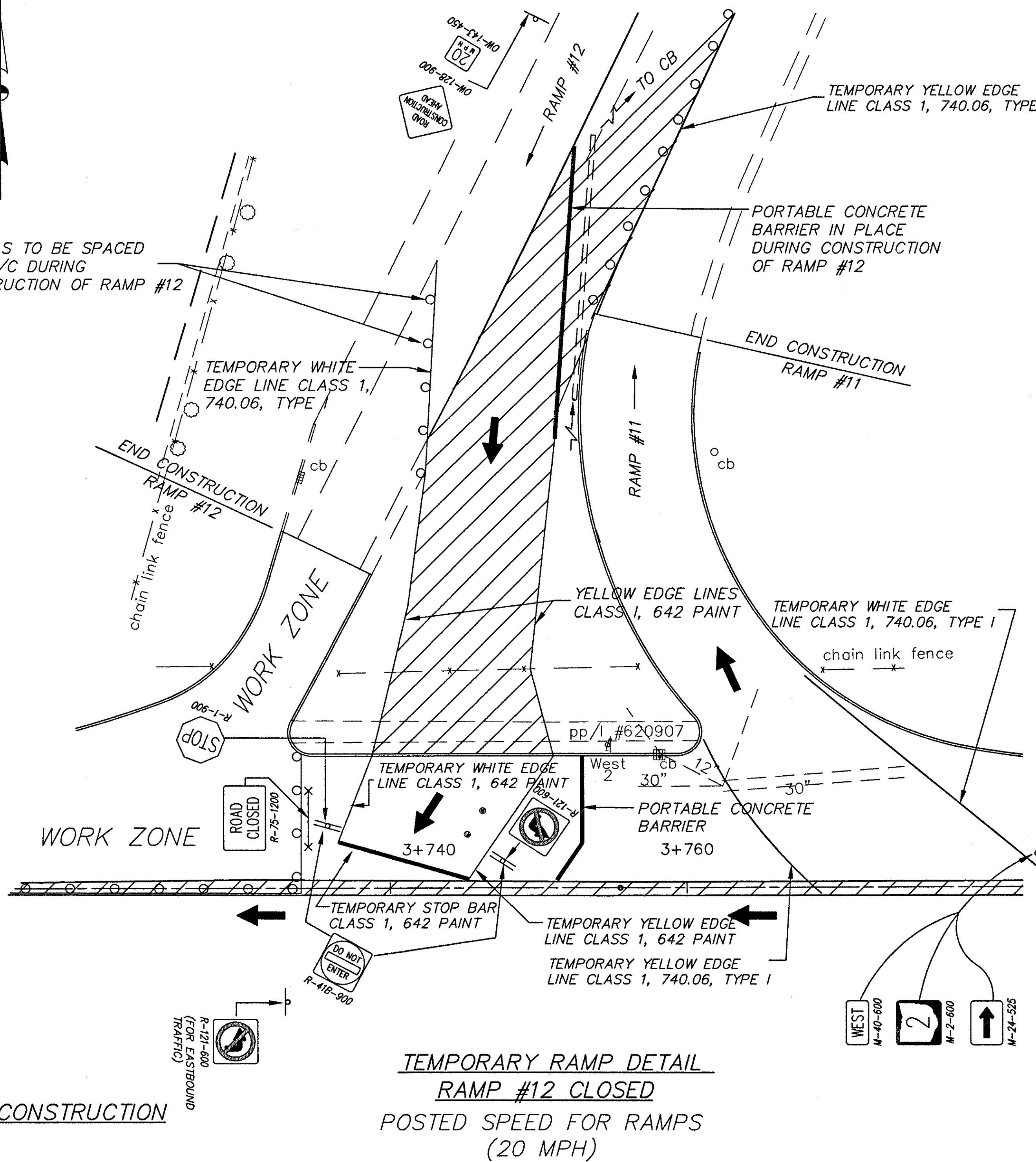

**TEMPORARY RAMP DETAIL  
RAMP #12 CLOSED**  
POSTED SPEED FOR RAMPS  
(20 MPH)

**LEGEND**

TEMPORARY PAVEMENT

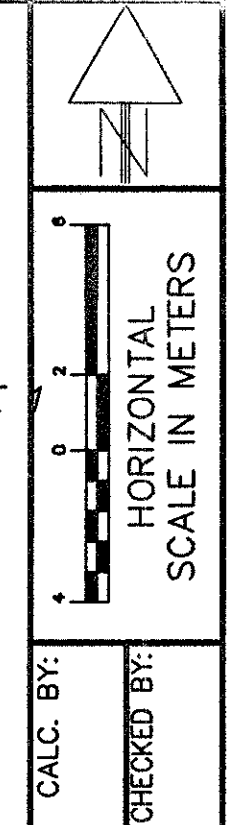

MAINTENANCE OF TRAFFIC  
MISCELLANEOUS DETAILS

LAK-640-3.444

51A  
214