



STATE OF OHIO
DEPARTMENT OF TRANSPORTATION

LAK-640-3.444
CITY OF EASTLAKE
CITY OF WILLOUGHBY
LAKE COUNTY

PROJECT DESCRIPTION

IMPROVEMENT OF 1.86 KILOMETERS OF STATE ROUTE 640 BY RECONSTRUCTING THE EXISTING REINFORCED CONCRETE PAVEMENT WITH ASPHALT OVERLAY WITH A NEW REINFORCED CONCRETE PAVEMENT. THE LOWERING OF THE EXISTING CENTERLINE PROFILE OF STATE ROUTE 640 UNDER STATE ROUTE 2 AND THE N.Y.C.R.R. AND N.Y.C. & ST. L. R.R BRIDGES.

1997 SPECIFICATIONS

THE STANDARD SPECIFICATIONS OF THE STATE OF OHIO, DEPARTMENT OF TRANSPORTATION, INCLUDING CHANGES AND SUPPLEMENTAL SPECIFICATIONS LISTED IN THE PROPOSAL SHALL GOVERN THIS IMPROVEMENT.

I HEREBY APPROVE THESE PLANS AND DECLARE THAT THE MAKING OF THIS IMPROVEMENT WILL REQUIRE THE CLOSING TO TRAFFIC OF THE INTERSECTING HIGHWAYS AND THAT DETOURS WILL BE PROVIDED AS INDICATED ON SHEET NO. 29 AND 30. THE MAINTENANCE AND SAFETY OF TRAFFIC WILL BE AS SET FORTH ON THE PLANS AND ESTIMATES.

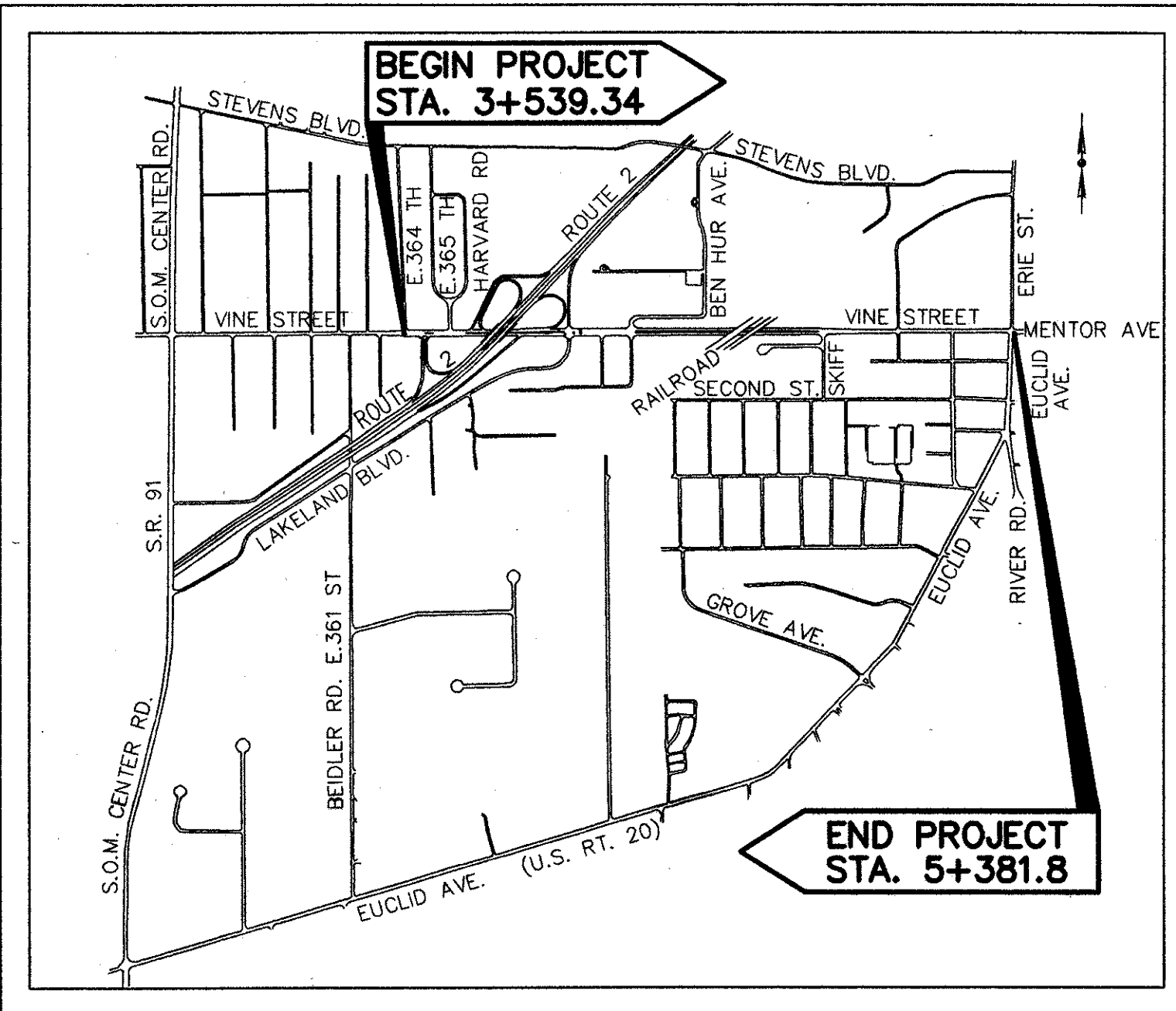

LOCATION MAP

LATITUDE: N41°38'33" LONGITUDE: W81°25'08"

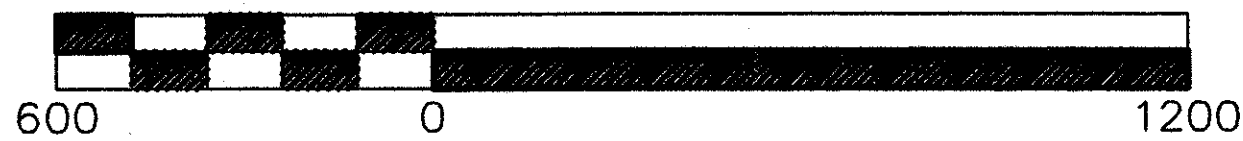

PORTION TO BE IMPROVED
STATE & FEDERAL ROUTES
OTHER ROADS
DETOUR ROUTE

DESIGN DESIGNATION

CURRENT ADT (2000) 26,090
DESIGN YEAR ADT (2020) 33,916
DESIGN HOURLY VOLUME (2020) 3,131
DIRECTIONAL DISTRIBUTION 0.54
TRUCKS (24 HOUR B&C) 3 %
DESIGN SPEED 70 km/h
LEGAL SPEED 25 mph/35mph
DESIGN FUNCTIONAL CLASSIFICATION - URBAN ARTERIAL

DESIGN EXCEPTIONS

DESIGN FEATURE	APPROVAL DATE	SHEET NOS.
LANE WIDTH	OCTOBER 27, 1995	9

INDEX OF SHEETS:

TITLE SHEET	1	PLAN AND PROFILE	68-105
SCHEMATIC PLAN	2	CROSS SECTIONS	106-145
TYPICAL SECTIONS	3-21	EXTRA AREAS	146-180
GENERAL NOTES	22-24,24A, 25-28	DRAINAGE DETAILS	180A,181-183, 183A, 184, 185, 185A, 186-188
MAINTENANCE OF TRAFFIC	29-50, 50A,50B,50C, 50D,50E, 51,51A,51B	MISCELLANEOUS DETAILS	189-193
GENERAL SUMMARY	52-55,55A	UTILITY PLAN	194-203
CALCULATIONS	56-58, 58A, 59-63	TRAFFIC CONTROL	204-212
STORM WATER POLLUTION PREVENTION PLAN	64-67	RIGHT-OF-WAY	213, 213A-213Z, 213AA, 214

UNDERGROUND UTILITIES
TWO WORKING DAYS
BEFORE YOU DIG
CALL 1-800-362-2764 (TOLL FREE)
OHIO UTILITIES PROTECTION SERVICE
NON-MEMBERS
MUST BE CALLED DIRECTLY



STEPHEN J. HOVANCSEK P.E. #26372 DATE 3-18-02

PLAN PREPARED BY:
STEPHEN HOVANCSEK & ASSOCIATES
CONSULTING ENGINEERS
2 MERIT DRIVE
RICHMOND HEIGHTS, OH 44143

STANDARD CONSTRUCTION DRAWINGS										SUPPLEMENTAL SPECIFICATIONS	
BP 1.2	7-28-00	HW 1.1M	7-12-95	HL 30.11M	3-31-95	MT 35.10M	1-30-95			806	09-09-97
BP 2.1	7-28-00	MH 1.1M	10-21-97			MT 35.11M	1-30-95			830	10-21-98
BP 2.2	7-28-00	MH 1.2M	9-6-95	TC 12.30M	2-1-94	MT 99.10M	1-30-95			870	08-10-99
BP 5.1	7-28-00	MH 1.3M	9-6-95	TC 21.20M	12-10-96	MT 101.60M	4-25-94			877	04-13-99
BP 7.1	7-28-00			TC 41.20M	7-1-94	MT 105.11M	4-25-94			932	10-02-96
		DM 1.1M	6-30-95	TC 41.40M	3-31-94						
		DM 4.2M	6-30-95	TC 41.50M	7-1-94	RM 4.2M	10-21-97				
F 1.1	7-28-00	DM 4.3	4-29-99								
		DM 4.4	4-29-99								
				TC 42.10M	3-31-94						
RM 3.1M	10-21-97			TC 42.20M	3-31-94						
				TC 51.11M	9-30-94						
				TC 71.10M	9-1-93						
CB 1.1M	7-12-95			TC 82.10	1-19-99						
CB 2.1M	7-12-95										
CB 2.2M	7-12-95										

SPECIAL PROVISION
* OAC PERMIT
RULE 3745-27-13
* WATERWAY PERMIT
NWP #18 11-07-00

APPROVED *David Boyle*
DATE 10 APR 2002 DISTRICT DEPUTY DIRECTOR

APPROVED _____
DATE _____ DIRECTOR, DEPARTMENT OF
TRANSPORTATION

FEDERAL PROJECT NO. TE21-G010(111)
PID NO. 13722
CONSTRUCTION PROJECT #
RAILROAD INVOLVEMENT CSX AND NORFOLK & SOUTHERN
LAK-640-3.444
1/214