

QUANTITY CALCULATIONS  
 BY: *DFC* DATE: 3/73  
 CHKD: *LEB* DATE: 3/73  
 BURGESS & NIPLE, LIMITED

FED. RD. DIVISION	STATE	PROJECT
5	OHIO	

11  
23

LAK-640-0.98  
 LAK-283-3.83  
 LAK-91-5.49

**VINE STREET INTERCONNECT TIMING SCHEDULE**

70 Second Cycle Length  
 9 PM to 7 AM  
 9 AM to 12 Noon  
 1:30 PM to 3 PM

INTERSECTIONS	Green		Yellow		Red		Offset*	
	Sec.	%	Sec.	%	Sec.	%	Sec.	%
Vine Street	49	70	3	4	18	26	0	0
E. 332 Street	15	22	3	4	52	74		
Vine Street	49	70	3	4	18	26	0	0
E. 334 Street	15	22	3	4	52	74		
Vine Street	49	70	3	4	18	26	35	50
E. 337 Street	15	22	3	4	52	74		
Vine Street	49	70	3	4	18	26	0	0
E. 343 Street	15	22	3	4	52	74		
Vine Street	18.9	27	3.5	5	47.6	68	50	72
S.R. 91	18.9	27	3.5	5	47.6	68		
Vine Street	49	70	3	4	18	26	0	0
E. 341 Street	15	22	3	4	52	74		

80 Second Cycle Length  
 7 AM to 9 AM  
 6 PM to 9 PM

INTERSECTIONS	Green		Yellow		Red		Offset*	
	Sec.	%	Sec.	%	Sec.	%	Sec.	%
Vine Street	59	74	3	4	18	22	44	40
E. 332 Street	15	19	3	4	42	77		
Vine Street	59	74	3	4	18	22	0	0
E. 334 Street	15	19	3	4	42	77		
Vine Street	59	74	3	4	18	22	0	0
E. 337 Street	15	19	3	4	42	77		
Vine Street	59	74	3	4	18	22	40	44
E. 343 Street	15	19	3	4	42	77		
Vine Street	20.8	26	3.2	4	50	70	19	24
S.R. 91	20.8	26	3.2	4	50	70		
Vine Street	59	74	3	4	18	22	40	50
E. 341 Street	15	19	3	4	42	77		

90 Second Cycle Length  
 12 Noon to 1:30 PM  
 3 PM to 6 PM

INTERSECTIONS	Green		Yellow		Red		Offset*	
	Sec.	%	Sec.	%	Sec.	%	Sec.	%
Vine Street	49	77	3	3	18	20	87	97
E. 332 Street	15	17	3	3	72	80		
Vine Street	45	70	3	3	24	27	0	0
E. 334 Street	21	23	3	3	40	74		
Vine Street	45	70	3	3	24	27	0	0
E. 337 Street	21	23	3	3	40	74		
Vine Street	49	77	3	3	18	20	42	47
E. 343 Street	15	17	3	3	72	80		
Vine Street	22.5	25	3.4	4	43.9	71	20	22
S.R. 91	22.5	25	3.4	4	43.9	71		
Vine Street	32	36	3	3	55	61	60	67
E. 341 Street	52	58	3	3	35	39		

\* Master Controller at S.R. 91 - Offset is measured from the beginning of Vine Street Green cycle at E. 334 Street to beginning of Vine Street Green cycle at each successive intersection.

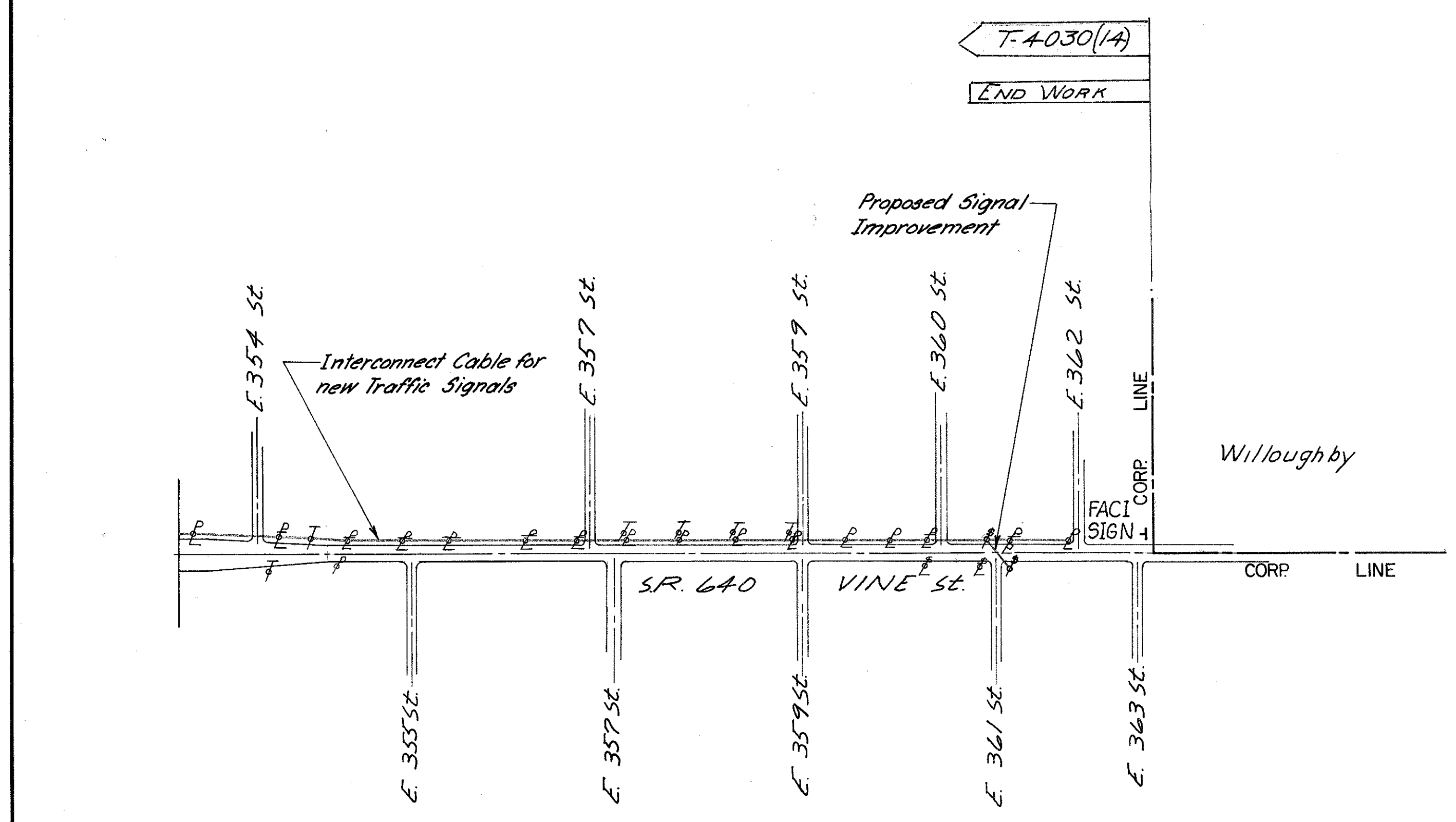
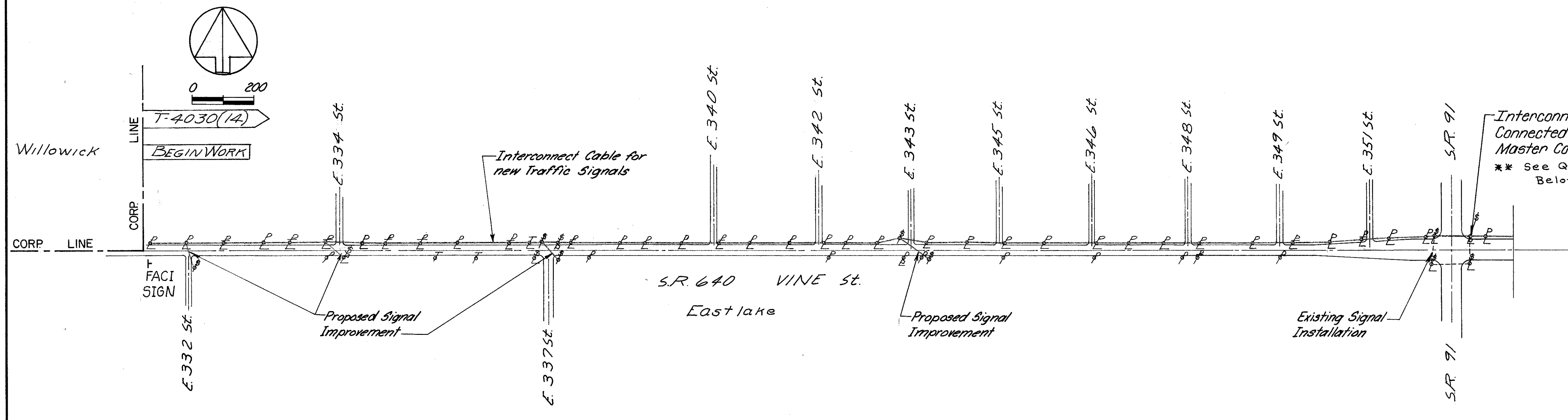

ITEM 625 INTERCONNECT CABLE	
LOCATION	QUANTITY
West Corporation Line to East Corporation Line of Eastlake	6220 L.F.

** ITEM 625	
	QUANTITY
Signal Cable s/c	30 L.F.
Weatherhead and Conduit Riser 1'	1