

BENCHMARK: PK NAIL IN POLE #
 836952 AT C. HOPKINS EXT. & W.
 SIDE MUNSON
 ELEV. 635.74

FOR TYPICAL SECTION SEE SHEET 8
 FOR CROSS SECTIONS SEE SHEET 83 THRU 85
 FOR SIGNING PLAN SEE SHEET 151
 FOR PAVEMENT MARKING DETAILS SEE SHEET 154

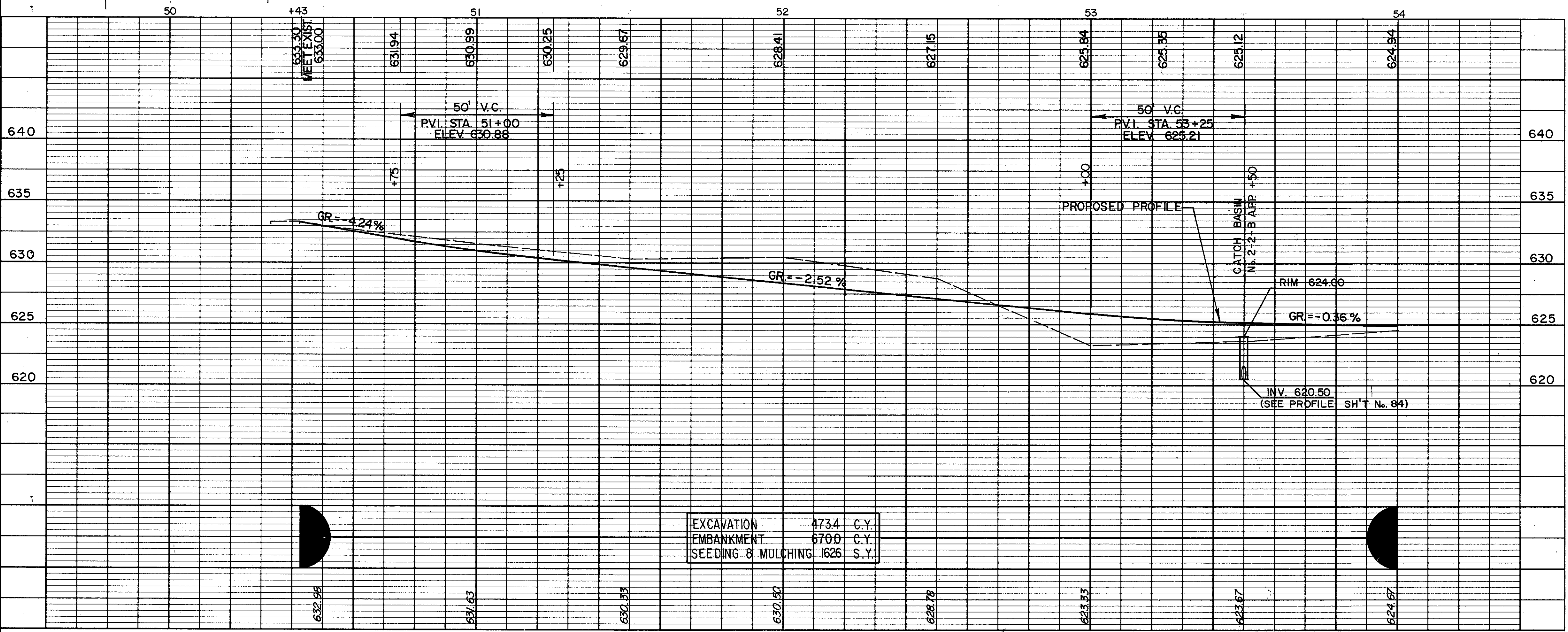

EXCAVATION	4734 C.Y.
EMBANKMENT	6700 C.Y.
SEEDING & MULCHING	1626 S.Y.

DRAINAGE & EROSION CONTROL			
REF	LOCATION	L.F.	S.Y.
D-1	STA. 53+50, 29' LT.	19	
D-2	STA. 53+50, 29' LT. TO STA. 53+53, 48' LT.		
E-1	STA. 50+43 TO STA. 54+00, LT.		368
TOTALS		19	368

ROADWAY			
REF	LOCATION	L.F.	S.Y.
R-1	STA. 53+00 TO 54+00, LT.	100	
TOTALS		100	

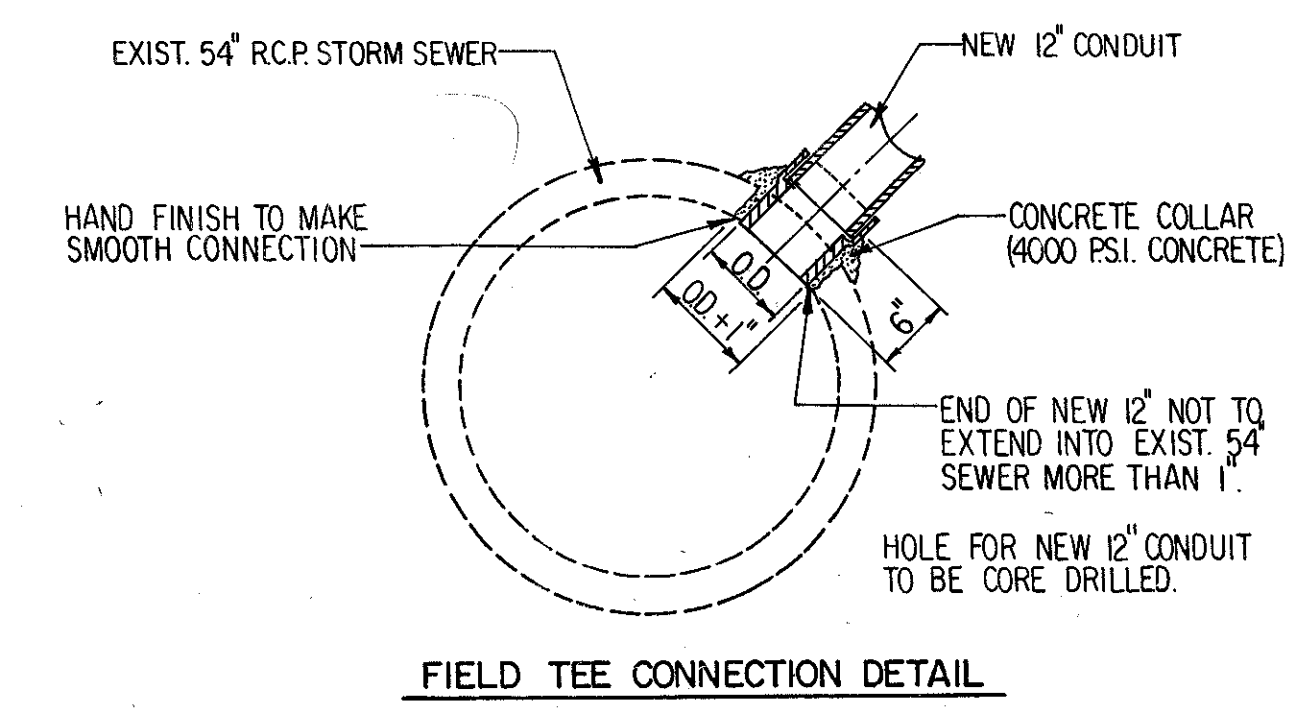

PLAN & PROFILE STA. 50+00 TO STA. 54+00

HOPKINS ROAD