

MICROFILMED  
FEB 12 1985

FED. ROAD DIV. NO.	STATE	FED. AID PROJ. NO.	TYPE FUNDS
2	OHIO		

131  
181

LAKE COUNTY  
LAK-615-3.26

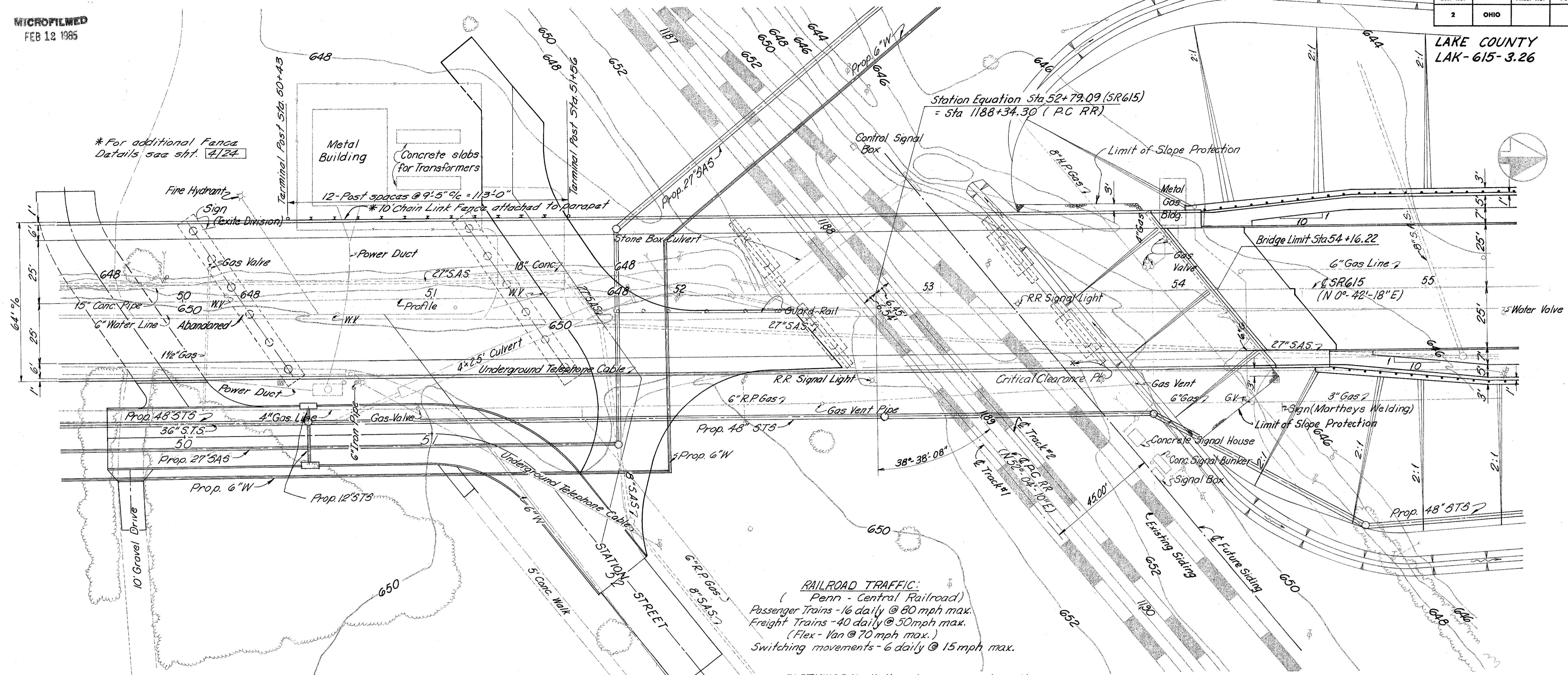

**RAILROAD TRAFFIC:**  
(Penn - Central Railroad)  
Passenger Trains - 16 daily @ 80 mph max.  
Freight Trains - 40 daily @ 50 mph max.  
(Flex - Van @ 70 mph max.)  
Switching movements - 6 daily @ 15 mph max.

**EARTHWORK** limits shown are schematic.  
Actual slopes shall conform to plan cross-sections.

**BENCH MARK:**  
USGS Bench Mark D-9, 1934 Plate  
in N.E. corner P.C. RR Station, El. 655.76

700' V.C. P.V. 1. Sta 50+00, El. 695.55  
 $g_1 = +4.00\%$ ;  $g_2 = -4.00\%$

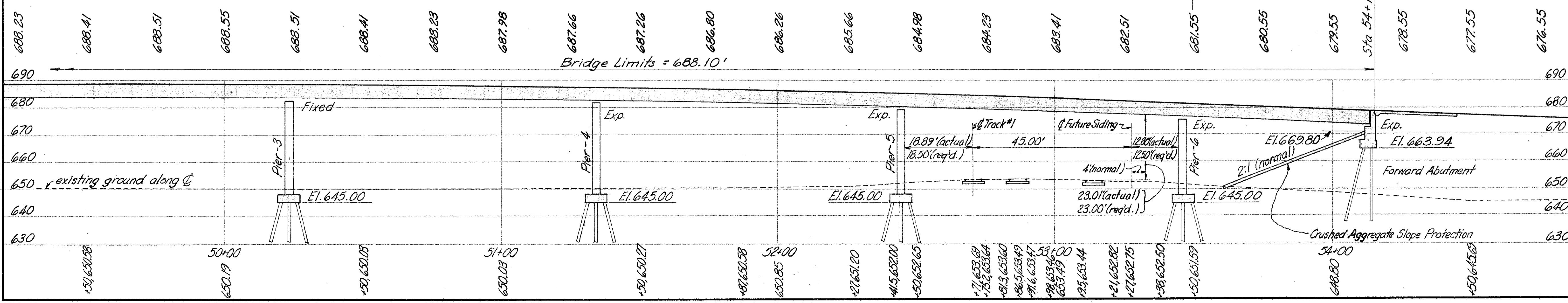

**BURGESS & NIPLE LIMITED — CONSULTING ENGINEERS**  
COLUMBUS 12, OHIO

**SITE PLAN**  
Bridge No. LAK-615-0402  
over  
N & W RAILWAY & P-C RAILROAD  
Scale: 1" = 20'  
LAKE COUNTY

Sta. 47+28.12  
Sta. 54+16.22

DESIGNED ROB	DRAWN WOR	TRACED	CHECKED KED	REVIEWED DATE WOR 7-23-68	REVISED
-----------------	--------------	--------	----------------	------------------------------	---------