

LAKE COUNTY
LAK-615-3.26

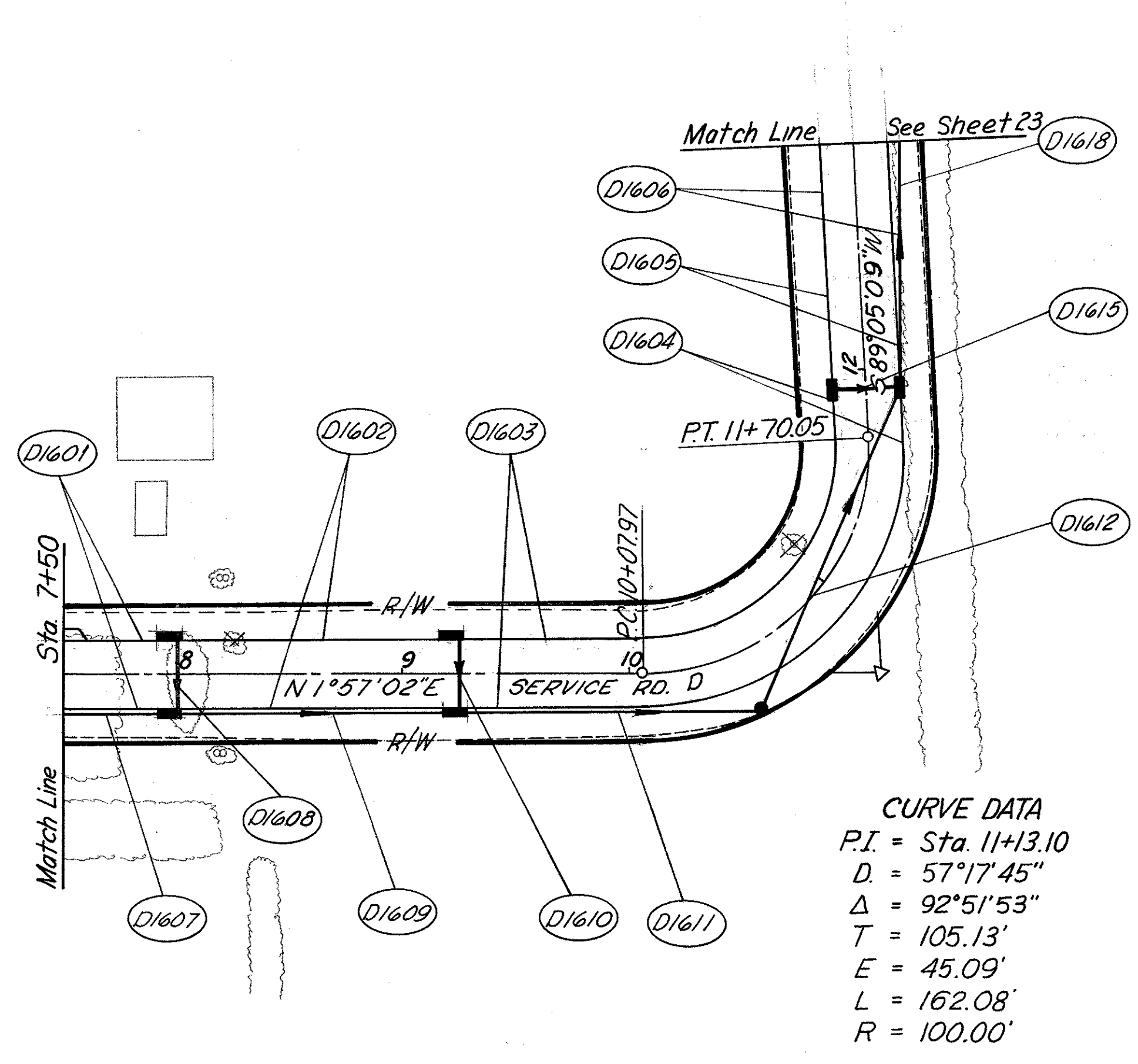

REF.	LOCATION	7221					603				604		605		603
		12" Type B	15" Type B	18" Type B	21" Type B	6" Type F	No. 2-4-8 Inlet	No. 2-4-10 Inlet	No. 3 Catch Basin	No. 1 Manhole	4" Shallow Pipe Underdrain	24" Type B	L.F.	L.F.	
D1601	7+50 to 8+00, R & L					20									80
D1602	8+04 to 9+25, R & L					20									222
D1603	9+29 to 11+40, R & L					20									402
D1604	11+44 to 11+91, R & L					20									74
D1605	11+91 to 12+36, R & L					20									70
D1606	12+40 to 13+00, R & L					20									120
D1607	7+50 to 8+00, R 10.07'		50												
D1608	8+00 L 15' to R 15'	33								1					
D1609	8+00 to 9+25, R 10.07'			125						1					
D1610	9+25, L 15' to R 15'	33								1					
D1611	9+25, R 10.07' to 10+50, R 27'				134					1					
D1612	10+50, R 27' to 11+91, R 15'				153								1		
D1615	11+91, L 15' to R 15'	30										1			
D1618	11+01 R 11.62' to 13+00, R 16'											1			109
TOTAL		90	50	125	287	120	1	3	2	1	968	109			

For cross sections see Sheet 114
 For sewer profiles see Sheet 47

For pavement elevations see Sheet 73

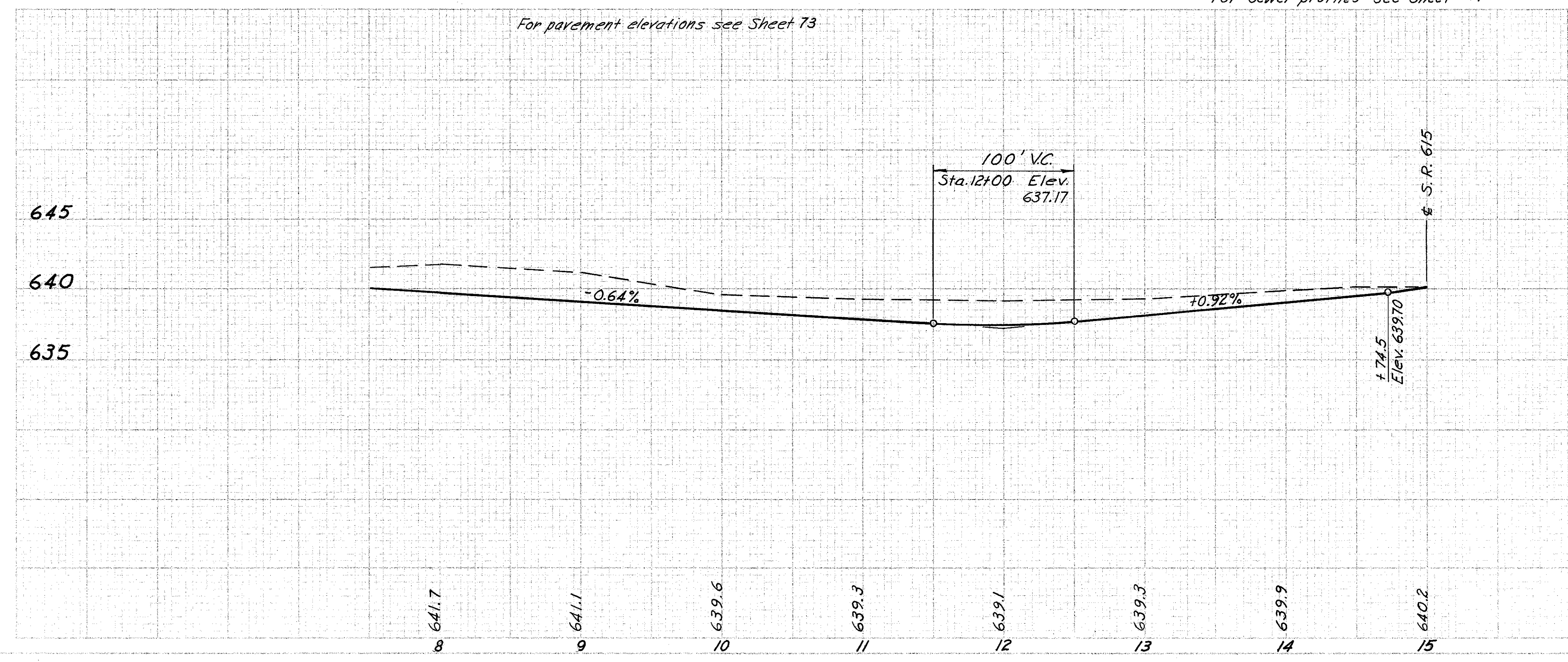

QUANTITY CALCULATIONS
 BY: [Signature]
 DATE: 12/22/68
 CHECKED: [Signature]
 DATE: 1/27/69
 ENGINEER: [Signature]

SERVICE RD. D