

LAK - SR 615 - 0.22
 020143 PID - 21514
 Dist 12 3/6/2002

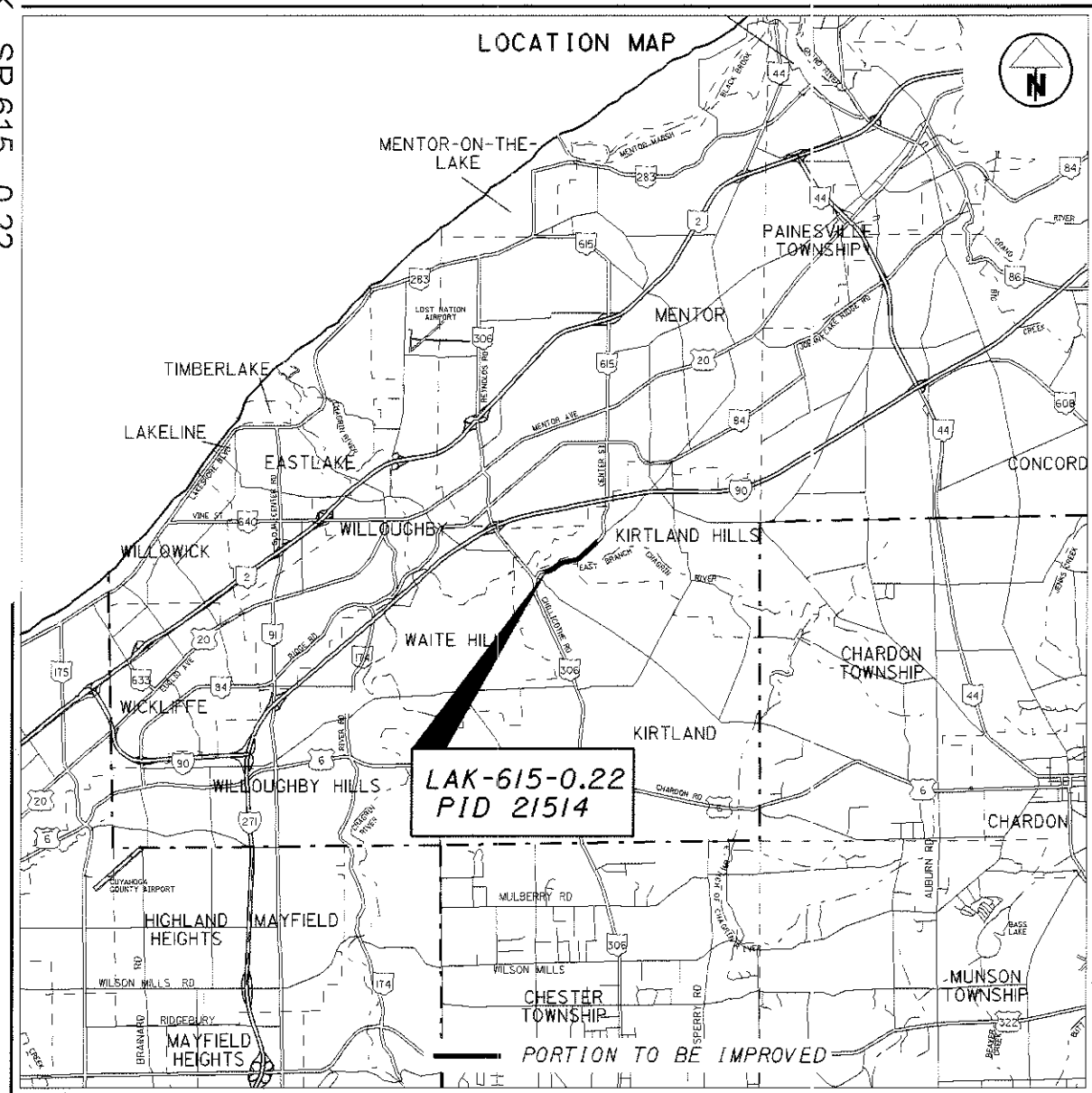

LATITUDE: N 41°37'50"± LONGITUDE: W 81°21'34"± LOCATION MAP
 SCALE OF MILES 0 1 2

DESIGN DESIGNATION
 CURRENT ADT (2001) ----- 7333
 TRUCKS (24 HOUR B&C) ----- 4%
 DESIGN SPEED ----- 40 MPH
 LEGAL SPEED ----- 35 MPH

DESIGN FUNCTIONAL CLASSIFICATION -
 URBAN MINOR ARTERIAL

DESIGN EXCEPTIONS
 NONE

UNDERGROUND UTILITIES
 TWO WORKING DAYS
BEFORE YOU DIG
 CALL 1-800-362-2764 (TOLL FREE)
 OHIO UTILITIES PROTECTION SERVICE
 NON-MEMBERS
 MUST BE CALLED DIRECTLY

RESURFACING

PART	COUNTY	ROUTE	SECTIONS	PROJECT TERMINI		NET LENGTH MILES	CITY	VILLAGE
				BEGIN	END			
	LAK	615	0.00, 0.24,	0.22	1.14	0.92	KIRTLAND	KIRTLAND HILLS
			0.88					

INDEX OF SHEETS:

TITLE SHEET	1
GENERAL NOTES	2,3
PAVEMENT QUANTITIES	4
GENERAL SUMMARY	5

PROJECT DESCRIPTION

THIS PROJECT WILL RESTORE THE PAVEMENT SURFACE BY TREATING THE TOP 2" OF THE EXISTING PAVEMENT WITH HOT IN PLACE RECYCLING. THE RECYCLED ASPHALT WILL BE OVERLAID WITH 1.5" OF ASPHALT SURFACE COURSE.

1997 SPECIFICATIONS

The standard specifications of the State of Ohio, Department of Transportation, including changes and supplemental specifications listed in the proposal shall govern this improvement.

I hereby approve these plans and declare that the making of this improvement will not require the closing to traffic of the highway and that provisions for the maintenance and safety will be as set forth on plans and estimates.



PLAN PREPARED BY:
 ODOT DISTRICT 12
 PRODUCTION
 DEPARTMENT

Jon E. Lorincz
 JON E. LORINCZ

STANDARD DRAWINGS		STANDARD DRAWINGS		SUPPLEMENTAL SPECIFICATIONS	
BP-3.1	07-28-00	GR-1.1M	10-21-97	822	02-27-01
		GR-1.2M	01-03-96	828	12-14-00
		GR-1.3M	11-30-94	870	03-27-01
		GR-2.1M	04-14-98	899	10-21-98
MT-97.10M	04-25-94	GR-4.1M	11-30-94	906	05-05-98
MT-97.11M	01-30-95			908	11-07-00
MT-105.10M	04-25-94			932	10-02-96
MT-105.11M	04-25-94				

Approved *Steve Pugh*
 Date 3/20/02 District Deputy Director of Transportation

Approved *Gordon Proctor*
 Date 12-14-01 Director, Department of Transportation

FEDERAL PROJECT NO. 100% STATE
 PID NO. 21514
 CONSTRUCTION PROJECT NO.
 RAILROAD INVOLVEMENT NONE
 LAK-615-0.22
 1/5