

LAKE COUNTY
LAK -615-006
 At Kirtland Hills

EXISTING BRIDGE DATA	
TYPE	PRATT TRUSS
SPAN	96'-0" Clear
ROADWAY	15'-5 1/2"
SKEW	NONE
LOADING	H-4.2 (Red 60%)

DRAINAGE AREA = 44.70 SQ. MI.

FOUNDATION SOUNDINGS:

Foundation design and foundation quantities are based on a study of rod soundings and soil-sampling soundings made at the site. This sounding information may be inspected in the Office of the Bureau of Bridges in Columbus, or in an abridged form in the Division office, but the State assumes no responsibility for the accuracy thereof.

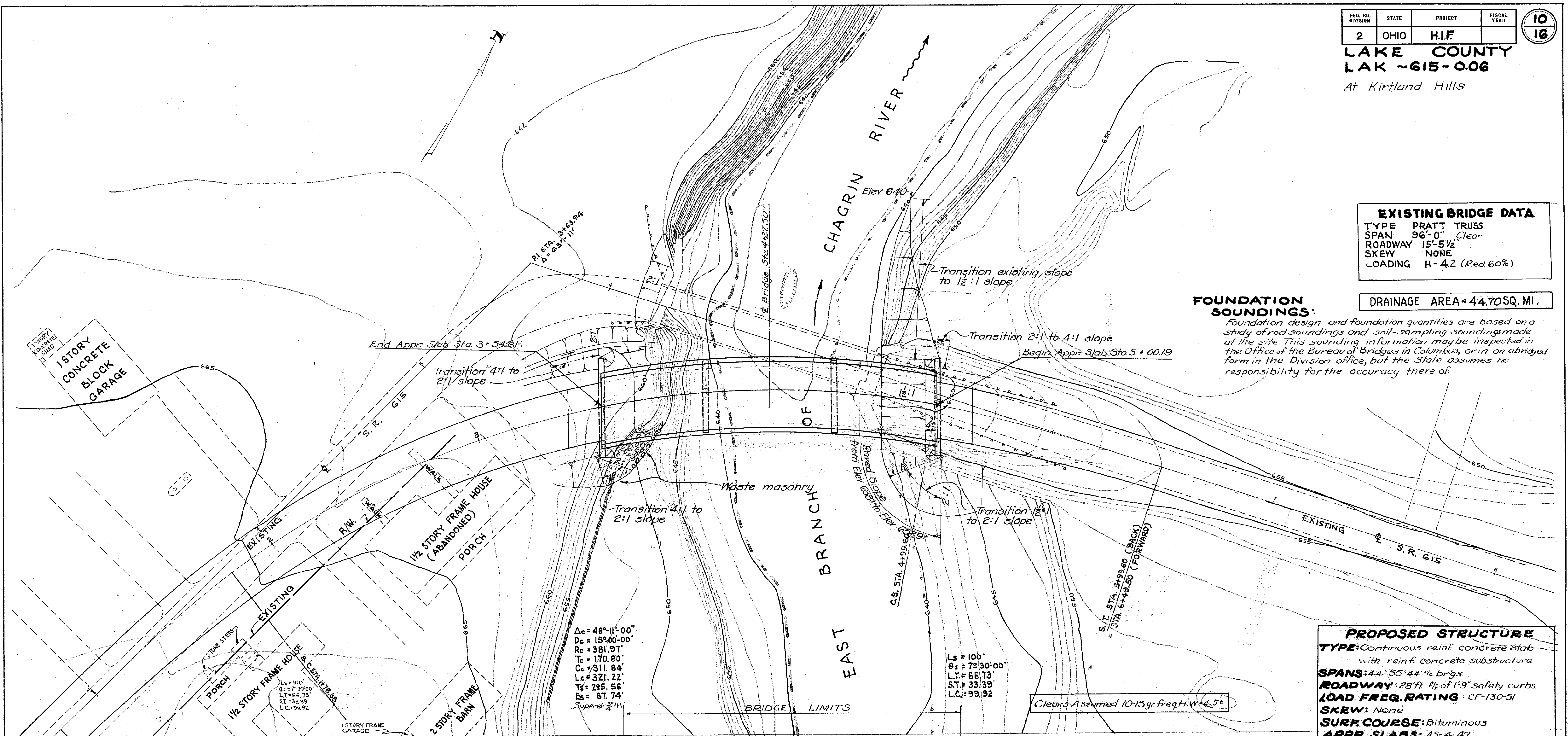

$\Delta c = 48^{\circ} 11' 00''$
 $Dc = 15^{\circ} 00' 00''$
 $Rc = 381.97'$
 $Tc = 170.80'$
 $Cc = 311.84'$
 $Lc = 321.22'$
 $Ts = 285.56'$
 $Ea = 67.74'$
 Superch 3/4" ft

$Ls = 100'$
 $\theta_s = 7^{\circ} 30' 00''$
 $L.T. = 66.73'$
 $S.T. = 33.39'$
 $L.C. = 99.92'$

Clears Assumed 10-15 yr. freq. H.W. 4.5'

PROPOSED STRUCTURE	
TYPE:	Continuous reinf. concrete slab with reinf. concrete substructure
SPANS:	44'-55'-44'-4/8 brgs.
ROADWAY:	28' ft flt of 1'-9" safety curbs
LOAD FREQ. RATING:	CF-130-51
SKEW:	None
SURF COURSE:	Bituminous
APPR. SLABS:	A5-4-47
ALIGNMENT:	15° Curve Right
SUPER ELEV:	3/4" per foot

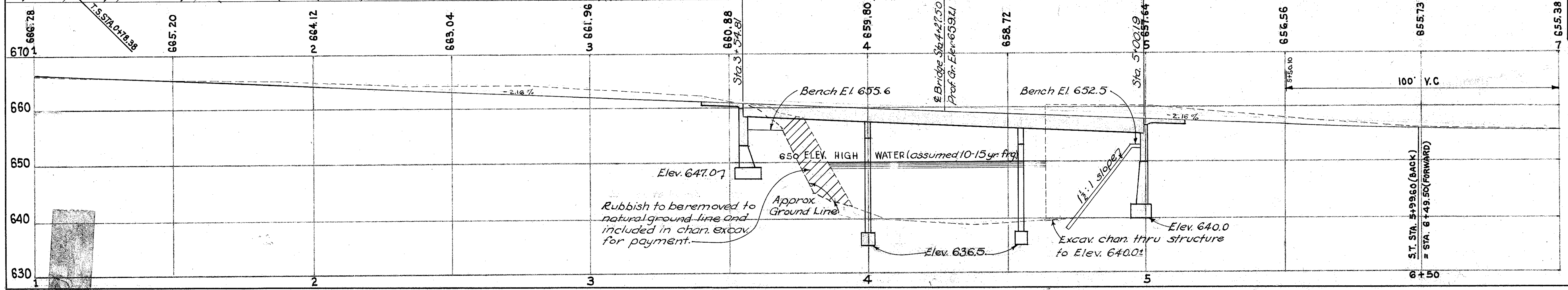

STATE OF OHIO
 DEPARTMENT OF HIGHWAYS
 BUREAU OF BRIDGES

SITE PLAN
 Bridge No LA-615-02
 OVER EAST BRANCH CHAGRIN RIVER
 LAKE COUNTY
 Scale 1" = 20' STA. 4+27.50

TOPOGRAPHY	PROPOSED WORK
SURVEY DR. BY	DESIGN DR. BY
CH'KD.	REVIEW DATE

BFG 9/23/54