

21-5-54

H-13

3

STATE OF OHIO DEPARTMENT OF HIGHWAYS

LAK-615-0.06 LAKE COUNTY KIRTLAND TOWNSHIP

FED. RD. DIVISION	STATE	PROJECT	FISCAL YEAR
2	OHIO	H.I.F.	1954

LAK-615-0.06
LAKE COUNTY

CONVENTIONAL SIGNS

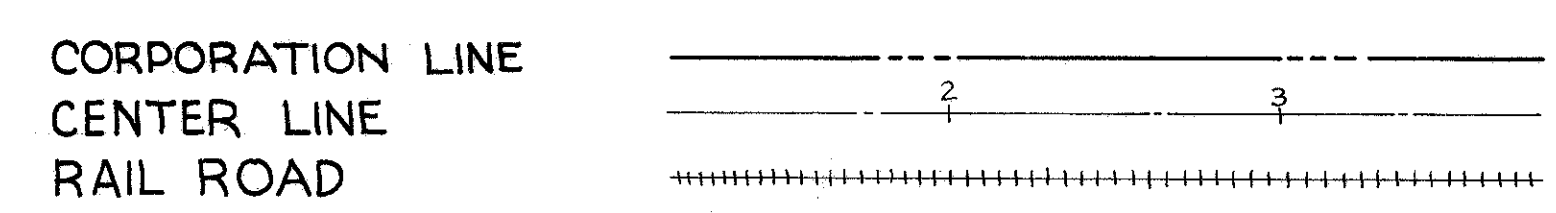

INDEX OF SHEETS

TITLE SHEET	1
TYPICAL SECTION & GENERAL NOTES	2
PAVEMENT CALCULATIONS & GENERAL SUMMARY	3
PLAN SHEET	4
DETAIL SHEET	5
CROSS SECTIONS	6 TO 9
BRIDGE PLANS	10 TO 16

LINE DATA

BEGIN PROJECT	STA. 0+10
END PROJECT	STA. 8+00
TOTAL	790.00 LIN. FT.
MINUS SHORT STA.	49.90' LIN. FT.
TOTAL LENGTH OF PROJECT	740.10 LIN. FT. OR 0.140 MILES

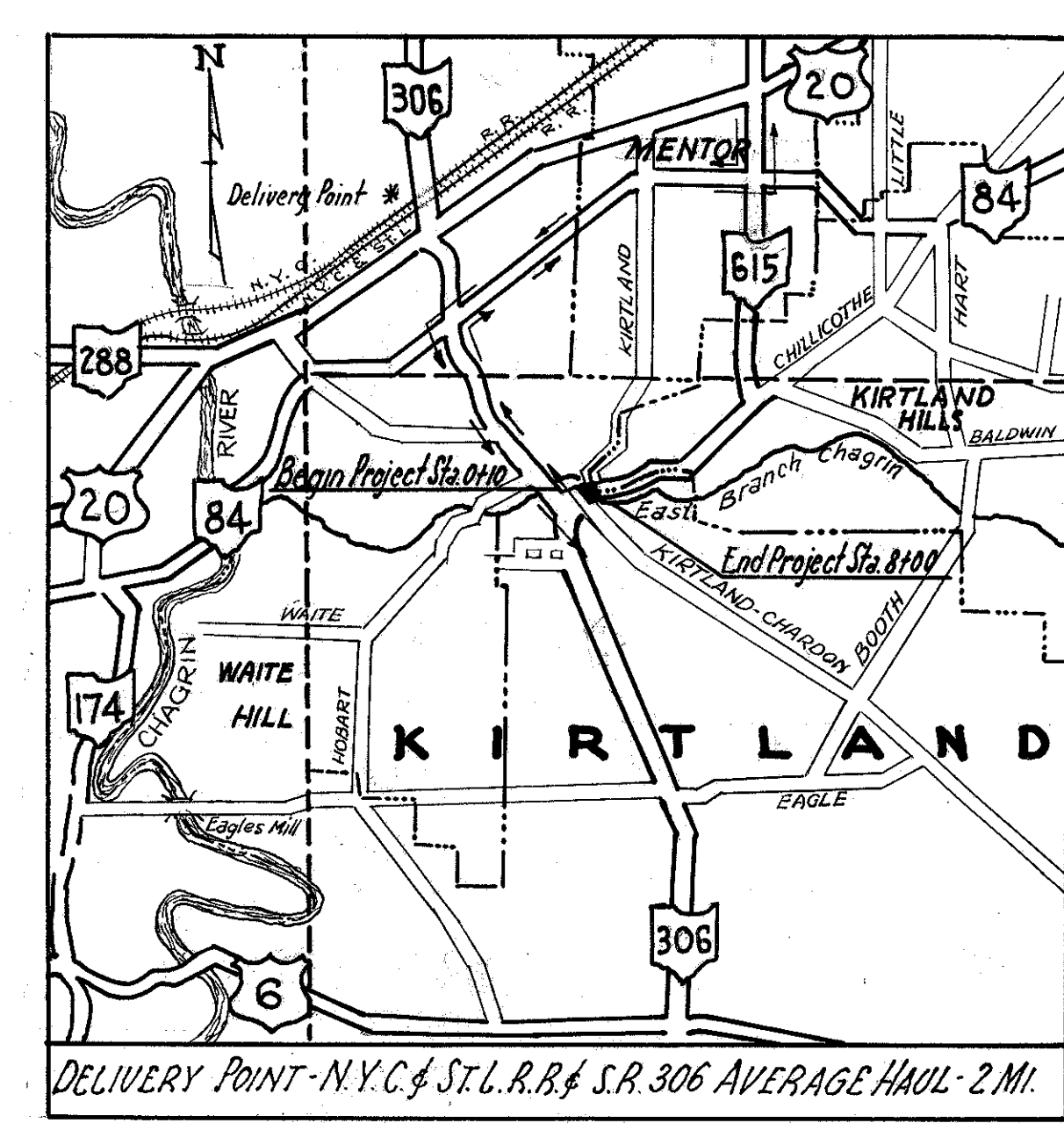

LOCATION PLAN

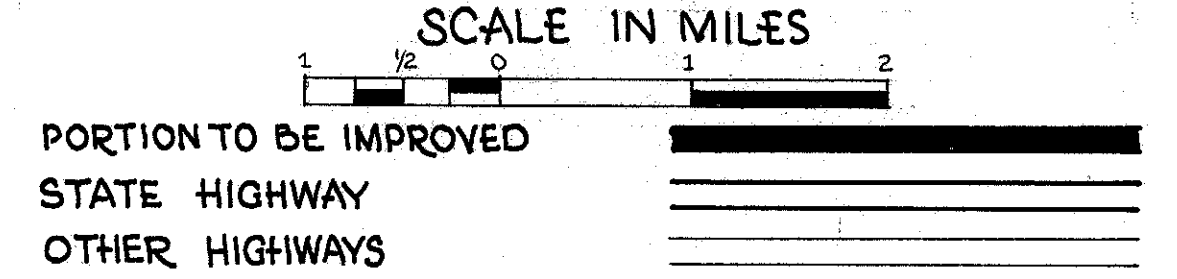

SCALES

PLAN	1" = 50'
PROFILE	1" = 5'
VER. PROFILE	1" = 50'

The standard specifications of The State of Ohio Department of Highways, including changes and supplemental specifications listed in the proposal shall govern this improvement

I hereby approve these plans and declare that the making of this improvement will require the closing to traffic of the highway except as noted on sheet 2, and that detours will be provided as indicated on the plans.

The right of way for this improvement will be provided by the State of Ohio.

Approved *Arthur A. Endrey*
Date 11-5-54 Division Deputy Director

Approved *John J. Heesley*
Date 11-3-54 Deputy Director of Planning & Programming

Approved *Richard Orth*
Date 12-28-54 Engineer of Bridges

Approved *W. B. Johnson*
Date 11-2-54 Engineer of Location & Design

Approved *W. B. Johnson*
Date 11-2-54 Deputy Director of Design & Construction

Approved *P. J. Schaubli*
Date 11-1-54 First Assistant Director

Approved *S. J. ...*
Date 11-4-54 Director of Highways.

CONSTRUCTION BUREAU
APR 12 1957
GROUND PHOTOS

STANDARD DRAWINGS			
RI-1	6-1-53	I-8CB.1-2A	85-1-52
G-707	1-2-53	I-15-No.1	2-2-53
T-35	10-1-52	I-15-No.2	2-2-53
<i>A5-3-47</i>	<i>7-27-49</i>	L-3	4-1-50
<i>A5-4-47</i>	<i>3-15-48</i>	L-3-A	4-1-50
S27PC-2			
E1234&5	2-20-45		

SUPPLEMENTAL SPECIFICATIONS			
B-119	R-12-14-53	L-209.12	7-17-54
L-109.12	1-24-53		
M-103.14	7-31-50		
CE-107	5-21-53		
7-171.19	R-3-19-53		
M-101.7	1-24-53		

FILE NO.	LAKE COUNTY	LAK. 615 - 0.06	1954
	DATE OF LETTING		
	CONTRACT NO.		