

RETAINING WALL ELEVATION

- NOTES:
1. For Section A-A, Contraction Joint Detail and Rustication Groove Detail, See Sheet 2/2.
 2. 6" Non-Perforated Pipe Shall be Outletted into the Proposed Catch Basin at Sta.10+77, 13.0' Right. See Roadway Plans for Details. All Labor and Materials Needed to Install the Non-Perforated Corrugated Pipe are Included With the Roadway Quantities for Payment.
 3. The Contractor Shall be Responsible for the Design, Installation and Subsequent Removal of a Temporary Shoring System to Support the Sides of Excavation and Thereby Protect the Existing Wood Frame House From Damage. A Plan of This Temporary Shoring System Shall be Submitted to the Engineer for Approval at Least Thirty (30) Days Prior to Excavating the Retaining Wall Footing.

* - Measured Along Face of Wall.
** - See Roadway Typical Sections for Grading.

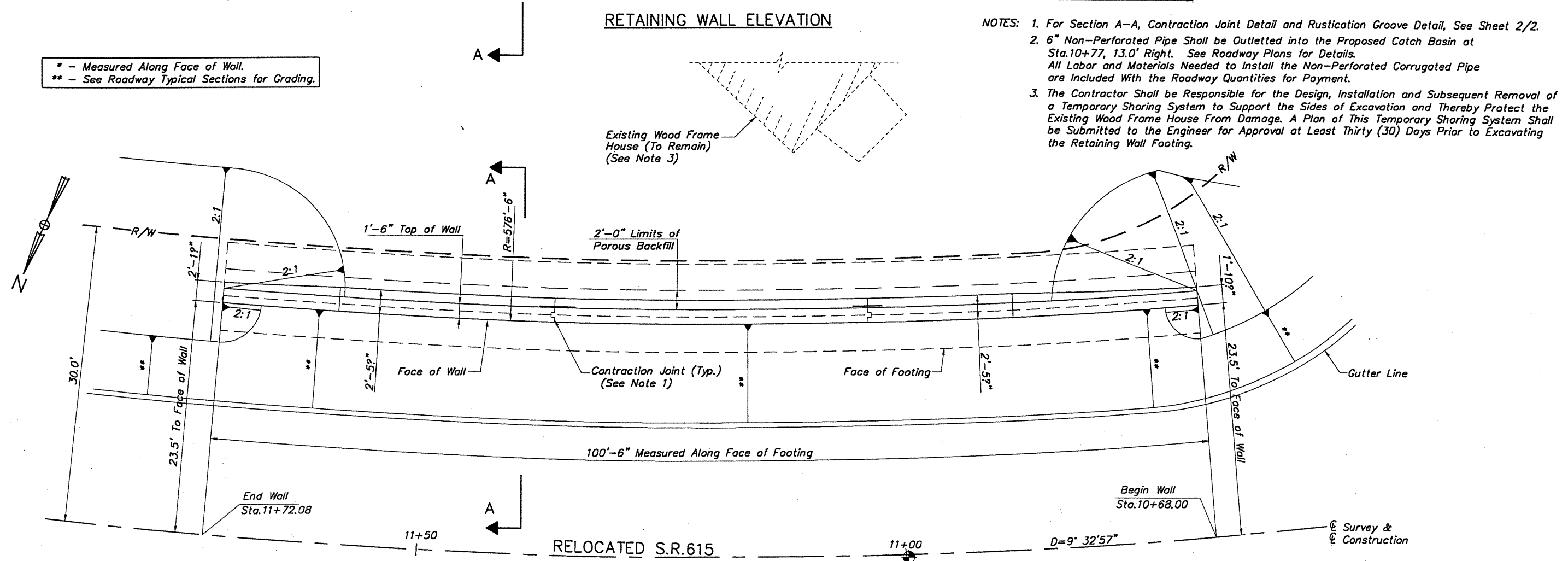

RETAINING WALL PLAN

4. Notation: Typ.-Typical; T.-Top; Bot.-Bottom; F.F.-Far Face; E.F.-Each Face; Min.-Minimum; Sta.-Station.

H:\CT\97260\CAD\97260R01.DWG PLOT SCALE 1:64