

PIER 2 PLAN

- NOTES:
1. BRIDGE SEAT REINFORCING: Reinforcing Steel in the Vicinity the Bridge Seat Shall be Accurately Placed to Avoid Interference with the Drilling of Anchor Holes or the Pre-Setting of Bearing Anchors.
  2. For Existing Pier Removal Information, See Item 202 General Note on Sheet 2/19.
  3. Pier Footing Excavation: Any Excavation Done Beyond the Established Pier Footing Excavation Limits Shall be Filled With Class F Concrete Backfill at the Contractor's Expense.
  4. Repair of Damaged River Bottom: All Holes or Trenches in the Shale River Bottom Resulting From Construction or Removal Activities Performed Near the Pier Footing Shall be Filled With Class F Concrete Backfill at the Contractor's Expense.
  5. NOTATION: C.J. - Construction Joint; EL. - Elevation; Min. - Minimum; Typ. - Typical; Clr. - Clear; Sta. - Station; Brg. - Bearing; E.F. - Each Face.

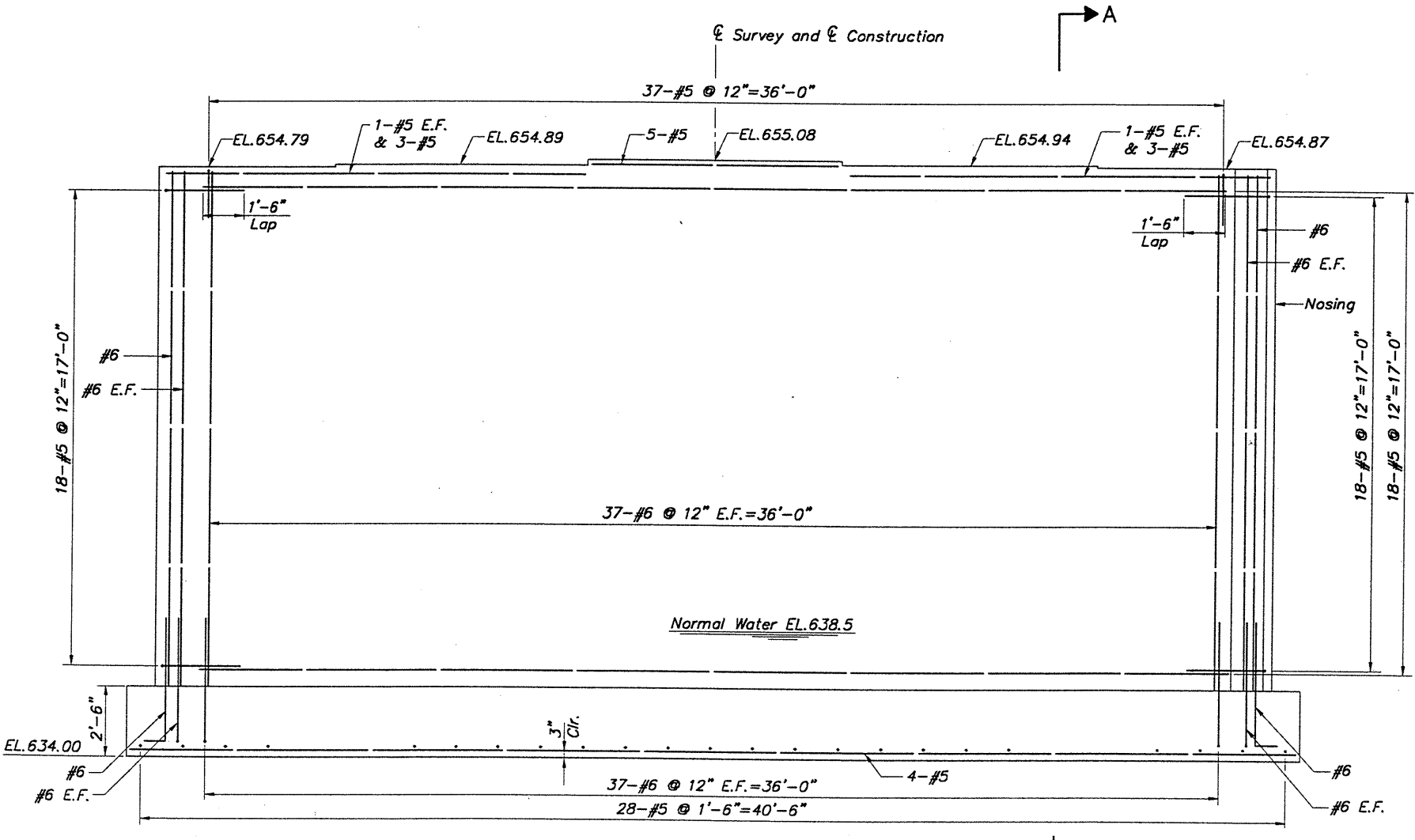

PIER 2 ELEVATION

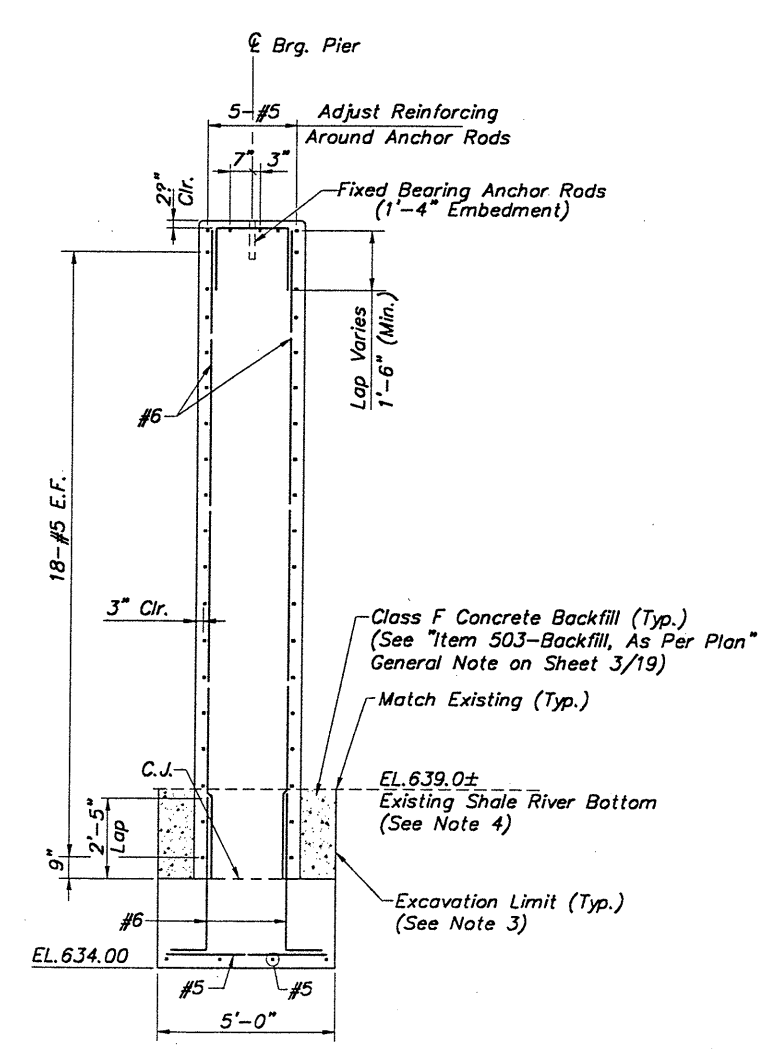

SECTION A-A

H:\CT\97260\CAD\97260P15.DWG PLOT SCALE 1:32

DESIGNED J.P.R.	CHECKED I.A.S.
DRAWN R.L.B.	REVISION R.L.B.
REVIEWED J.E.A.	DATE 10/18/99
STRUCTURE FILE NUMBER	
PIER 2 PLAN AND ELEVATION BRIDGE NO. LAK-615-0029 OVER EAST BRANCH CHAGRIN RIVER	
LAK-615-0.00	
9 / 19	
<div style="border: 1px solid black; border-radius: 50%; width: 30px; height: 30px; display: flex; align-items: center; justify-content: center;"> <span style="font-size: 12px; margin-right: 2px;">83</span> <span style="font-size: 12px;">95</span> </div>	