

PIER 2 PLAN

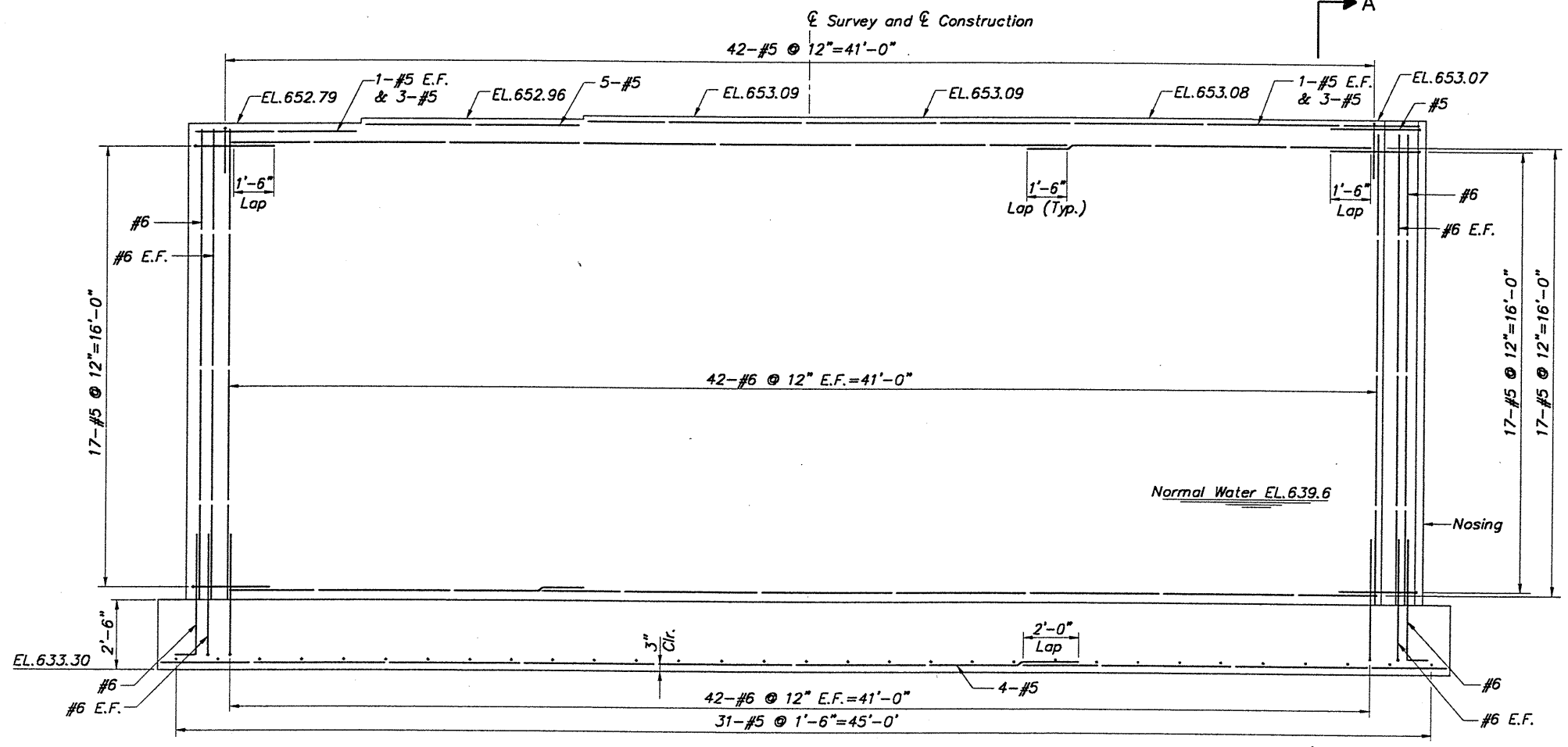

PIER 2 ELEVATION

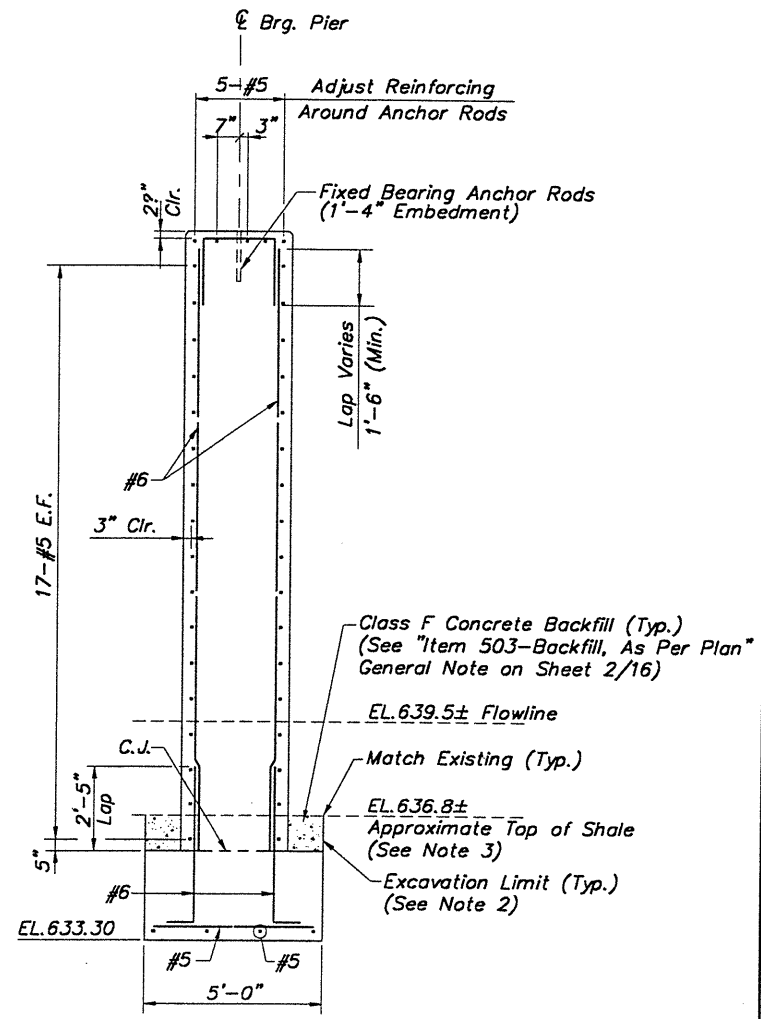

SECTION A-A

NOTES:

1. BRIDGE SEAT REINFORCING: Reinforcing Steel in the Vicinity of the Bridge Seat Shall be Accurately Placed to Avoid Interference with the Drilling of Anchor Holes or the Pre-Setting of Bearing Anchors.

2. Pier Footing Excavation: Any Excavation Done Beyond the Established Pier Footing Excavation Limits Shall be Filled With Class F Concrete Backfill at the Contractor's Expense.
 3. Repair of Damaged River Bottom: All Holes or Trenches in the Shale River Bottom Resulting From Construction Activities Performed Near the Pier Footing Shall be Filled With Class F Concrete Backfill at the Contractor's Expense.

4. NOTATION: C.J. - Construction Joint; EL. - Elevation; Min. - Minimum; Typ. - Typical; Clr. - Clear; Sta. - Station; Brg. - Bearing; E.F. - Each Face.

H:\CT\97260\CAD\97260B30.DWG PLOT SCALE 1:32

PIER 2 PLAN AND ELEVATION
 KIRTLAND CHARDON ROAD BRIDGE
 OVER EAST BRANCH CHAGRIN RIVER

DESIGNED	J.P.R.	CHECKED	I.A.S.
DRAWN	R.L.B.	REVISION	R.L.B.
DATE	12/30/99	STRUCTURE FILE NUMBER	
REVIEWED	J.E.A.		

LAK-615-0.00

9 / 16

67
95

CT Consultants, Inc.
 Engineers - Architects - Planners
 10000 - 10000 - 10000 - 10000