

No.	REVISIONS	By	Date
1	Change Type "T" To Type "A"	RLB	2/28/00

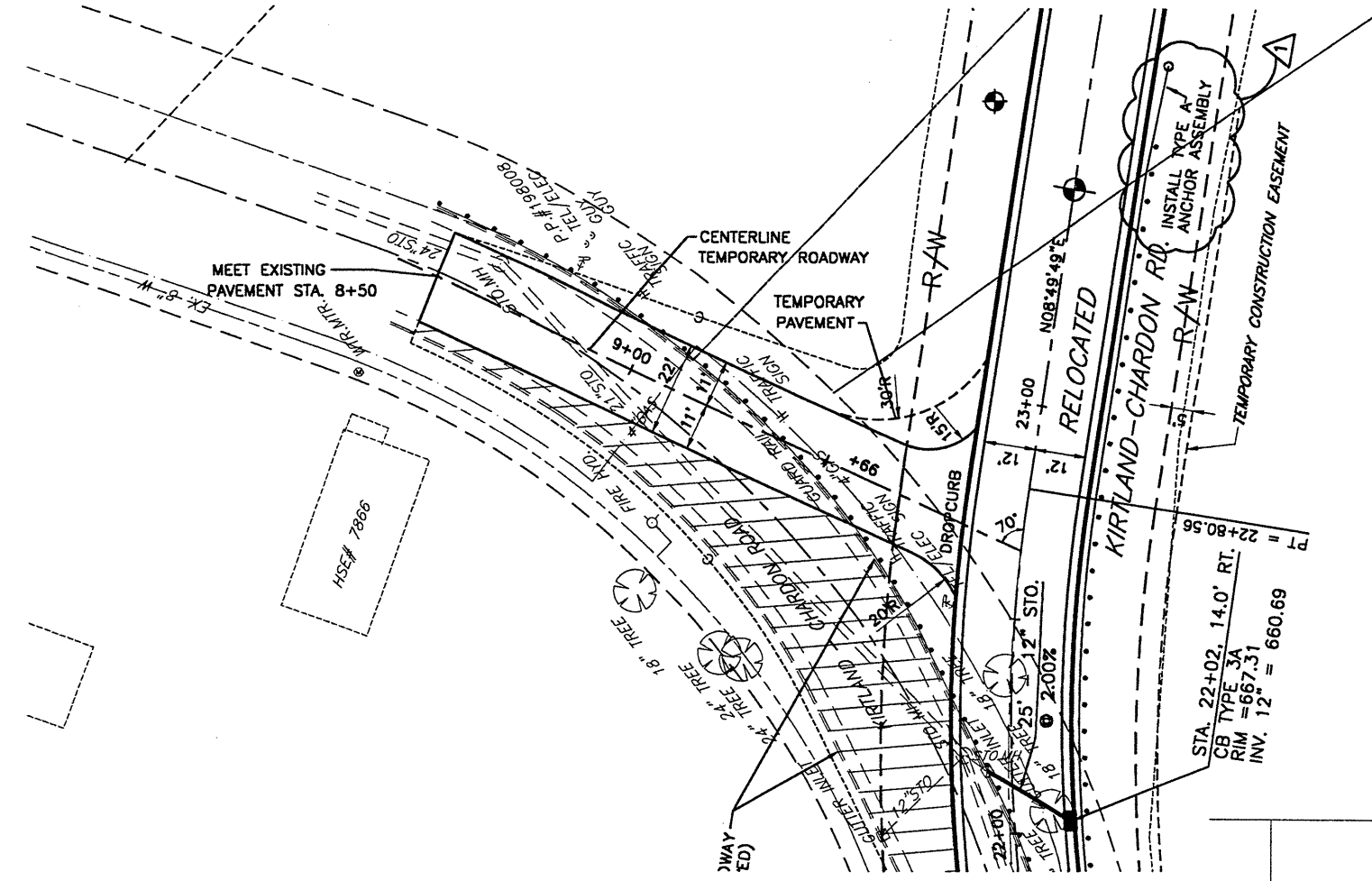
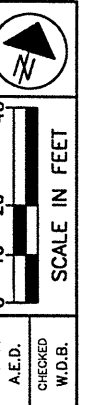

PAVEMENT COMPOSITION FOR TEMPORARY ROADWAY SHALL BE SAME AS USED FOR RELOCATED KIRTLAND-CHARDON ROAD. ( SEE MAINTENANCE OF TRAFFIC PLANS T14 & T15 )

RELOCATED DRIVEWAY TO BE DEVELOPED BY USING THE ROADWAY USED FOR MAINTENANCE OF TRAFFIC AS DIRECTED BY THE ENGINEER.

Station	8+00	8+25	8+50	8+75	9+00	9+25	9+50	9+75	10+00
Elevation		656.9	657.2		659.4	660.81	661.92	662.75	663.02
Notes		MEET EXISTING STA. 8+50			GRADE BREAK NO CURVE				RELOCATED KIRTLAND-CHARDON ROAD
Grades		4.40%			6.2%		2.5%		
Curve Data						80.00' VC	PVI STA = 9+40	PVI ELEV = 661.88	
Vertical Curve									
Other					PVC STA. 9+00	PVC EL. 659.40	PVI STA. 9+40	PVI EL. 662.88	PVT STA. 9+80
									PVT EL. 662.88

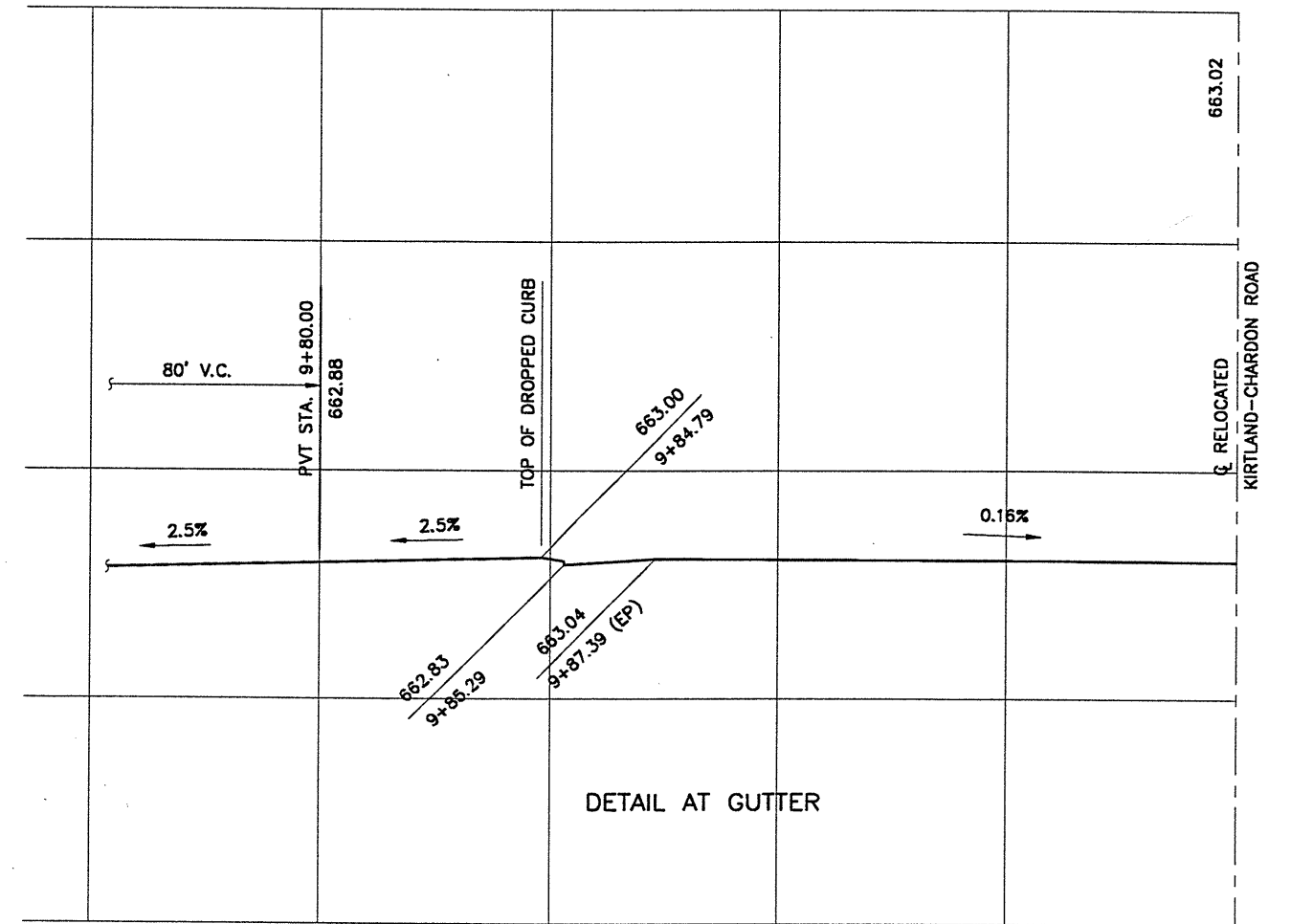

DATE: 1-03-2000 - TIME: 13:26 - H:\ct\97260\sdk\DRPROF.dwg

RELOCATED DRIVE @ STA. 23+66 (KIRTLAND CHARDON ROAD)

LAK - 615 - 0.00