

LAKE COUNTY
LAK- 608-03.35

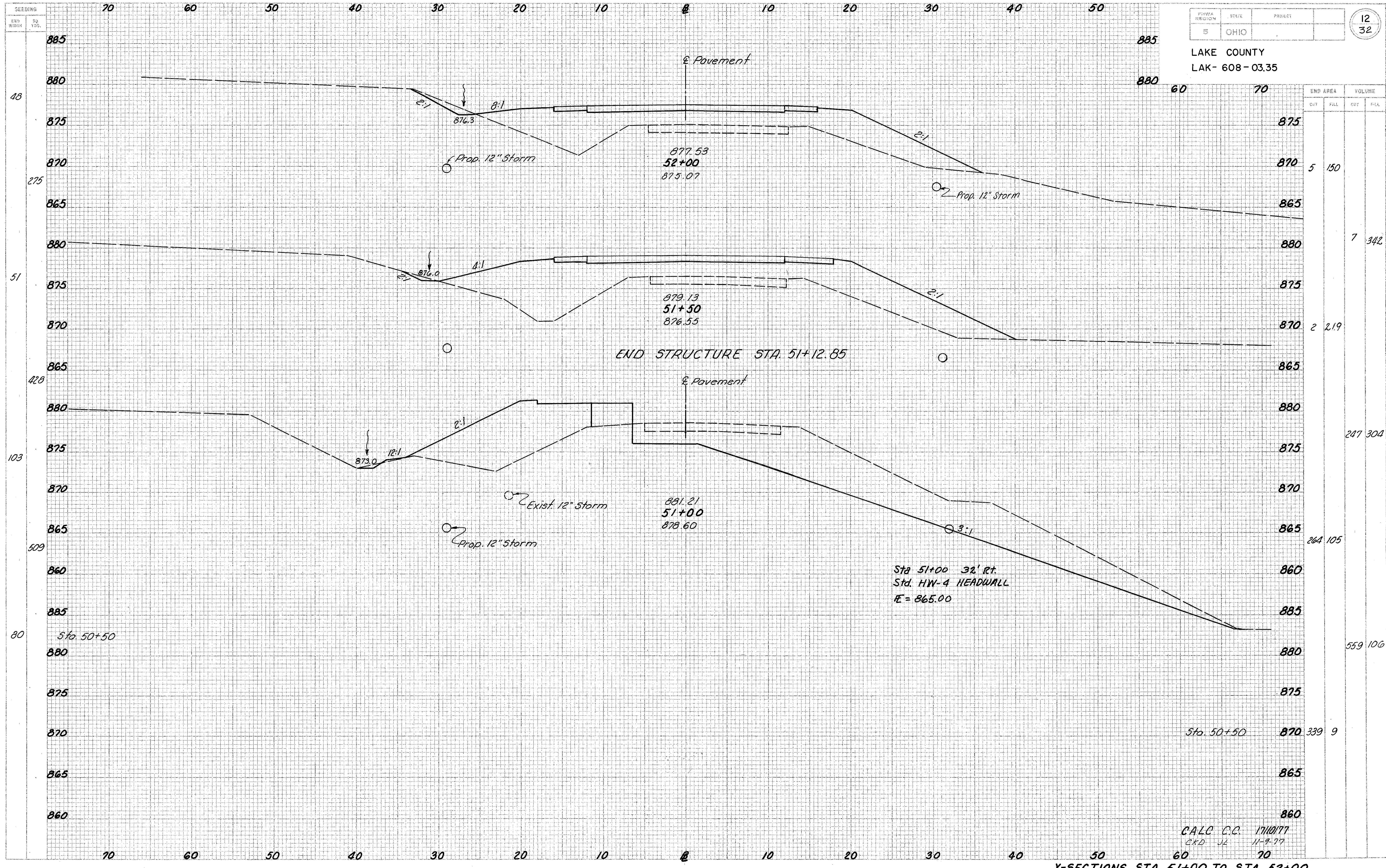

Sta 51+00 32' Rt.
Std. HW-4 HEADWALL
E = 865.00

END STRUCTURE STA. 51+12.85

CALC C.C. 17/10/77
CKD JL 11-9-77

X-SECTIONS STA. 51+00 TO STA. 52+00