

REINFORCING STEEL LIST

| | | |
|-------------------|-------|---------|
| FED. RD. DIVISION | STATE | PROJECT |
| 2 | OHIO | |

LAK-6-9.84

| SUPERSTRUCTURE | | | | | | | | | | | PIERS | | | | | | | | | | | ABUTMENTS | | | | | | | | | | | | | | | | | | | | | | | | | | | | | |
|----------------|--|--|--|-------|---------|--------|------|-----------|-------|-------|-------|---|-------|------|------|--|-------|--------|--------|------|-----------|-----------|--------|---|---------|-------|------|------|--|-------|--------|--------|------|--------|-----------|-------|---|---|------|---|---|--|----|---------|------|-----|--|--|--|--|--|
| MARK | | | | TOTAL | LENGTH | WEIGHT | TYPE | A | B | C | D | R | MARK | FWD. | REAR | | TOTAL | LENGTH | WEIGHT | TYPE | A | B | C | D | R | MARK | FWD. | REAR | | TOTAL | LENGTH | WEIGHT | TYPE | A | B | C | D | R | | | | | | | | | | | | | |
| F1136 | | | | 82 | 25'-10" | 11255 | ST. | | | | | | P1001 | 8 | 8 | | 16 | 23'-4" | 1607 | ST. | | | | | | T1001 | 8 | 8 | | 16 | 22'-4" | 1578 | ST. | | | | | | | | | | | | | | | | | | |
| G1136 | | | | 40 | 13'-9" | 2922 | ST. | | | | | | | | | | | | | | | | | | | | | | | | | | | | | | | | | | | | | | | | | | | | |
| H1136 | | | | 40 | 10'-2" | 2161 | ST. | | | | | | P901 | 8 | 8 | | 16 | 21'-8" | 1179 | ST. | | | | | | D801 | 29 | 29 | | 58 | 7'-0" | 1084 | 7 | 1'-1" | 4'-9" | 6" | | | T801 | 8 | 8 | | 16 | 26'-10" | 1146 | ST. | | | | | |
| A1036 | | | | 129 | 41'-10" | 23221 | ST. | | | | | | P501 | 4 | 4 | | 8 | 21'-1" | 176 | ST. | | | | | | T501 | 8 | 8 | | 16 | 26'-4" | 439 | ST. | | | | | | | | | | | | | | | | | | |
| B1036 | | | | 36 | 29'-4" | 4544 | 6 | 27'-11" | | | | | P502 | 36 | 36 | | 72 | 9'-1" | 682 | 3 | 2'-2" | 3'-1" | 7 1/2" | | | T502 | 78 | 78 | | 156 | 6'-10" | 1112 | 2 | 2'-11" | 2'-1" | 2'-1" | | | | | | | | | | | | | | | |
| C1036 | | | | 36 | 27'-3" | 4221 | 6 | 25'-10" | | | | | P503 | 2 | 2 | | 4 | 8'-11" | 37 | 3 | 2'-0" | 3'-1" | 7 1/2" | | | T503 | 4 | 4 | | 8 | 22'-1" | 184 | ST. | | | | | | | | | | | | | | | | | | |
| D1036 | | | | 18 | 26'-9" | 2072 | ST. | | | | | | P504 | 2 | 2 | | 4 | 4'-1" | 17 | 2 | 3'-1" | 7 1/2" | 7 1/2" | | | T504 | 6 | 6 | | 12 | 10'-8" | 134 | 2 | 11" | 5'-0" | 5'-0" | | | | | | | | | | | | | | | |
| E1036 | | | | 18 | 22'-6" | 1743 | ST. | | | | | | P505 | 4 | 4 | | 8 | 6'-4" | 53 | 5 | 1'-7" | 2'-0 1/4" | | | 11 1/2" | T505 | 29 | 29 | | 58 | 7'-11" | 479 | 2 | 1'-8" | 3'-3" | 3'-3" | | | | | | | | | | | | | | | |
| M601 | | | | 224 | 22'-9" | 7654 | ST. | | | | | | P401 | 20 | 20 | | 40 | 8'-0" | 214 | 1 | 2'-0 1/4" | 1'-9" | | | | T506 | 2 | 2 | | 4 | 3'-3" | 14 | ST. | | | | | | | | | | | | | | | | | | |
| J501 | | | | 82 | 25'-8" | 2195 | ST. | | | | | | | | | | | | | | | | | | | T507 | 4 | 4 | | 8 | 5'-3" | 44 | ST. | | | | | | | | | | | | | | | | | | |
| K501 | | | | 41 | 23'-6" | 1005 | ST. | | | | | | | | | | | | | | | | | | | T508 | 4 | 4 | | 8 | 5'-7" | 47 | ST. | | | | | | | | | | | | | | | | | | |
| M402 | | | | 208 | 3'-1" | 429 | 2 | 1'-3 1/2" | 1'-0" | 1'-0" | | | | | | | | | | | | | | | | T509 | 2 | 2 | | 4 | 3'-7" | 15 | ST. | | | | | | | | | | | | | | | | | | |
| N401 | | | | 240 | 22'-5" | 3594 | ST. | | | | | | | | | | | | | | | | | | | T401 | 16 | 16 | | 32 | 9'-2" | 196 | 1 | 1'-9" | 2'-7 1/2" | | | | | | | | | | | | | | | | |

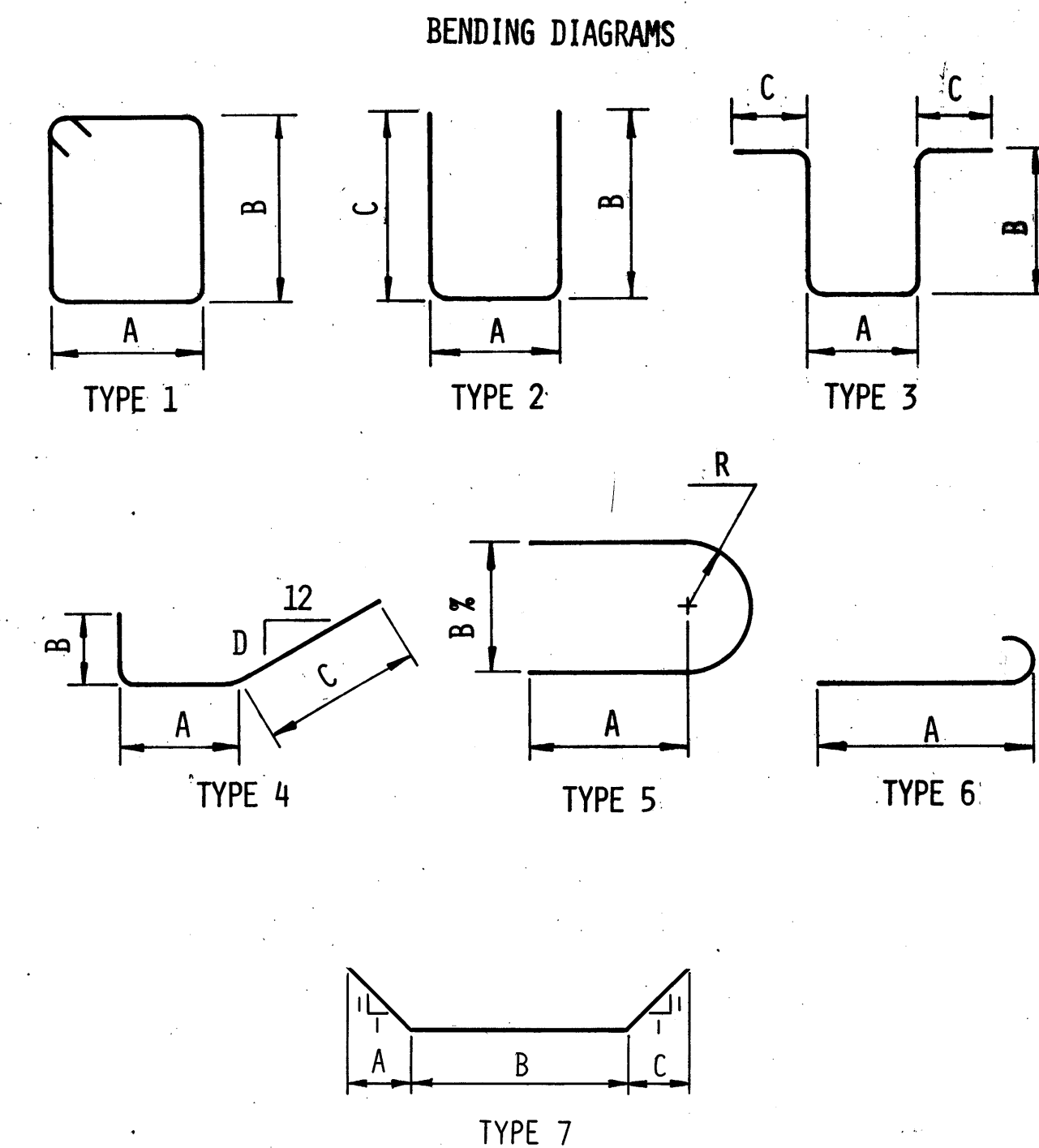

Refer to CMS Sections 106.03, 700, 709.01 through 709.05 and 709.05 and 709.08. Sufficient additional reinforcing steel shall be provided for sampling. Random samples shall be replaced in the structures by the additional steel, spliced in accordance with 509.08.

BAR SIZE IS INDICATED IN THE BAR MARK. THE FIRST DIGIT WHERE THREE DIGITS ARE USED, AND THE FIRST TWO DIGITS WHERE FOUR ARE USED, INDICATE THE BAR SIZE NUMBER. FOR EXAMPLE, A700 IS A NO. 7 SIZE BAR AND A1014 IS A NO. 10 SIZE.

R INDICATES INSIDE RADIUS, UNLESS OTHERWISE NOTED. "STD" WRITTEN IN PLACE OF A DIMENSION INDICATES A STANDARD BEND AT THE END OF THE BAR.

BAR DIMENSIONS SHOWN ARE OUT TO OUT, UNLESS OTHERWISE INDICATED.

GENERAL NOTES

REFERENCE shall be made to Standard Drawings CPA-1-71 dated 3-16-71 CPP-1-71 dated 3-16-71 DBR-1-71 dated 1-1-71 CS-1-71 sheets 1 and 2 dated 1-1-71 and to Supplemental Specifications 808 and 836 dated 1-1-71.

ABUTMENT EXCAVATION QUANTITY, in addition to 503.11, includes the removal of embankment above the bench.

DESIGN SPECIFICATIONS: This structure conforms to "Standard Specifications for Highway Bridges" adopted by the American Association of State Highway Officials, 1969, including the Ohio "Supplement" to these specifications.

PILES shall be driven to a minimum bearing capacity of 32 tons per pile for the abutments and 40 tons per pile for the piers.

DESIGN DATA:

Design Loading - HS20-44
Concrete Class C - unit stress 1200 p.s.i. for superstructure
unit stress 1333 p.s.i. for substructure

FOR REMOVAL of remainder of original structure on main alignment, see Roadway Plans.

STANDARD DRAWING AS-1-72 modified as follows: (a.) Change clearance for top reinforcing steel to 3" from 2".

REINFORCING STEEL: ASTM A615, A616 or A617 - unit stress 20,000 p.s.i.

REMOVAL OF STRUCTURE: When no longer needed to maintain traffic the existing structure shall be removed. The following components are to be salvaged and stored for re-use as follows:

- Structural Steel
- 9 ea. 24 WF 84 Steel Beams 49'-9" Long
- 28 ea. 10 I 25.4 Steel Diaphragms 2'-11 1/2" Long
- 18 ea. Steel Guardrail posts with brackets attached

The above shall be hauled by the Contractor to the following location which is approximately 36 miles from the construction site:

Division 4 Yard
705 Oakwood Street
Ravenna, Ohio 44266

ESTIMATED QUANTITIES

| ITEM | TOTAL | UNIT | DESCRIPTION | ABUT | PIER | SUPER | GENERAL | AS-BUILT |
|---------|--------|----------|--|------|------|--------|----------|----------|
| 202 | Lump | Sum | Structure removed | | | | Lump Sum | |
| 404 | 33 | Cu. Yd. | Asphalt concrete, AC-20 | | | 33 | | |
| 503 | 108 | Cu. Yd. | Unclassified Excavation | 108 | | | | |
| 505 | Lump | Sum | Test Pile | | | | Lump Sum | |
| 507 | 1460 | Lin. Ft. | 14" Cast-in-place reinforced concrete piles | 560 | 900 | | | |
| 509 | 77,453 | Lbs. | Reinforcing Steel | | 3965 | 67016 | | |
| 511 | 329 | Cu. Yd. | Class C Concrete, Superstructure | | | 329 | | |
| 511 | 16 | Cu. Yd. | Class C Concrete, Pier caps | | 16 | | | |
| 511 | 53 | Cu. Yd. | Class C Concrete, Abutments | 53 | | | | |
| 517 | 239.02 | Lin. Ft. | Railing (Double deep Railing with steel posts and bolts) | | | 239.02 | | |
| 518 | 17 | Cu. Yd. | Porous backfill | 17 | | | | |
| 601 | 446 | Sq. Yd. | Crushed aggregate slope protection | | | | 446 | |
| 808 | 329 | Units | Chemical admixture for concrete, Type A, B, or D | | | 329 | | |
| Special | 234 | Sq. Ft. | Galvanized steel drip strip | | | 234 | | |
| Special | 18 | Cu. Yd. | Asphaltic protective course (See Proposal Note) | | | 18 | | |
| Special | 585 | Sq. Yd. | Membrane waterproofing, Liquid Type (See Proposal Note) | | | 585 | | |

| | | | | | | |
|---|-------|--------|---------|----------|---------|---------|
| STATE OF OHIO DEPARTMENT OF HIGHWAYS DIVISION OF DESIGN AND CONSTRUCTION BUREAU OF BRIDGES | | | | | | 2 / 6 |
| GENERAL NOTES, ESTIMATED QUANTITIES, REINFORCING STEEL LIST | | | | | | |
| BRIDGE NO. LAK-6-0990 OVER EAST BRANCH OF CHAGRIN RIVER | | | | | | |
| DESIGNED | DRAWN | TRACED | CHECKED | REVIEWED | DATE | REVISED |
| AGD. | | T.G.C. | J.D.R. | BFG | 8-25-72 | |