

FED. RD. DIVISION	STATE	PROJECT	TYPE FUNDS
2	OHIO	F-366 (1)	POST WAR

LAK - 6 - (3.60 - 3.76)  
LAKE COUNTY LAK - 174 - 1.50  
Approximately 6.5 miles East of Cleveland.

**EXISTING BRIDGE**  
 TYPE: High steel truss  
 SPAN: 100'-0" clear  
 RDWY: 15'-6"  
 SKEW: None  
 CONDITION: POOR  
 DATE BUILT:  
 LOADING: S-4.7  
 (To remain in place)

**PROPOSED STRUCTURE**  
 TYPE: Continuous steel girder with conc. deck and conc. substructure  
 SPAN: 84'-10 1/2" - 105'-84" % bearings  
 RDWY: 28' plus 2'-1" safety curbs  
 LOADING: S-20-4G  
 SKEW: 30° R.F.  
 SURFACE COURSE: Bituminous  
 APPROACH SLABS: As shown

Foundation design and foundation quantities are based on a study of rod soundings and soil sampling soundings made at the site. The sounding information may be inspected in the office of the Bureau of Bridges in Columbus or in an abridged form in the Division Office, but the State assumes no responsibility for the accuracy thereof.

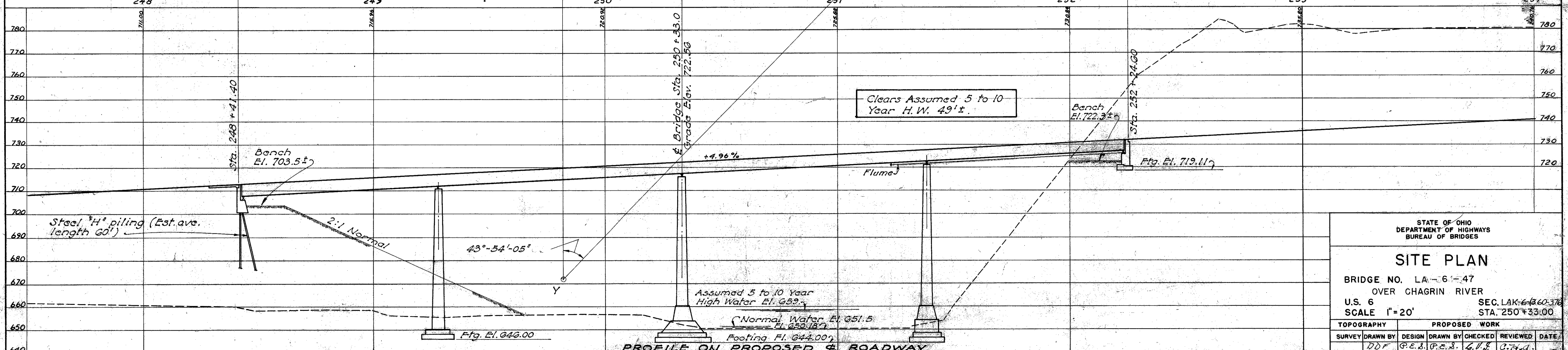
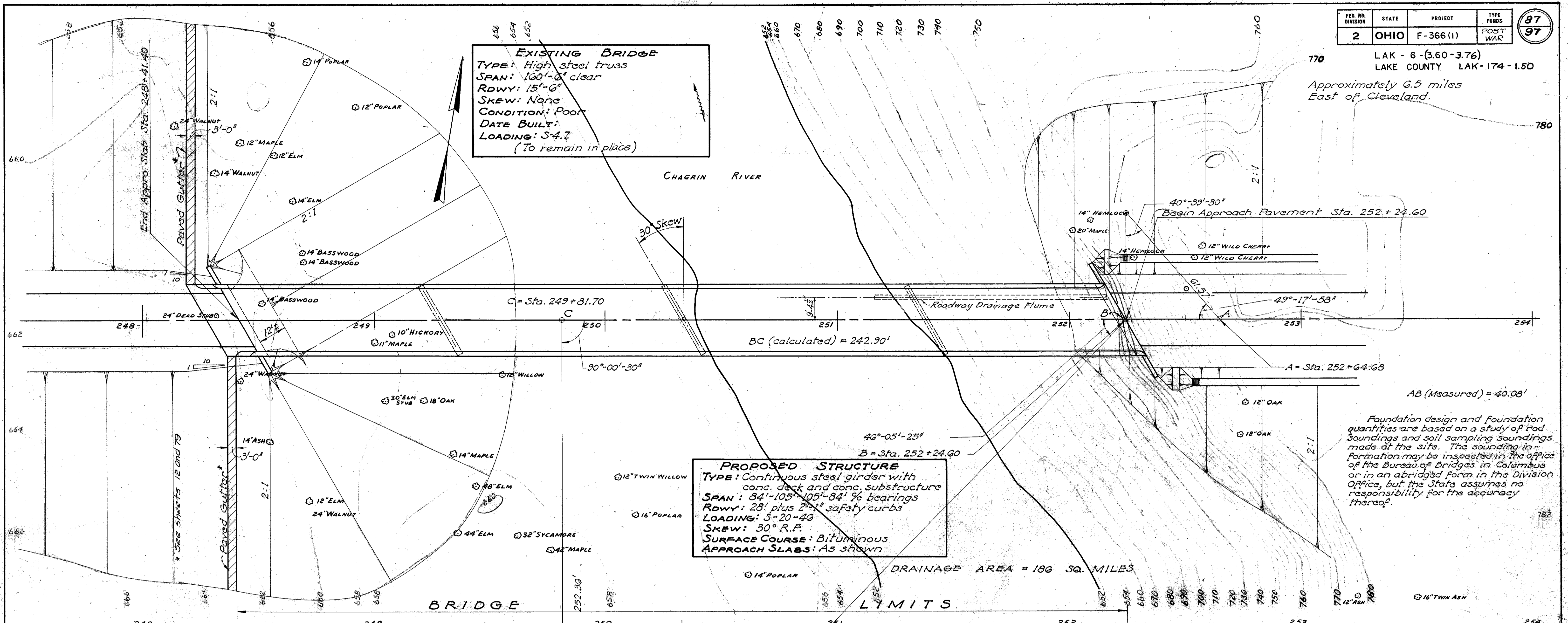

STATE OF OHIO DEPARTMENT OF HIGHWAYS BUREAU OF BRIDGES						
<b>SITE PLAN</b>						
BRIDGE NO. LA-6-47 OVER CHAGRIN RIVER						
U.S. 6			SEC. LAK-6-360-376			
SCALE 1"=20'			STA. 250+33.00			
TOPOGRAPHY	PROPOSED WORK					
SURVEY	DRAWN BY	DESIGN	DRAWN BY	CHECKED	REVIEWED	DATE
	DDF	G.E.S.	P.E.S.	G.V.S.	G.H.A.	4-11-50