

DRAINAGE STRUCTURE

STA. 211+68, REF. NO 1-C, SHEET NO 9

SCALE: 1" = 10'

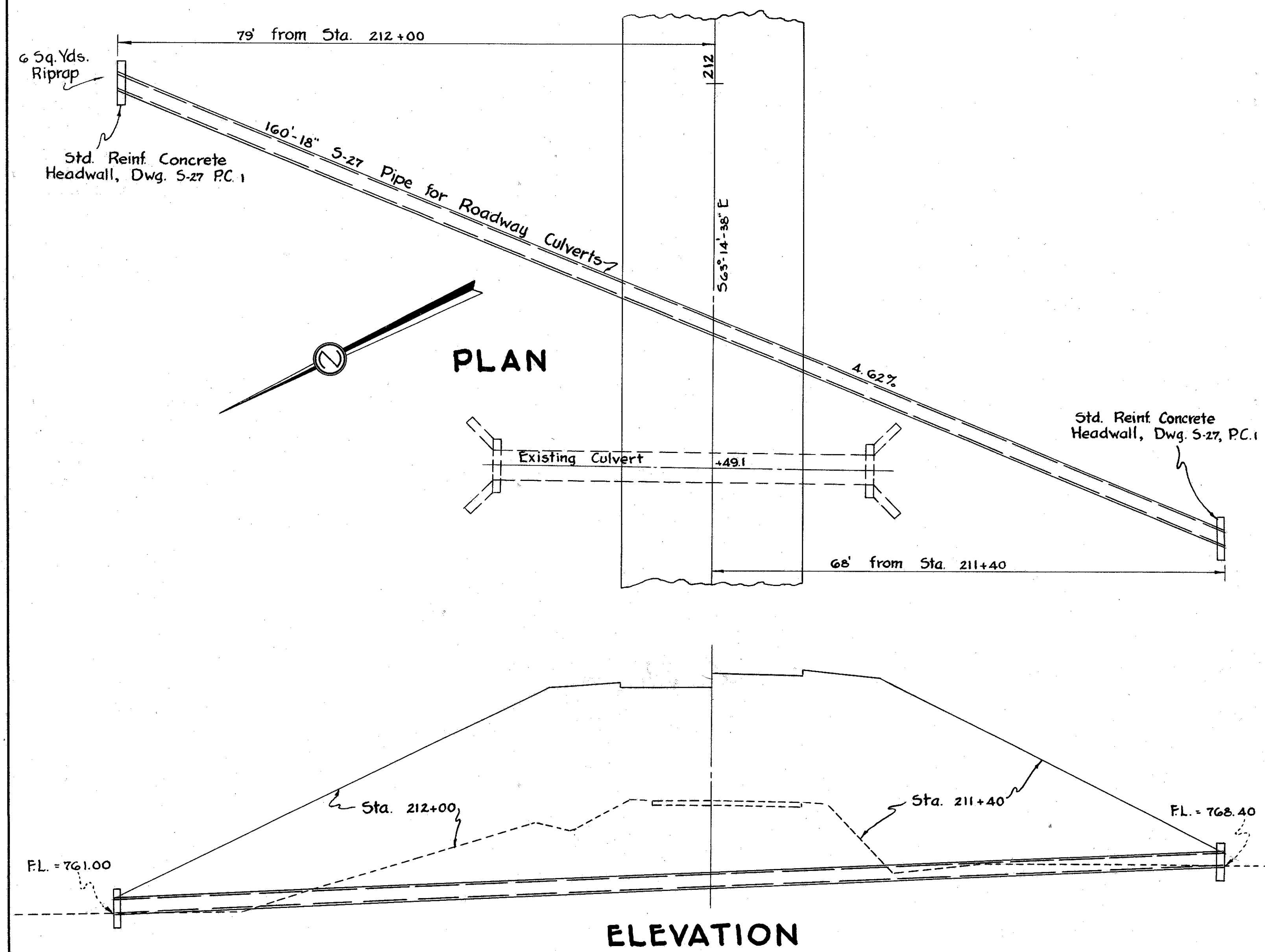

CULVERT DATA
 Type: Pipe Culvert, Drawing 5-27 PC. 3
 Size: 18" x 160"
 Work Required: (1) Remove existing culvert
 (2) Build two reinforced concrete headwalls, one on each side of road, and connect with 160' of pipe.

ESTIMATED QUANTITIES		
E-2	Excavation for Structures	75.0 Cu. Yds.
S-1	Concrete for Structures, Class "C"	2.0 Cu. Yds.
S-4	Reinforcing Steel	52 Lbs.
S-24	Removal of Existing Structures	Lump Sum
S-27	18" Pipe for Roadway Culverts (M-600)	160 Lin. Ft.
I-10	Riprap, Type "A" Grouted	6 Sq. Yds.

DRAINAGE STRUCTURE

STA. 272+02, REF. NO 1-C, SHEET NO 14

SCALE: 1" = 10'

FED. RD. DIVISION	STATE	FEDERAL AID PROJECT	TYPE FUNDS
2	OHIO	F-366 (1)	POST WAR

LAKE COUNTY
LAK.- G-(3.60-3.76)

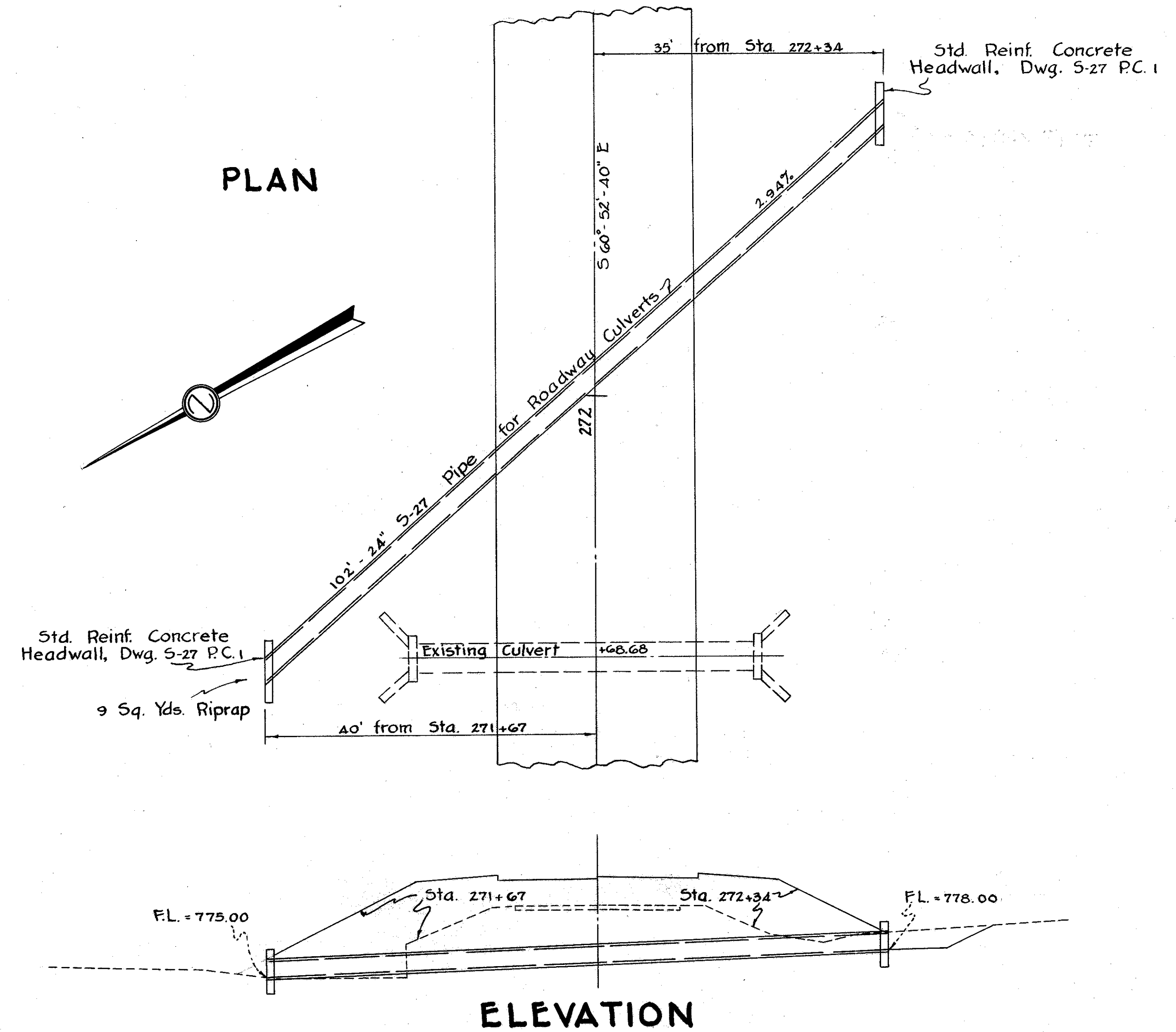

CULVERT DATA
 Type: Pipe Culvert, Drawing 5-27 PC. 3
 Size: 24" x 102"
 Work Required: (1) Remove existing culvert.
 (2) Build two reinforced concrete headwalls, one on each side of road, and connect with 102' of pipe.

ESTIMATED QUANTITIES		
E-2	Excavation for Structures	52 Cu. Yds.
S-1	Concrete for Structures, Class "C"	2.8 Cu. Yds.
S-4	Reinforcing Steel	64 Lbs.
S-24	Removal of Existing Structures	Lump Sum
S-27	24" Pipe for Roadway Culverts	102 Lin. Ft.
I-10	Riprap, Type "A" Grouted	9 Sq. Yds.