

# EXTRA AREA DETAIL

## INTERSECTION U.S. 6 AND S.R. 174

SCALE: 1"=20'

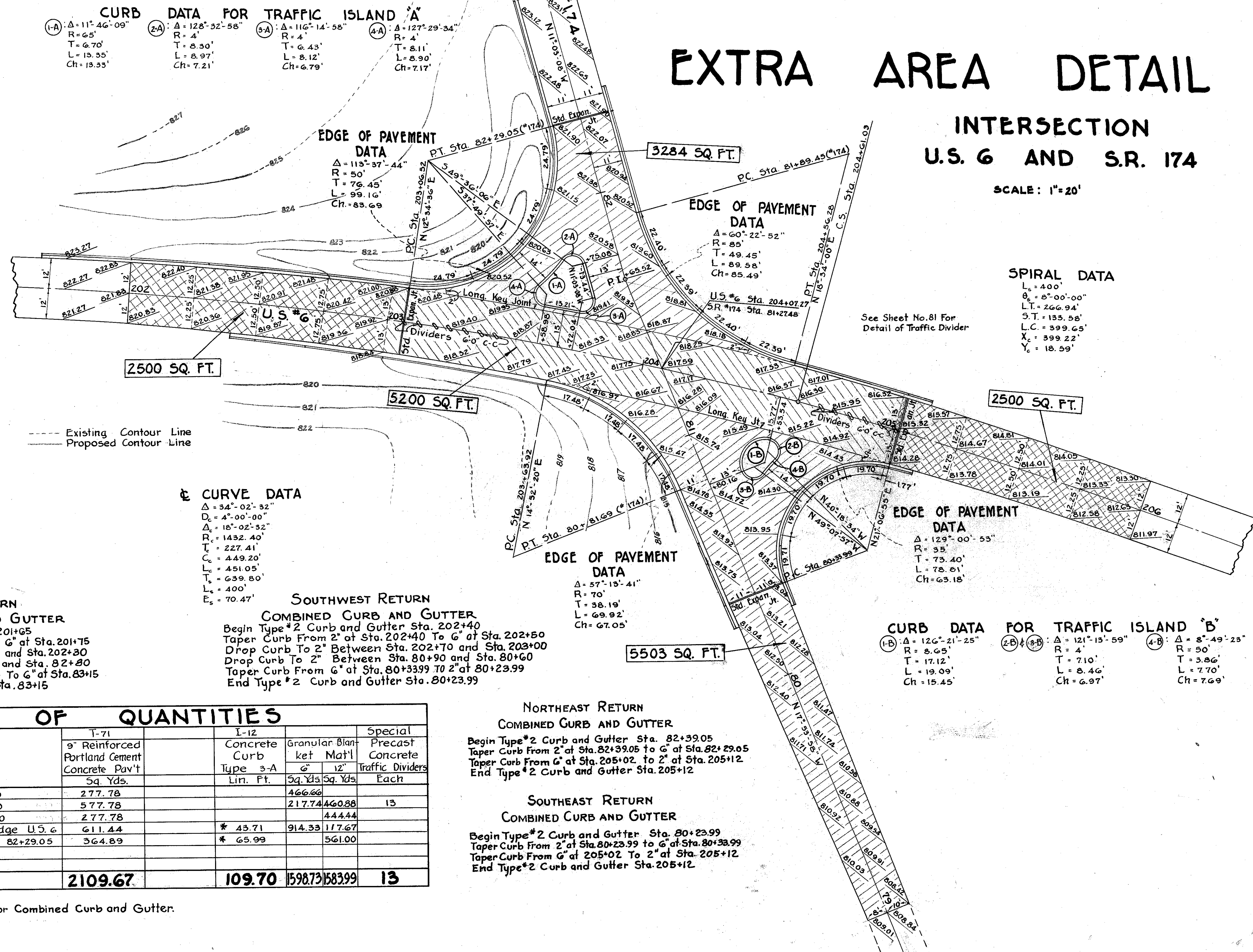

**EDGE OF PAVEMENT DATA**

Δ = 115°-37'-44" R = 50' T = 76.45' L = 99.16' Ch = 83.69

**EDGE OF PAVEMENT DATA**

Δ = 60°-22'-52" R = 85' T = 49.45' L = 89.58' Ch = 85.49'

**SPIRAL DATA**

L<sub>s</sub> = 400'  
θ<sub>s</sub> = 8°-00'-00"  
L.T. = 266.94'  
S.T. = 133.58'  
L.C. = 399.65'  
X<sub>c</sub> = 399.22'  
Y<sub>c</sub> = 18.59'

**CURVE DATA**

Δ = 34°-02'-32" D<sub>c</sub> = 4'-00'-00" Δ<sub>c</sub> = 18°-02'-52" R<sub>c</sub> = 1432.40' T<sub>c</sub> = 227.41' L<sub>c</sub> = 449.20' T<sub>c</sub> = 451.05' L<sub>c</sub> = 639.80' L<sub>s</sub> = 400' E<sub>s</sub> = 70.47'

**NORTHWEST RETURN  
COMBINED CURB AND GUTTER**  
Begin Type #2 Curb and Gutter Sta. 201+65  
Taper Curb From 2" at Sta. 201+65 To 6" at Sta. 201+75  
Drop Curb To 2" Between Sta. 202+00 and Sta. 202+30  
Drop Curb To 2" Between Sta. 82+50 and Sta. 82+80  
Taper Curb From 6" at Sta. 83+05 To 6" at Sta. 83+15  
End Type #2 Curb and Gutter at Sta. 83+15

**SOUTHWEST RETURN  
COMBINED CURB AND GUTTER**  
Begin Type #2 Curb and Gutter Sta. 202+40  
Taper Curb From 2" at Sta. 202+40 To 6" at Sta. 202+50  
Drop Curb To 2" Between Sta. 202+70 and Sta. 203+00  
Drop Curb To 2" Between Sta. 80+70 and Sta. 80+60  
Taper Curb From 6" at Sta. 80+3399 To 2" at 80+23.99  
End Type #2 Curb and Gutter Sta. 80+23.99

**NORTHEAST RETURN  
COMBINED CURB AND GUTTER**  
Begin Type #2 Curb and Gutter Sta. 82+39.05  
Taper Curb From 2" at Sta. 82+39.05 To 6" at Sta. 82+29.05  
Taper Curb From 6" at Sta. 205+02. to 2" at Sta. 205+12  
End Type #2 Curb and Gutter Sta. 205+12

**SOUTHEAST RETURN  
COMBINED CURB AND GUTTER**  
Begin Type #2 Curb and Gutter Sta. 80+23.99  
Taper Curb From 2" at Sta. 80+23.99 to 6" at Sta. 80+33.99  
Taper Curb From 6" at 205+02 To 2" at Sta. 205+12  
End Type #2 Curb and Gutter Sta. 205+12

Location	T-71		I-12		Special	
	9" Reinforced Portland Cement Concrete Pav't	Sq. Yds.	Concrete Curb Type 3-A	Granular Blanket Mat'l	Precast Concrete Traffic Dividers	Each
U.S. 6, Sta. 202+00 to Sta. 203+00	277.78			466.66		
U.S. 6, Sta. 203+00 to Sta. 205+00	577.78			217.74	460.88	13
U.S. 6, Sta. 205+00 to Sta. 206+00	277.78				444.44	
S.R. 174, Sta. 79+00 to South Edge U.S. 6	611.44		* 43.71	914.33	117.67	
S.R. 174, North Edge U.S. 6 to Sta. 82+29.05	364.89		* 65.99		561.00	
<b>TOTALS</b>	<b>2109.67</b>		<b>109.70</b>	<b>1598.73</b>	<b>1583.99</b>	<b>13</b>

\* Traffic Islands  
See Sheet #9 For Pay Item For Combined Curb and Gutter.