

PROJECT MARKER
 MARKER TO BE FURNISHED AND
 ERECTED BY THE STATE FORCES
 ON THE LEFT SIDE BEFORE
 ACCEPTANCE OF THIS PROJECT.

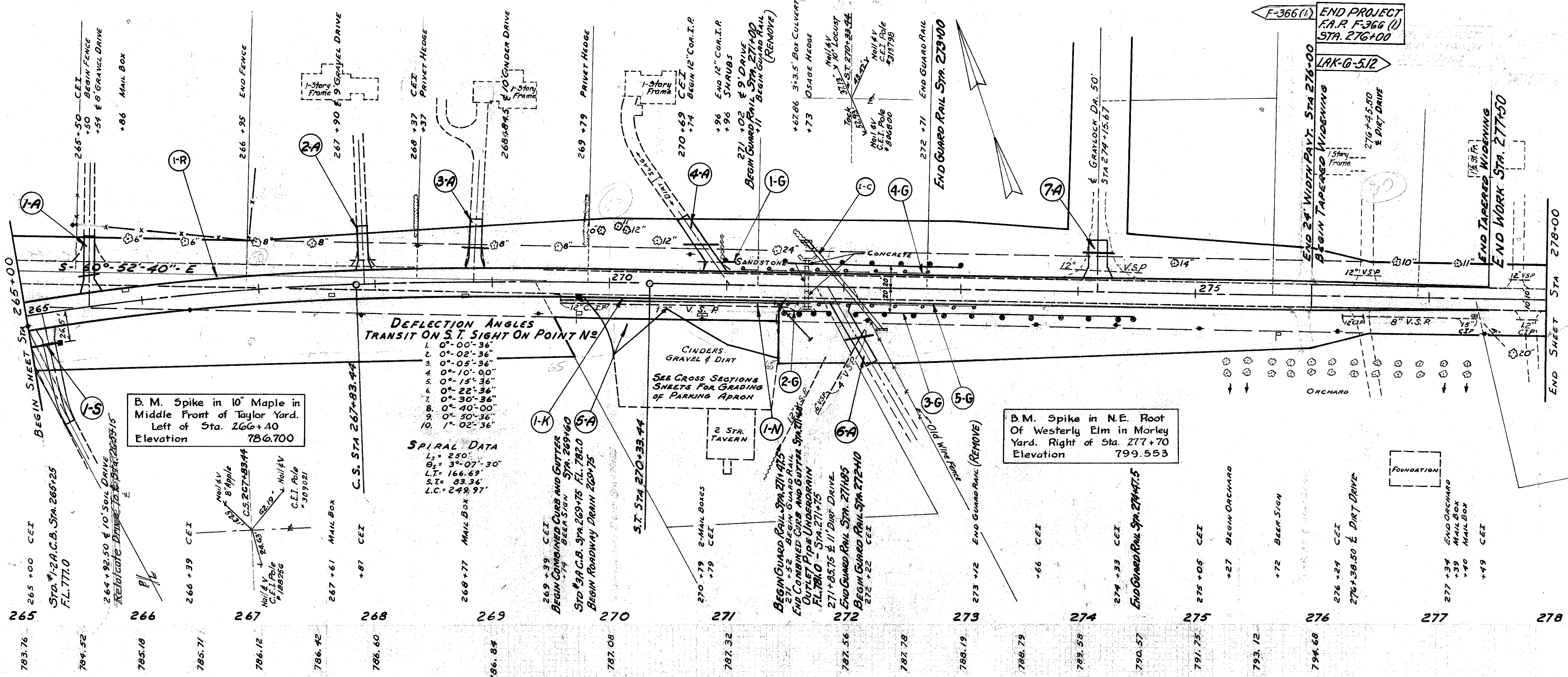

Ref. No.	STATION		SIDE	ITEM I-12	
	From	To		Sta	Type 2
I-K	Sta 269+40	Sta 271+60	RT.	200'	
TOTALS				200'	

CURB HEIGHTS FOR COMBINED CURB AND GUTTER
 TAPER 2" TO 6" STA 269+60 - STA 269+70
 6" STA 269+70 - STA 270+00
 2" STA 270+00 - STA 270+30
 6" STA 270+30 - STA 271+00
 2" STA 271+00 - STA 271+30
 6" STA 271+30 - STA 271+50
 TAPER 6" TO 2" STA 271+50 - STA 271+60

Ref. No.	Station	Side	ITEM I-2		Location of Structure
			12" Pipe Lin. Ft.	Item I-3 Std. C.B.*2A Each	
I-S	265+00	265+25	Rt.	24	265+25
TOTALS			24	1	

Ref. No.	Station	New Structure	See Detail Sheet No.
I-C	272+02	24" Pipe Culvert	78
Mail Box Turnouts (as per detail) 4			

Ref. No.	Station	E-8 Removal & Disposal Of Existing Pavement Sq. Yds.	
			From
I-R	265+00	276+00	2455
TOTAL			2455

Ref. No.	Station	Side	ITEM I-4		ITEM I-5		ITEM I-8	Location of Structure
			12" Pipe Lin. Ft.	12" Pipe Outlet Lin. Ft.	Pipe Special Each	12" 45° Elbow Each		
I-N	269+75	271+75	Rt.	180	30	1	1	269+75
TOTALS			180	30	1	1		

Ref. No.	Station	Side	ITEM I-1		ITEM E-1		ITEM I-17	ITEM E-12	Apron Type #or #2	
			12" Pipe for Driveways Lin. Ft.	Excavation Cu. Yds.	Excavation Deduction Cu. Yds.	Embankment Cu. Yds.				Embankment Deduction Cu. Yds.
I-A	265+54	Lt.	16	15.7	4.5		8.5		# 2	
I-A	267+90	Lt.		8.0	4.0		6.6	20	# 1	
I-A	268+84.5	Lt.	24	6.4	16.8		9.0		# 1	
I-A	271+02	Lt.	32	1.4	27.7	15.2	2.2	11.0	22	# 1
I-A	269+80	271+50	Rt.				32.0	205	# 2	
I-A	271+85.15	Rt.		32		71.8	13.7		# 1	
I-A	274+15.67	Lt.		26	11.3		6.2	67	# 2	
TOTALS			130	43.0	53.0	87.0	4.0	147.0	314	

Ref. No.	Station		Side	ITEM I-15	
	From	To		Removed Lin. Ft.	Rebuilt Lin. Ft.
I-G	271+00	273+00	Lt.		200
I-G	271+47.5	271+85	Rt.		37.5
I-G	272+10	274+47.5	Rt.		237.5
I-G	271+11	272+71		160	
I-G	271+52	273+12		160	
TOTALS				320.0	475.0

NOTE: EARTHWORK FOR DRIVE 5A INCLUDED IN EARTHWORK QUANTITIES AS SHOWN ON X-SECTIONS.

EXCAVATION 22372 CU. YDS.
 EMBANKMENT 23 CU. YDS.
 EMBANKMENT +1/5% 26 CU. YDS.

EXCAVATION 955 CU. YDS.
 EMBANKMENT 2386 CU. YDS.
 EMBANKMENT +1/5% 2757 CU. YDS.