

LAKE COUNTY  
 LAK.-6-(3.60-3.76)

GUARD RAIL				
ITEM No.	STATION		SIDE	I-15 LIN. FT.
	FROM	TO		
1-G	239+00.0	248+32.0	LEFT	932
2-G	239+00.0	248+51.0	RIGHT	951
TOTALS				1883

**PROPOSED STRUCTURE**  
 TYPE: CONTINUOUS STEEL GIRDER WITH CONC. DECK AND CONC. SUBSTRUCTURE  
 SPAN: 84'-105'-105'-84' 1/2% BEARINGS  
 RDWY: 28' PLUS 2'-0" SAFETY CURBS  
 LOADING: 3-20-46  
 SKEW: 30° R.F.  
 SURFACE COURSE: BITUMINOUS  
 APPROACH SLABS: AS SHOWN

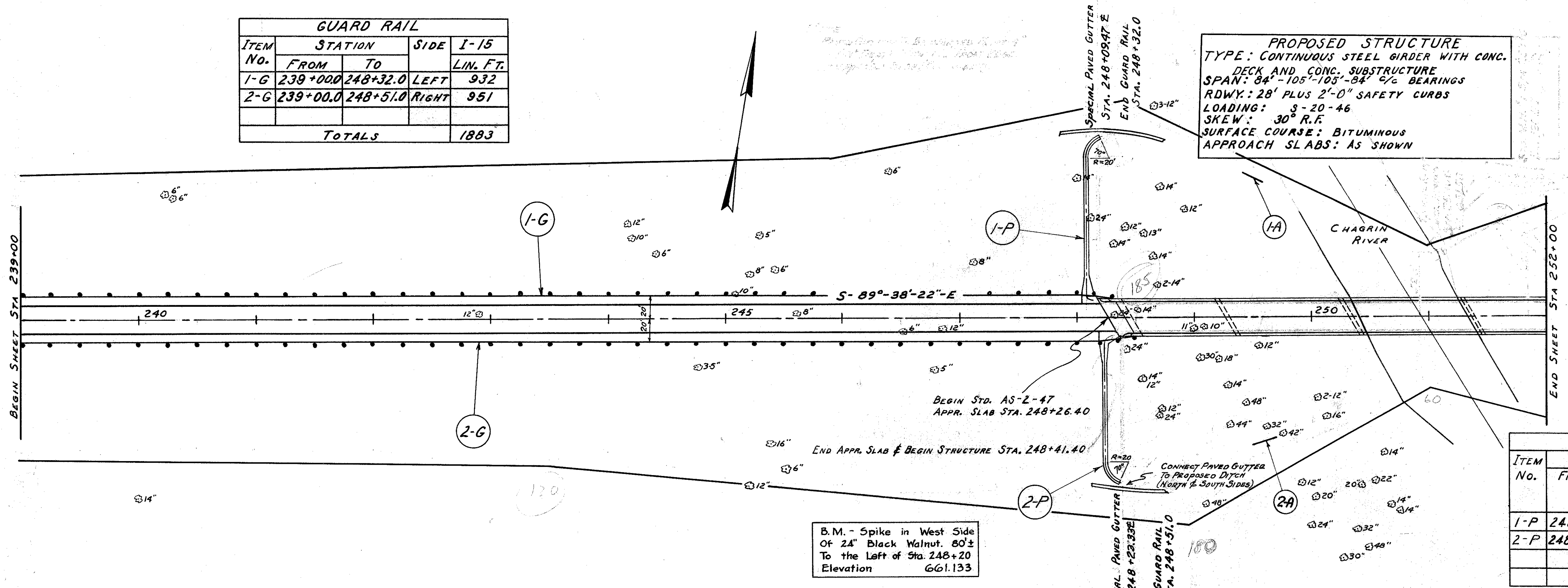

PAVED GUTTER				
ITEM No.	STATION		SIDE	I-14 SPECIAL PAVED GUTTER LINEAR FEET
	FROM	TO		
1-P	248+09.47	248+20±	LEFT	134
2-P	248+23.33	248+36±	RIGHT	122
TOTALS				256

SEE SHEET NO. 79 FOR DETAIL

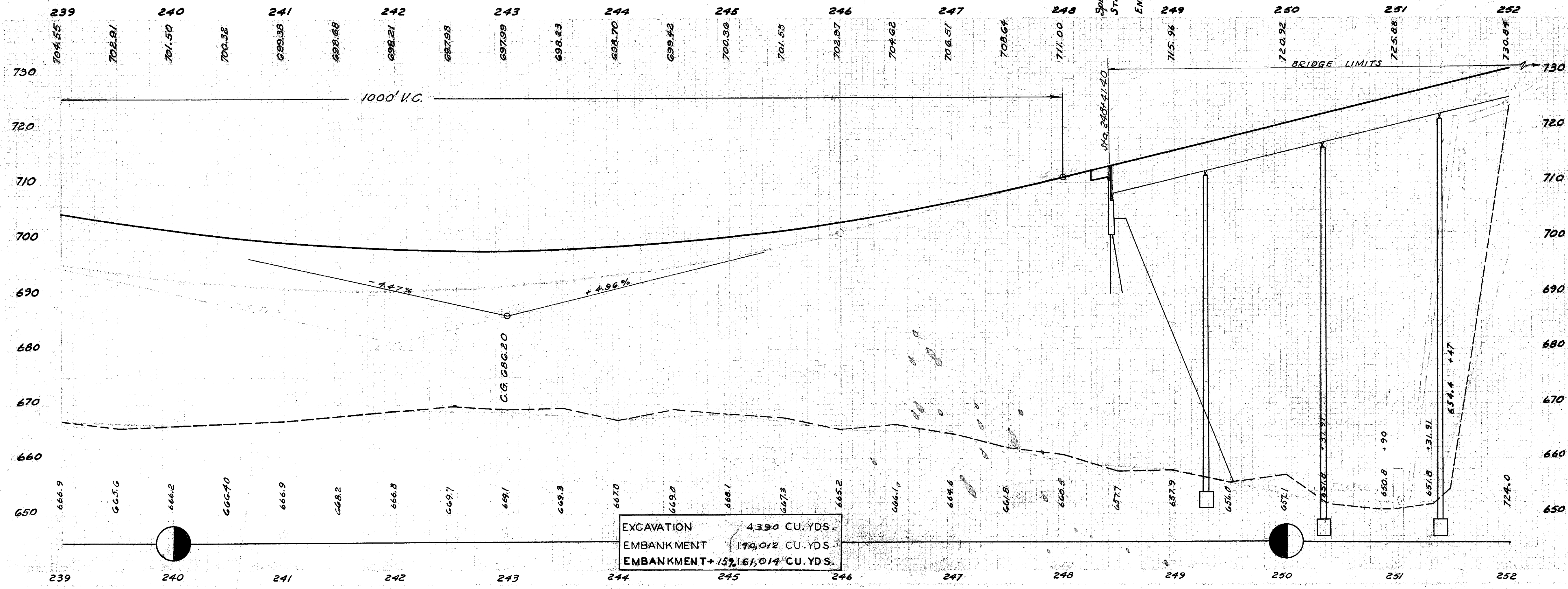

EXCAVATION 4,390 CU. YDS.  
 EMBANKMENT 170,012 CU. YDS.  
 EMBANKMENT+157,161,014 CU. YDS.

STORM SEWERS				
Station	Item No.	Size	Length	Location of Structure
239+00 to 248+32	1	18"	40	251+67
TOTALS				40

DRIVES					
Ref. No.	Station		Side	Item No.	Remarks
	From	To			
1-A	249+50±	249+50±	RT.	20	20
2-A	249+50±	249+50±	LT.	20	35
TOTALS				40	55

Driveway pipe provided to give property owner access to property south of bridge.

PLAN AND PROFILE STA. 239+00 TO STA. 252+00