

EXIST. RAIL CURVE DATA
 $D_c = 5^\circ 00'$
 $\Delta = 16^\circ 48'$
 $R = 1146.28'$
 $L = 336.11'$
 $T = 169.27'$

RAIL RELOCATION
 $D_c = 10^\circ 52' 37''$
 $\Delta = 27^\circ 34' 45''$
 $R = 527.56'$
 $L = 253.94'$
 $T = 129.47'$

NOTE: HORIZONTAL LAYOUT AND CONTROL DATA HAS BEEN ESTABLISHED FROM THE STATION MAP OF THE BALTIMORE AND OHIO RAILROAD COMPANY (AKRON DIVISION - FAIRPORT BRANCH) V.-114.4 / S25b

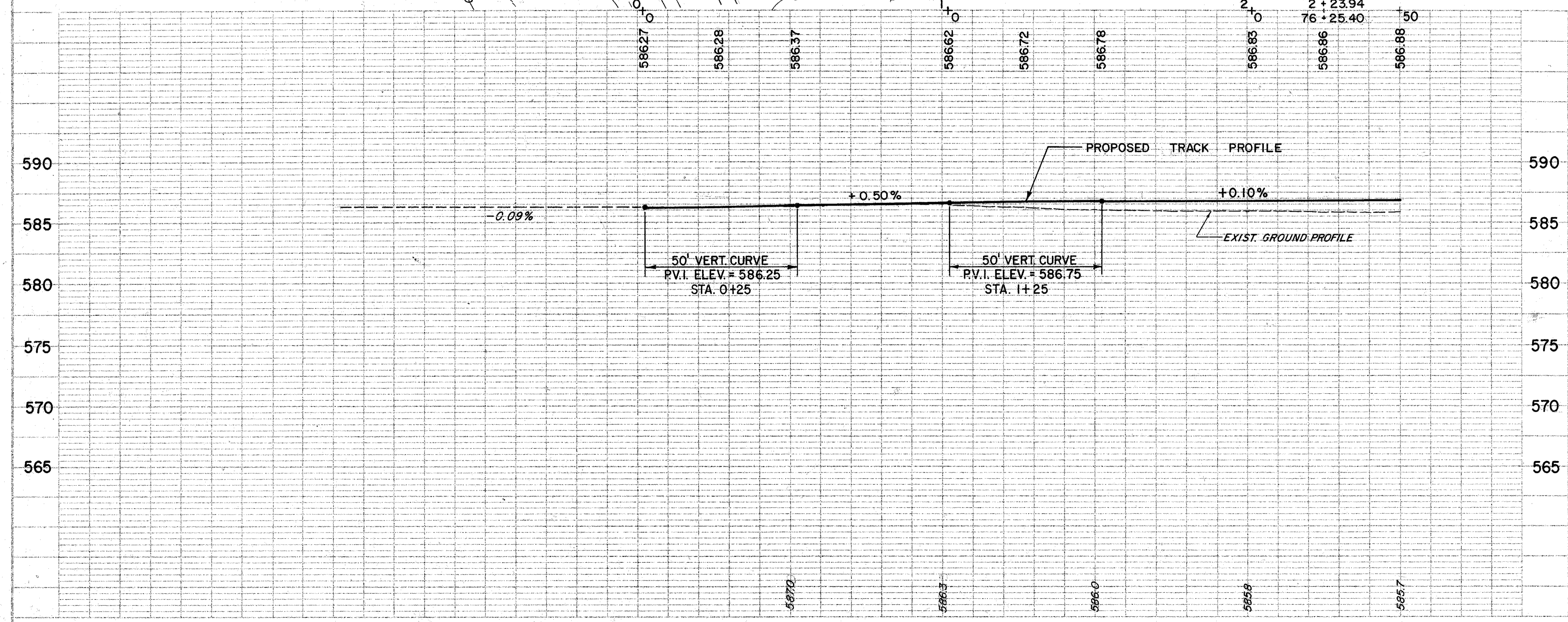
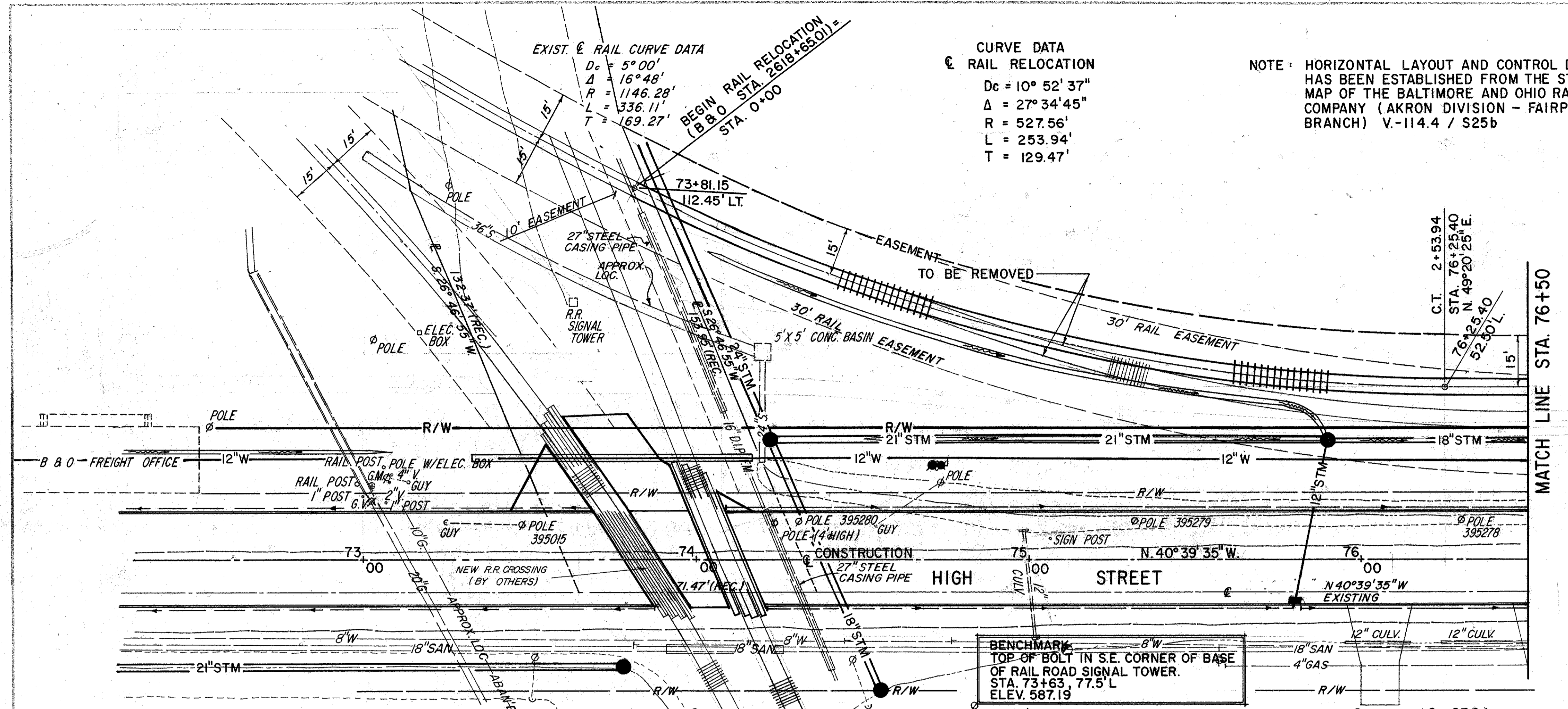
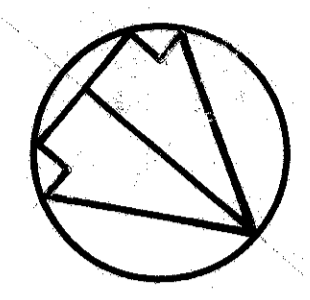

PLAN
 DRAWN BY: _____
 CHECKED BY: _____
 DATE: _____
 NOTE BOOK NO. _____
 SHEET NO. _____

PROFILE
 DRAWN BY: _____
 CHECKED BY: _____
 DATE: _____
 NOTE BOOK NO. _____
 SHEET NO. _____

HIGH STREET / WATER STREET