

☉ CURVE DATA  
 D = 7°30'00"  
 Δ = 14°00'00"  
 T = 93.80'  
 E = 5.74'  
 L = 186.66'  
 R = 763.94'  
 P.I. STA. 108+56.78

50' VERT. CURVE  
 P.V.I. ELEV. 582.34  
 STA. 105+50  
 ☉ CURVE DATA  
 D = 7°30'00"  
 Δ = 14°00'00"  
 T = 93.80'  
 E = 5.74'  
 L = 186.66'  
 R = 763.94'  
 P.I. STA. 106+08.12

☉ CURVE DATA  
 D = 7°30'00"  
 Δ = 18°50'00"  
 T = 126.70'  
 E = 10.44'  
 L = 251.11'  
 R = 763.94'  
 P.I. STA. 114+67.27

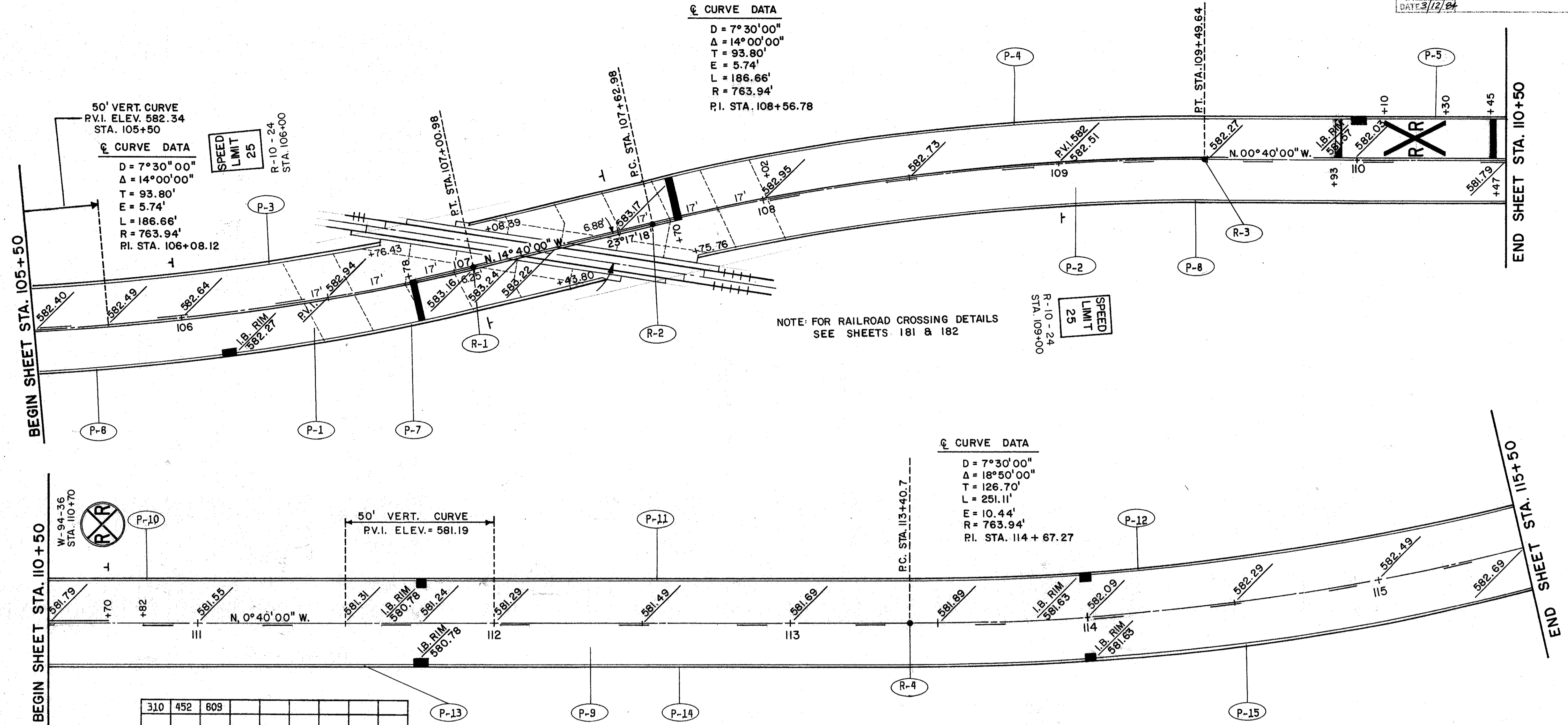

PAVEMENT

REF	LOCATION	6" SUBBASE TYPE 2	7" PLAIN PORTLAND CEMENT CONCRETE CURB STANDARD TYPE 2-A
P-1	105+50-107+10.12	86.0	515.9
P-2	107+42.08-110+50	165.4	992.8
P-3	105+50-106+76.43 L.		126.4
P-4	107+08.39-109+96.88 L.		292.0
P-5	110+03.1-110+50 L.		46.9
P-6	105+50-106+11.9 R.		61.9
P-7	106+18.1-107+43.8 R.		125.7
P-8	107+75.6-110+50 R.		270.7
P-9	110+50-115+50	268.5	1611.1
P-10	110+50-111+73.5 L.		123.5
P-11	111+76.5-113+98.5 L.		220.9
P-12	114+01.5-115+50 L.		146.6
P-13	110+50-111+71.9 R.		121.9
P-14	111+78.1-113+98.5 R.		221.5
P-15	114+01.5-115+50 R.		151.3
TOTALS		520	3120

ROADWAY

REF	LOCATION	EA.
R-1	107+00.98	1
R-2	107+62.98	1
R-3	109+49.64	1
R-4	113+04.70	1
TOTALS		4

TRAFFIC CONTROL

REF	LOCATIONS	MI.	MI.	MI.	EA.	9F.	LF.	EA.
C/L	105+50-106+80		0.02					
C/L	106+80-107+70	0.02						
C/L	107+70-110+70		0.06					
C/L	110+70-115+50			0.09				
LT.	107+70-110+45				1			
LT.	110+70 W-94-38					9	13	
RT/LT.	107+00, RT. & 107+50, LT.							2
RT/LT.	109+00 & 106+00 (R-10-24)					10	26	
TOTALS		0.02	0.08	0.09	1	19	39	